

Loxahatchee River District

Water Reclamation | Environmental Education | River Restoration

2500 Jupiter Park Drive, Jupiter, Florida 33458

Telephone (561) 747-5700 • Fax (561) 747-9929 • www.loxahatcheeriver.org



D. Albrey Arrington, Ph.D., Executive Director

AGENDA
REGULAR MEETING #3-2016
FEBRUARY 18, 2016 – 7:00 PM AT DISTRICT OFFICES
ALL MEETINGS ARE OPEN TO THE PUBLIC

1. Call to Order & Pledge of Allegiance
2. Administrative Matters
 - A. Roll Call
 - B. Previous Meeting Minutes **Page 4**
 - C. Additions and Deletions to the Agenda
3. Comments from the Public
4. Status Updates
 - A. Loxahatchee River Watershed **Page 12**
 - B. Loxahatchee River District Dashboard **Page 13**
5. Consent Agenda (see next page) **Page 14**
6. Regular Agenda
 - A. Consent Agenda Items Pulled for Discussion
 - B. Draft Audit Fiscal Years 2015 and 2014 **Page 57**
 - C. Health Insurance Options **Page 58**
 - D. Chapter 31-10, Rates, Fees and Charges **Page 78**
 - E. Procurement Policy **Page 84**
7. Reports (see next page) Pulled for Discussion
8. Future Business **Page 124**
9. Board Comments
10. Adjournment

“...if a person decides to appeal any decision made by the Board, with respect to any matter considered at such meeting or hearing, he will need a record of the proceedings, and that, for such purpose, he may need to ensure that a verbatim record of the proceedings is made, which record includes the testimony and evidence upon which the appeal is to be based.”

Submitted by:
Date: February 8, 2016

Stephen B. Rockoff
Board Member

Dr. Matt H. Rostock
Board Member

Gordon M. Boggie
Chairman

Harvey M. Silverman
Board Member

James D. Snyder
Board Member

5. CONSENT AGENDA

All items listed in this portion of the agenda are considered routine and will be enacted by one motion. There will be no separate discussion of these items unless requested by a Board member or citizen; in which event, the item will be removed and considered under the regular agenda.

- A. Final Assessment – Rolling Green Rd. (Resolution 2016-10) **Page 15**
- B. Notice of Intent to Assess – Turtle Creek Ph I (Resolution 2016-11) **Page 24**
- C. Notice of Intent to Assess – Turtle Creek Subsystem 3 (Resolution 2016-12) **Page 33**
- D. Palm Beach County Interlocal Agreement (Open Cuts of County Roads) **Page 43**
- E. Rolling Green Rd. Low Pressure Pump Units – to purchase pumps **Page 44**
- F. Filter Pump Station – to purchase replacement pump **Page 47**
- G. Chlorine (Allied Universal) contract – to renew contract **Page 52**
- H. Liability Insurance (Preferred)– to renew policies **Page 53**
- I. Change Orders to Current Contracts – to approve modifications **Page 54**

7. REPORTS

- A. Neighborhood Sewering **Page 85**
- B. Legal Counsel’s Report **Page 88**
- C. Engineer’s Report **Page 92**
- D. Busch Wildlife Sanctuary **Page 97**
- E. Friends of the Loxahatchee River **Page 98**
- F. Director’s Report **Page 104**

Loxahatchee River District

Water Reclamation | Environmental Education | River Restoration

2500 Jupiter Park Drive, Jupiter, Florida 33458

Telephone (561) 747-5700 • Fax (561) 747-9929 • www.loxahatcheeriver.org



D. Albrey Arrington, Ph.D., Executive Director

AGENDA
PUBLIC HEARING #2-2016
FEBRUARY 18, 2016 - 6:55 P.M. AT DISTRICT OFFICES
ALL MEETINGS ARE OPEN TO THE PUBLIC

1. Call to Order and Pledge of Allegiance
2. Roll Call
3. To receive public comments pertaining to the Rolling Green Rd. Final Assessment
4. Comments from the Board
5. Adjournment

".... if a person decides to appeal any decision made by the Board, with respect to any matter considered at such meeting or hearing, he will need a record of the proceedings, and that, for such purpose, he may need to ensure that a verbatim record of the proceedings is made, which record includes the testimony and evidence upon which the appeal is to be based."

A handwritten signature in blue ink, appearing to be 'D. Albrey Arrington'.

Submitted by:
Date: February 8, 2016

data:\admin\board\agendaPH

Stephen B. Rockoff
Board Member

Dr. Matt H. Rostock
Board Member

Gordon M. Boggie
Chairman

Harvey M. Silverman
Board Member

James D. Snyder
Board Member

Loxahatchee River District

Water Reclamation | Environmental Education | River Restoration

2500 Jupiter Park Drive, Jupiter, Florida 33458

Telephone (561) 747-5700 • Fax (561) 747-9929 • www.loxahatcheeriver.org



D. Albrey Arrington, Ph.D., Executive Director

MEMORANDUM

TO: Governing Board

FROM: Recording Secretary

DATE: February 9, 2016

RE: Approval of Meeting Minutes

Attached herewith are the minutes of the Regular Meeting of January 21, 2016. As such, the following motion is presented for your consideration.

“THAT THE GOVERNING BOARD approve the minutes of the January 21, 2016 Regular Meeting as submitted.”

J:\BOARD\MinutesSamples\MinutesMemo.docx

Stephen B. Rockoff
Board Member

Dr. Matt H. Rostock
Board Member

Gordon M. Boggie
Chairman

Harvey M. Silverman
Board Member

James D. Snyder
Board Member

Ref: #1-2016

LOXAHATCHEE RIVER ENVIRONMENTAL CONTROL DISTRICT
REGULAR MEETING - MINUTES
JANUARY 21, 2016

1. CALL TO ORDER

Chairman Rockoff called the Regular Meeting of January 21, 2016 to order at 7:00 pm.

2. ADMINISTRATIVE MATTERS

A. ROLL CALL

The following Board Members were in attendance.

Dr. Rostock
Mr. Boggie
Mr. Silverman
Mr. Snyder
Mr. Rockoff

Staff Members in attendance were Dr. Arrington, Mr. Vaughn, Mr. Dean, Ms. Peterson, and Mr. Howard.

Consultants in attendance were Mr. Muniz and Mr. Koroshek from Hazen and Sawyer, Ms. Miranda from Holtz, Ms. Marshall from Mathews, and Mr. Shenkman with DeSantis, Gaskill.

Mr. Hitzig with Busch Wildlife Sanctuary was also in attendance.

B. PREVIOUS MEETING MINUTES

The minutes of the Public Hearing and Regular Meeting of December 17, 2015 were presented for approval and the following motion was made.

MOTION: Made by Mr. Silverman, Seconded by Mr. Boggie,
Passed Unanimously.

"THAT THE GOVERNING BOARD approve the minutes of the December 17, 2015 Public Hearing and Regular Meeting as submitted."

C. ADDITIONS & DELETIONS TO THE AGENDA

Items 5K and 6C did not require Board action and were removed from the agenda.
Item 5N was pulled for discussion.

D. ELECTION OF OFFICERS

Chairman Rockoff reviewed the Election of Officers memo. Dr. Rostock suggested the Chairman position be held for a two year period to insure continuity in running the Board Meetings and nominated Mr. Rockoff for a second term.

MOTION: Made by Dr. Rostock, Seconded by Mr. Snyder,
Failed 2-3 with Mr. Silverman, Mr. Boggie and Mr. Snyder opposing.

"THAT THE GOVERNING BOARD retain Mr. Rockoff as Chairman."

MOTION: Made by Dr. Rostock, Seconded by Mr. Snyder,
Passed Unanimously.

"THAT THE GOVERNING BOARD elect: Mr. Boggie to serve as Chairman, Mr. Silverman to serve as Vice Chairman, Mr. Snyder to serve as Treasurer, Dr. Rostock to serve as Secretary, and Mr. Rockoff to serve as Assistant Secretary/Treasurer of the Governing Board of the Loxahatchee River Environmental Control District."

Mr. Rockoff passed the gavel to Mr. Boggie and Mr. Boggie conducted the remainder of the meeting.

3. COMMENTS FROM THE PUBLIC

No comments were received.

4. STATUS UPDATES

A. LOXAHATCHEE WATERSHED STATUS

Mr. Howard discussed some of the historic and potential effects of El Niño on the Loxahatchee River Watershed.

B. LOXAHATCHEE RIVER DISTRICT DASHBOARD

Dr. Arrington reviewed the District Dashboard.

5. CONSENT AGENDA

MOTION: Made by Mr. Snyder, Seconded by Mr. Rockoff,
Passed unanimously.

"THAT THE GOVERNING BOARD approve the Consent Agenda of January 21, 2016 as amended."

The following motions were approved as a result of the Board's adoption of the Consent Agenda:

A. Authorization to Sign Reports (Resolution 2016-01)

“THAT THE GOVERNING BOARD approve Resolution 2016-01 authorizing specific signatures for execution of all reports required under the Florida Statutes.”

B. Notice of Intent to Assess – 3831 Beacon Hill Rd (Resolution 2016-02)

“THAT THE GOVERNING BOARD approve Resolution 2016-02, the NOTICE OF INTENT to Assess, the Pending Lien Notice, and the Exhibits for the 3831 Beacon Hill Rd. Assessment Area.”

C. Notice of Intent to Assess – SE Harken Terr Ph I (Resolution 2016-03)

“THAT THE GOVERNING BOARD approve Resolution 2016-03, the NOTICE OF INTENT to Assess, the Pending Lien Notice, and the Exhibits for the SE Harken Terr_Ph I Assessment Area.”

D. Notice of Intent to Assess – SE Harken Terr Services (Resolution 2016-04)

“THAT THE GOVERNING BOARD approve Resolution 2016-04, the NOTICE OF INTENT to Assess, the Pending Lien Notice, and the Exhibits for the SE Harken Terr Services Assessment Area.”

E. Notice of Intent to Assess – 10828 Whispering Pine Trl (Resolution 2016-05)

“THAT THE GOVERNING BOARD approve Resolution 2016-05, the NOTICE OF INTENT to Assess, the Pending Lien Notice, and the Exhibits for the 10828 Whispering Pine Trl Assessment Area.”

F. Notice of Intent to Assess – Hyland Terr Properties Services (Resolution 2016-06)

“THAT THE GOVERNING BOARD approve Resolution 2016-06, the NOTICE OF INTENT to Assess, the Pending Lien Notice, and the Exhibits for the Hyland Terr Properties Services Assessment Area.”

G. Notice of Intent to Assess – SE Linden St (Resolution 2016-07)

“THAT THE GOVERNING BOARD approve Resolution 2016-07, the NOTICE OF INTENT to Assess, the Pending Lien Notice, and the Exhibits for the SE Linden St Assessment Area.”

H. Notice of Intent to Assess – SE Pine Grove St (Resolution 2016-08)

“THAT THE GOVERNING BOARD approve Resolution 2016-08, the NOTICE OF INTENT to Assess, the Pending Lien Notice, and the Exhibits for the SE Pine Grove St Assessment Area.”

I. Preliminary Assessment – Rolling Green Rd (Resolution 2016-09)

“THAT THE GOVERNING BOARD approve Resolution 2016-09 adopting the Rolling Green Rd. Preliminary Assessment Roll and Exhibits.”

J. Employee Retirement Plan Trustee Designation – to designate Trustee

“THAT THE GOVERNING BOARD elects Harvey Silverman to serve as Trustee for the Loxahatchee River Environmental Control District Money Purchase Plan and Trust.”

L. Lift Station Rehabilitations 2016 – to award contract

“THAT THE DISTRICT GOVERNING BOARD authorize award of contract for the Lift Station Rehabilitation for 2016 contract to Felix Associates of Florida, Inc., in the amount of \$157,758.00,

and

THAT THE DISTRICT GOVERNING BOARD authorize a contingency amount of \$3,000.00.”

M. Online Banking and Credit Card Processing Fees (FY 2016) – to authorize purchase order

“THAT THE DISTRICT GOVERNING BOARD authorize Purchase Order #48125 in the amount of \$65,000 for Fiscal Year 2016 for credit card and online payment fees from SunTrust.”

O. Change Orders to Current Contracts – to approve modifications

“THAT THE DISTRICT GOVERNING BOARD authorize execution of Change Order #1 to the Lift Station Rehabilitations for 2015 contract with B&B Underground Construction, Inc., in an amount not to exceed \$7,158.18.”

6. REGULAR AGENDA

A. Consent Agenda Items Pulled for Discussion.

5N. Online Banking & Credit Card Processing Fees (FY 2015) – to reauthorize purchase order

Dr. Arrington discussed the increase in online/credit card payments that caused the increase in banking fees from SunTrust.

MOTION: Made by Mr. Silverman, Seconded by Mr. Rockoff,
Passed unanimously.

“THAT THE DISTRICT GOVERNING BOARD authorize the increase in Purchase Order #47692 to SunTrust for credit card and online payment fees to an amount not to exceed \$53,531.23.”

B. Governing Board Appointments and Liaisons

Dr. Arrington reviewed the board appointments and liaisons.

MOTION: Made by Mr. Rockoff, Seconded by Mr. Snyder,
Passed unanimously.

“THAT THE GOVERNING BOARD adopt the chart of Governing Board appointments and liaisons for the 2016 calendar year.”

D. Construction Standards and Technical Specifications

Mr. Dean reviewed his memo summarizing the updates to the Construction Standards.

MOTION: Made by Mr. Rockoff, Seconded by Mr. Snyder,
Passed unanimously.

“THAT THE DISTRICT GOVERNING BOARD ratify and approve the Loxahatchee River Environmental Control District’s “Manual of Minimum Construction Standards and Technical Specifications”, as of January 4, 2016, and authorize the District Engineer and Executive Director to update the Construction Standards and Technical Specifications from time to time, and periodically present it to the Governing Board for ratification and approval.”

E. CMMS Award of Contract

Mr. Howard reviewed his memo outlining the Computerized Maintenance Management System (CMMS) contract with Aderas, Inc.

MOTION: Made by Mr. Snyder, Seconded by Mr. Rockoff,
Passed unanimously.

“THAT THE DISTRICT GOVERNING BOARD authorizes the Executive Director to approve the professional services contract and purchase order to Aderas, Inc. in the amount not to exceed \$128,576.00, in accordance with the attached contract.”

F. Admin. Building Window Replacement Contract Award

Dr. Arrington reviewed Mr. Yerkes' memo on replacing the administration building windows.

MOTION: Made by Mr. Rockoff, Seconded by Mr. Snyder,
Passed unanimously.

“THAT THE DISTRICT GOVERNING BOARD authorize execution of a contract with Tri County Building Contractor, Inc. for the Administration Building Window Replacements Contract in the amount of \$41,105.00.

and

A contingency amount of \$1,000.00.”

7. REPORTS

The following reports stood as written:

A. NEIGHBORHOOD SEWERING

B. LEGAL COUNSEL'S REPORT

C. ENGINEER'S REPORTS

E. FRIENDS OF THE LOXAHATCHEE RIVER

F. DIRECTOR'S REPORT

8. FUTURE BUSINESS

Chairman Boggie requested that Health Insurance be added to the Future Business report.

7D. BUSCH WILDLIFE SANCTUARY

Mr. Hitzig presented the Busch dashboard and gave an update on activities at the sanctuary.

9. COMMENTS FROM THE BOARD

No comments were received.

10. ADJOURNMENT

MOTION: Made by Mr. Rockoff, Seconded by Mr. Silverman,
Passed Unanimously.

"That the Regular Meeting of January 21, 2016 adjourn at 8:35."

BOARD CHAIRMAN

BOARD SECRETARY

RECORDING SECRETARY



Loxahatchee River Watershed Status Martin County's Kitching Creek Central Flow Way Restoration Project

Martin County recently completed an ambitious restoration project in one of the major tributaries into the Loxahatchee River. This project will provide important and valuable benefits for water quality and quantity for the River, habitat improvements, as well as public use amenities. At our meeting we will provide a brief summary of this extraordinary restoration project.



LOXAHATCHEE RIVER DISTRICT'S EXECUTIVE DASHBOARD



Benchmark / Customer Expectation	Stewardship		Wastewater					Engineering	General Business					EHS	River Health		
	# People educated at RC	Mean Daily Incoming Flow	Delivery of Reclaimed Water	Customer Service	Sewer Overflow	Permit exceedance	NANO Blend to Reuse (@ 511)	Grease Interceptor Inspections	Cash Available	Revenue (non-assessment)	Operating Expenses	Capital Projects		Employee Safety	Lainhart Dam Daily Flow	Salinity @ NB seagrass beds	River Water Quality
	# people	million gallons/day	# days demand not met	# blockages with damage in home	# occurrences	# occurrences	Max Specific Conductance (umhos/cm)	% requiring pump out	\$	% of Budget	% of Budget	% within budget	% on time	# of OSHA recordable injuries	Flow (cfs)	%	Fecal Coliform Bacteria (cfu/100ml)
Green Level	≥ 1,500	< 7.7	Zero	Zero	Zero	Zero	<1542	≤ 10	≥ \$9,894,657	≥ 95%	≥ 85% but ≤ 105%	≥ 80%	≥ 80%	Zero	mean ≥ 69	min ≥ 20 ‰	90% of sites ≤ 200
Yellow	≤ 1,500	< 8.8	≥ 2	1	≤ 2	1	≤1875	≤ 15	< \$9,894,657	≥ 90%	≥ 80%	≥ 60%	≥ 60%	-	mean ≥ 35	min ≥ 10 ‰	2 or more sites >200 but ≤ 400
Red	≤ 1,250	≥ 8.8	≥ 9	≥ 2	> 2	≥ 2	>1875	> 15	< \$5,557,057	< 90%	< 80% or > 105%	< 60%	< 60%	≥ 1	min < 35	min < 10 ‰	≥ 2 sites > 400
2012 Baseline	1,691	6.7	0	0	1	1	1,162		\$ 21,205,340	101%	86%	95%	87%	0	108	22	1 > 200
2013 Baseline	2,118	6.8	1	0	1	0	1,029		\$ 25,550,033	105%	91%	88%	52%	0	132	20.0	1 > 200
2014 Baseline	2,120	6.8	0	0	1	0	978	11	\$ 27,415,251	102%	104%	95%	86%	0	140	21.9	1 > 200
2015 Baseline	2,139	6.8	0	0	1	0	1,093	14	30,199,659	104%	111%	92%	78%	0	78	24.8	0 > 200
2015 Jan	2,913	7.1	0	0	1	0	1156	22	\$ 27,434,172	107%	147%	100%	100%	1	32	29.5	0 > 200
2015 Feb	2,880	7.3	0	0	3	0	1150	11	\$ 28,441,095	105%	135%	100%	83%	0	34	28.9	0 > 200
2015 Mar	2,188	7.4	0	0	2	0	1084	10	\$ 27,700,987	105%	128%	100%	83%	1	120	13.8	0 > 200
2015 Apr	1,994	7.1	0	0	1	0	1047	15	\$ 29,021,808	107%	123%	100%	75%	0	18	31.3	0 > 200
2015 May	1,679	6.5	0	0	1	0	1088	20	\$ 30,492,614	107%	120%	84%	75%	0	9	31.3	0 > 200
2015 June	3,241	6.2	0	0	0	0	1135	15	\$ 29,691,353	106%	116%	84%	75%	0	28	29.8	0 > 200
2015 July	3,276	6.2	0	1	0	0	1208	14	\$ 30,937,341	107%	113%	75%	75%	0	53	29.9	0 > 200
2015 Aug	1,849	6.4	0	0	0	0	1128	6	\$ 30,471,102	109%	111%	75%	67%	0	78	23.8	Incomplete
2015 Sept	1,359	6.8	1	0	1	0	1097	5	\$ 31,672,070	108%	110%	84%	50%	1	223	9.5	0 > 200
2015 Oct	1,604	6.4	0	0	1	0	978	18	\$ 31,318,759	96%	70%	100%	89%	0	83	25.3	0 > 200
2015 Nov	1,276	6.5	0	0	4	0	1026	15	\$ 32,678,126	94%	78%	100%	82%	0	58	30.1	0 > 200
2015 Dec	1,405	7.2	0	0	0	0	1023	20	\$ 32,536,481	94%	82%	100%	82%	0	196	13.9	2 > 200
2016 Jan	1,689	7.6	0	0	1	0	962	14	\$ 33,243,678	94%	82%	100%	82%	0	160	11.0	0 > 200
Consecutive Months at Green	1	80	31	6	0	30	64	0	80	46	0	5	4	4	2	0	1
Metric Owner	O'Neill	Vaughn	Vaughn	Vaughn	Vaughn	Vaughn	Vaughn	Dean	Peterson	Peterson	Peterson	Yerkes	Yerkes	Vaughn	Howard	Howard	Howard

Metric
 Sewer Overflow: A contractor hit and broke a 10 inch ductile iron gravity main while cleaning a drainage ditch between Brentwood Rd and Weldwood Rd (just west of Jupiter High School). The system has been completely repaired and returned to service.
 Grease Interceptors: 14% of inspected grease interceptors required a pump out due to grease accumulation. Grease interceptors provide critical pretreatment at commercial food service establishments, because they prevent grease from damaging our sewer system.
 Operating Expense: Our operating expenses continue to be less than projected if you assume we spend the same amount each month.
 River Salinity: The abnormally high 7.85 inches of rainfall in December led to relatively higher flows in the river and lower salinity in the downstream reaches.

Loxahatchee River District

Water Reclamation | Environmental Education | River Restoration

2500 Jupiter Park Drive, Jupiter, Florida 33458

Telephone (561) 747-5700 • Fax (561) 747-9929 • www.loxahatcheeriver.org



D. Albrey Arrington, Ph.D., Executive Director

MEMORANDUM

TO: Governing Board
FROM: D. Albrey Arrington, Executive Director
DATE: February 9, 2016
SUBJECT: Consent Agenda

All items listed below are considered routine and will be enacted by one motion. There will be no separate discussion of these items unless requested by a Board member or citizen, in which event, the item will be removed and considered under the regular agenda.

This month's consent agenda consists of the following items:

- A. Final Assessment – Rolling Green Rd. (Resolution 2016-10)
- B. Notice of Intent to Assess – Turtle Creek Ph I (Resolution 2016-11)
- C. Notice of Intent to Assess – Turtle Creek Subsystem 3 (Resolution 2016-12)
- D. Palm Beach County Interlocal Agreement (Open Cuts of County Roads)
- E. Rolling Green Rd. Low Pressure Pump Units – to purchase pumps
- F. Filter Pump Station – to purchase replacement pump
- G. Chlorine (Allied Universal) contract – to renew contract
- H. Liability Insurance (Preferred)– to renew policies
- I. Change Orders to Current Contracts – to approve modifications

Should you have any questions in regard to these items, I would be pleased to discuss them further with you.

The following motion is provided for Board consideration:

"THAT THE GOVERNING BOARD approve the Consent Agenda of February 18, 2016 as presented."

Signed,

D. Albrey Arrington
Executive Director

L:/Board/Consent

Stephen B. Rockoff
Board Member

Dr. Matt H. Rostock
Board Member

Gordon M. Boggie
Chairman

Harvey M. Silverman
Board Member

James D. Snyder
Board Member

CONRAD J. DeSANTIS
Business & Real Estate
Also Admitted in Pennsylvania

TIMOTHY W. GASKILL
Business, Probate
Family Litigation

DONALD R. SMITH
Personal Injury & Wrongful Death
Commercial Litigation

CURTIS L. SHENKMAN
Board Certified
Real Estate Attorney

BROOKE A. GROGAN



DESANTIS, GASKILL, SMITH & SHENKMAN, P.A.
ATTORNEYS & COUNSELORS AT LAW

ESTABLISHED 1973
11891 U.S. HIGHWAY ONE, SUITE100
NORTH PALM BEACH, FLORIDA 33408
TELEPHONE (561) 622-2700 FACSIMILE (561) 622-2841
Shenkman@LawPalmBeach.com

LEGAL ASSISTANTS
CIVIL TRIAL, PROBATE
AND FAMILY LAW
KAREN M. BOYDEN-LOPATOSKY
MINDY VASSER
PERSONAL INJURY
ROBIN B. MODLIN, CP
TERRI L. VLASSICK
REAL ESTATE
JUDY D. MONTEIRO
DENISE B. PAOLUCCI

January 27, 2016

D. Albrey Arrington, Ph.D., Executive Director
Clint Yerkes, Deputy Executive Director
Loxahatchee River Environmental Control District
2500 Jupiter Drive
Jupiter, Florida 33458-8964

Re: **Resolution 2016-10 and FINAL Assessment Roll for ROLLING GREEN ROAD**

Dear Albrey & Clint:

Attached to this letter is Transfer of Property Lien, Resolution 2016-10, Exhibit "A" Final Assessment Roll, Exhibit A Map, and the most recent Exhibit "B" list of property owners, as part of the Resolution.

A **SUGGESTED MOTION** for the Board at the FEBRUARY 18, 2016 meeting is as follows:

"THAT THE GOVERNING BOARD approve Resolution 2016-10 adopting the **ROLLING GREEN ROAD FINAL Assessment Roll and Exhibits.**"

Sincerely,

Curtis L. Shenkman

Curtis L. Shenkman

RESOLUTION NO. 2016-10

A RESOLUTION OF THE LOXAHATCHEE RIVER ENVIRONMENTAL CONTROL DISTRICT RELATING TO THE **ROLLING GREEN RD.** ASSESSMENT AREA IMPROVEMENTS; ADOPTING THE ASSESSMENT ROLL FOR **ROLLING GREEN RD.** ASSESSMENT AREA IMPROVEMENTS; CONFIRMING SAID SPECIAL ASSESSMENT ROLL AS ATTACHED HERETO AS EXHIBITS “A” AND “B”; PROVIDING FOR ELLIS RULE COMPLIANCE; PROVIDING FOR DECLARING LINE AVAILABLE FOR CONNECTION; PROVIDING THE SPECIAL ASSESSMENTS SHALL BE COLLECTED AS NON-AD VALOREM SPECIAL ASSESSMENTS ON THE REAL ESTATE TAX BILL; AUTHORIZING THE DISTRICT CLERK TO PREPARE AND DELIVER THE NON-AD VALOREM SPECIAL ASSESSMENT ROLL TO THE PALM BEACH COUNTY AND MARTIN COUNTY PROPERTY APPRAISERS, TAX COLLECTORS, AND FLORIDA DEPARTMENT OF REVENUE; PROVIDING FOR CONSISTENCY; PROVIDING AN EFFECTIVE DATE.

WHEREAS, the Governing Board of the Loxahatchee River Environmental Control District (hereinafter called the “District”) has authorized the sewer improvements constructed in the **ROLLING GREEN RD.** Assessment Area; and

WHEREAS, The District’s previous Resolutions **2015-13 & 2016-09** were approved by the District’s Governing Board and directed the preparation of the Assessment Roll.

WHEREAS, the Governing Board, on the 18th day of FEBRUARY, 2016 at 6:55 P.M., sat as Board of Adjustment as provided in District Rule 31-11.005, and held the Public Hearings under Florida Statutes Chapter 197.

NOW THEREFORE, BE IT RESOLVED BY THE GOVERNING BOARD OF THE DISTRICT THAT:

Section 1. The Governing Board confirms the Special Assessment Roll attached hereto as Exhibits “A” and “B” without further modification. The unit of measurement for each assessment area is that each parcel is **assessed equally as served by a simplex and assessed equally as served by a duplex.**

Section 2. The Special Assessment is in compliance with the “Ellis Rule” requirement of District Rule 31-10.011, and Resolution Nos. **2015-13 & 2016-09** of the District.

Section 3. In accordance with District Rule Chapter 31-11, and Florida Statutes Chapter 197, said Special Assessment Liens shall remain liens co-equal with the lien of all State, County, District and Municipal taxes, superior in dignity to all other liens, titles, and claims, until paid. Any failure to so pay these non-ad valorem Special Assessments shall be a default hereunder and will cause a tax certificate to be issued against the property which may result in a loss of title.

RESOLUTION **2016-10**
Loxahatchee River Environmental Control District

Section 4. Availability for Connection and Required Connection.

The waste water and sewerage system was “Available” for connection in accordance with District Rule 31-3.003(3) and Florida Statutes 381.0065(2)(a) when the Florida Department of Health released the system for service on November 24, 2015, which is the date of actual “Availability”. In accordance with Florida Statutes 381.00655, the affected property owners shall be required to connect to the sewerage system within one (1) year of the actual Availability.

Section 5. The **District Clerk, as the designee of the chairman** of the Governing Board, **is directed to certify the non-ad valorem assessment roll, on a compatible electronic medium tied to the property identification number** and deliver it to the tax collector by September 15 of each year, or as otherwise provided for in the agreements with the tax collector. The certification shall be made on **Form DR-408A**.

Section 6. All Resolutions or parts of Resolutions in conflict herewith are hereby repealed to the extent of such conflict.

Section 7. This Resolution shall become effective upon its passage and adoption.

PASSED AND ADOPTED BY THE GOVERNING BOARD OF THE LOXAHATCHEE RIVER ENVIRONMENTAL CONTROL DISTRICT, THIS 18th day of FEBUARY, 2016.

LOXAHATCHEE RIVER ENVIRONMENTAL CONTROL DISTRICT:
VOTE

GORDON M. BOGGIE, Chairman

STEPHEN B. ROCKOFF

HARVEY M. SILVERMAN

JAMES D. SNYDER

DR. MATT H. ROSTOCK

Projects/Special/Assessmt/FinalResolution

EXHIBIT "A"
FINAL ASSESSMENT ROLL
LOXAHATCHEE RIVER ENVIRONMENTAL CONTROL DISTRICT
ROLLING GREEN RD. SIMPLEX ASSESSMENT AREA

TOTAL COSTS AND EXPENSES RELATED TO THE IMPROVEMENTS. The District shall consider the **total** costs and expenses related to the improvements in the **ROLLING GREEN RD. SIMPLEX** Assessment Area shall be **\$8,983.76** per parcel of property in the **ROLLING GREEN RD. SIMPLEX** Area.

APPORTIONMENT OF COSTS BETWEEN THE DISTRICT AND THE PROPERTY OWNERS. The District shall pay from the District's general funds ten percent (10%) of the total cost to the District of construction, reconstruction, labor, materials, acquisition, or property rights, surveys, design, engineering, and legal fees, administration expenses, and all other expenses necessary or incidental to completion of the specially assessed improvement and each lot or parcel of land subject to this special assessment shall be responsible for ninety percent (90%) of the total cost.

ASSESSMENT BASED ON PARCEL OF PROPERTY. Each Parcel of Property in the **ROLLING GREEN RD. SIMPLEX** Assessment Area identified on EXHIBIT "B" shall be currently assessed in the amount of **\$8,408.88**.

PAYMENT OF ASSESSMENT. As to Parcels of **ROLLING GREEN RD. SIMPLEX** Assessment Area Property in EXHIBIT "B", the **\$8,408.88** assessment may be paid, interest free, at the office of the District on or before May 1, 2017.

Owners who do not pay the \$8,408.88 assessment on or before May 1, 2017 shall have the \$8,408.88 principal added to the tax roll as a non-ad valorem assessment to accrue interest, beginning October 1, 2016, at six and seven eights percent (6.875%) per annum, to be collected in twenty (20) equal annual installments of \$786.04, commencing with the November 1, 2017 Real Estate Tax Bill.

LOXAHATCHEE RIVER ENVIRONMENTAL CONTROL DISTRICT

By: _____
D. Albrey Arrington, District Clerk, Executive Director

EXHIBIT "A"
FINAL ASSESSMENT ROLL
LOXAHATCHEE RIVER ENVIRONMENTAL CONTROL DISTRICT
ROLLING GREEN RD. DUPLEX ASSESSMENT AREA

TOTAL COSTS AND EXPENSES RELATED TO THE IMPROVEMENTS. The District shall consider the **total** costs and expenses related to the improvements in the **ROLLING GREEN RD. DUPLEX** Assessment Area shall be **\$13,749.76** per parcel of property in the **ROLLING GREEN RD. DUPLEX** Area.

APPORTIONMENT OF COSTS BETWEEN THE DISTRICT AND THE PROPERTY OWNERS. The District shall pay from the District's general funds ten percent (10%) of the total cost to the District of construction, reconstruction, labor, materials, acquisition, or property rights, surveys, design, engineering, and legal fees, administration expenses, and all other expenses necessary or incidental to completion of the specially assessed improvement and each lot or parcel of land subject to this special assessment shall be responsible for ninety percent (90%) of the total cost.

ASSESSMENT BASED ON PARCEL OF PROPERTY. Each Parcel of Property in the **ROLLING GREEN RD. DUPLEX** Assessment Area identified on EXHIBIT "B" shall be currently assessed in the amount of **\$13,174.88**.

PAYMENT OF ASSESSMENT. As to Parcels of **ROLLING GREEN RD. DUPLEX** Assessment Area Property in EXHIBIT "B", the **\$13,174.88** assessment may be paid, interest free, at the office of the District on or before May 1, 2017.

Owners who do not pay the \$13,174.88 assessment on or before May 1, 2017 shall have the \$13,174.88 principal added to the tax roll as a non-ad valorem assessment to accrue interest, beginning October 1, 2016, at six and seven eights percent (6.875%) per annum, to be collected in twenty (20) equal annual installments of \$1,231.56, commencing with the November 1, 2017 Real Estate Tax Bill.

LOXAHATCHEE RIVER ENVIRONMENTAL CONTROL DISTRICT

By: _____
D. Albrey Arrington, District Clerk, Executive Director

PREPARED BY AND RETURN TO: WC-53
Curtis L. Shenkman, Esquire
DeSantis, Gaskill, Smith & Shenkman, P.A.
11891 U.S. Highway One, Suite 100
North Palm Beach, Florida 33408

**TRANSFER OF PROPERTY LIEN TO NON-AD
VALOREM TAX BILL & CERTIFICATION OF SPECIAL
ASSESSMENT ROLL FOR ROLLING GREEN RD. SPECIAL ASSESSMENTS**

THE LOXAHATCHEE RIVER ENVIRONMENTAL CONTROL DISTRICT, a special district of the State of Florida created and existing pursuant to Chapter 2002-358, Laws of Florida (the "District"), gives public notice that the District's Governing Board as of and effective on the 18th day of FEBRUARY, 2016, passed Resolution 2016-10 which is attached hereto, approving the non-ad valorem tax bill, AND TRANSFERRING THE RECORDED LIEN ON PROPERTIES IDENTIFIED AS BEING PART OF THE **ROLLING GREEN RD.** AREA LISTED IN THE FOLLOWING DOCUMENTS, as recorded in the Public Records of **PALM BEACH** County, Florida:

1. Pending Lien Notice of Intent to Assess, and Resolutions 2015-13, recorded on **APRIL 21, 2015 in Official Record Book 27480, Pages 1788 through 1795, in the Public Records of PALM BEACH County, Florida.**

Any inquiries as to payment of special assessments should be directed to:

LOXAHATCHEE RIVER ENVIRONMENTAL CONTROL DISTRICT
2500 Jupiter Park Drive
Jupiter, Florida 33458
(561) 747-5700

IN WITNESS WHEREOF, the undersigned, Executive Director of the Loxahatchee River Environmental Control District, hereby certifies on February 18, 2016, the information contained herein is true and accurate.

WITNESSES:

LOXAHATCHEE RIVER ENVIRONMENTAL
CONTROL DISTRICT

By: _____
D. Albrey Arrington, Ph.D.
Executive Director

STATE OF FLORIDA
COUNTY OF PALM BEACH

The foregoing instrument was acknowledged before me on February 18, 2016, by D. Albrey Arrington, Ph.D., EXECUTIVE DIRECTOR of the LOXAHATCHEE RIVER ENVIRONMENTAL CONTROL DISTRICT, a special district of the State of Florida, on behalf of the District, who is personally known to me.

(Notary Seal)

NOTARY PUBLIC, STATE OF FLORIDA

SIMPLEX

Ms. Constance Wilson
re: 13297 Rolling Green Rd
13297 Rolling Green Rd
N Palm Beach FL 33408
00-43-41-29-00-000-5400

Mr. & Mrs. Jeffrey Kuehl
re: 13333 Rolling Green Rd
13333 Rolling Green Rd
N Palm Beach FL 33408
00-43-41-29-00-000-5020

Mr. & Mrs. Sven Kraeher
re: 13309 Rolling Green Rd
13309 Rolling Green Rd
N Palm Beach FL 33408
00-43-41-29-00-000-5420

Mr. & Mrs. Joseph Sicbaldi
re: 13240 Rolling Green Rd
13240 Rolling Green Rd
N Palm Beach FL 33408
00-43-41-29-00-000-5480

Mr. & Mrs. Barry Lichtig
re: 13210 Rolling Green Rd
13210 Rolling Green Rd
N Palm Beach FL 33408
00-43-41-29-00-000-5481

Mr. Michael Halay
re: 2038 Rolling Green Rd
2038 Rolling Green Rd
N Palm Beach FL 33408
00-43-41-29-00-000-5482

Ms. Karyl Clark
re: 2019 Rolling Green Rd
2019 Rolling Green Rd
N Palm Beach FL 33408
00-43-41-29-00-000-5490

Ms. Marjorie Hecht
re: 13166 Rolling Green Rd
2109 S Suzanne Cir
N Palm Beach FL 33408
00-43-41-29-00-000-5500

Mr. & Mrs. W S Estabrook Jr
re: 13215 Ellison Wilson Rd
13215 Ellison Wilson Rd
N Palm Beach FL 33408
00-43-41-29-00-000-5510

BD Prop Vent LTD
re: 13261 Rolling Green Rd
745 Harbour Isle Pl
Palm Bch Grdns FL 33410
00-43-41-29-00-000-5520

Ms. Donna Shaw
re: 13249 Rolling Green Rd
13249 Rolling Green Rd
N Palm Beach FL 33408
00-43-41-29-00-000-5530

Mr. & Mrs. Steven Bakke
re: 13243 Ellison Wilson Rd
13243 Ellison Wilson Rd
N Palm Beach FL 33408
00-43-41-29-00-000-5542

Mr. & Mrs. Brian Wilson
re: 13165 Ellison Wilson Rd
13165 Ellison Wilson Rd
N Palm Beach FL 33408
00-43-41-29-00-000-5544

Mr. Karl Taylor
re: 13215 Rolling Green Rd
13215 Rolling Green Rd
N Palm Beach FL 33408
00-43-41-29-00-000-5550

Mr. Dennis Onan Tr
re: 13221 Ellison Wilson Rd
13221 Ellison Wilson Rd
N Palm Beach FL 33408
00-43-41-29-00-000-5620

Mr. & Mrs. Richard Panse
re: 2061 Rolling Green Rd
2061 Rolling Green Rd
N Palm Beach FL 33408
00-43-41-29-00-000-5630

Mr. & Mrs. Melvin Lee
re: 13196 Rolling Green Rd
840 Historian St
Raleigh NC 27603
00-43-41-29-00-000-5670

Mr. & Mrs. Scott Sharp
re: 13209 Rolling Green Rd
13209 Rolling Green Rd
N Palm Beach FL 33408
00-43-41-29-00-000-5700

Mr. & Mrs. Donald Stevenson
re: 13345 Rolling Green Rd
13345 Rolling Green Rd
N Palm Beach FL 33408
00-43-41-29-00-000-5730

Mr. & Mrs. John Kelly III
re: 2041 Rolling Green Rd
729 Turner Ave
Drexel Hill PA 19026
00-43-41-29-00-000-5800

DUPLEX

W Rickards/D Stone
re: 13321 Rolling Green Rd
850 E Ocean Blvd, 209
Long Beach CA 90802
00-43-41-29-00-000-5010

Dickinson RE Inv LLC c/o Kivlan
re: 13285 Rolling Green Rd
306 Alicante Dr
N Palm Beach FL 33408
00-43-41-29-00-000-5380

Mr. & Mrs. David Weisberg
re: 13273 Rolling Green Rd
13273 Rolling Green Rd
N Palm Beach FL 33408
00-43-41-29-00-000-5390

Ms. Jina Moussa
re: 13195 Rolling Green Rd
13195 Rolling Green Rd
N Palm Beach FL 33408
00-43-41-29-00-000-5540

Ms. Amy Anspach Tr
re: 13159 Rolling Green Rd
13159 Rolling Green Rd
N Palm Beach FL 33408
00-43-41-29-00-000-5560

EXHIBIT "B"

ROLLING GREEN ROAD LOW PRESSURE SEWER ASSESSMENT AREA

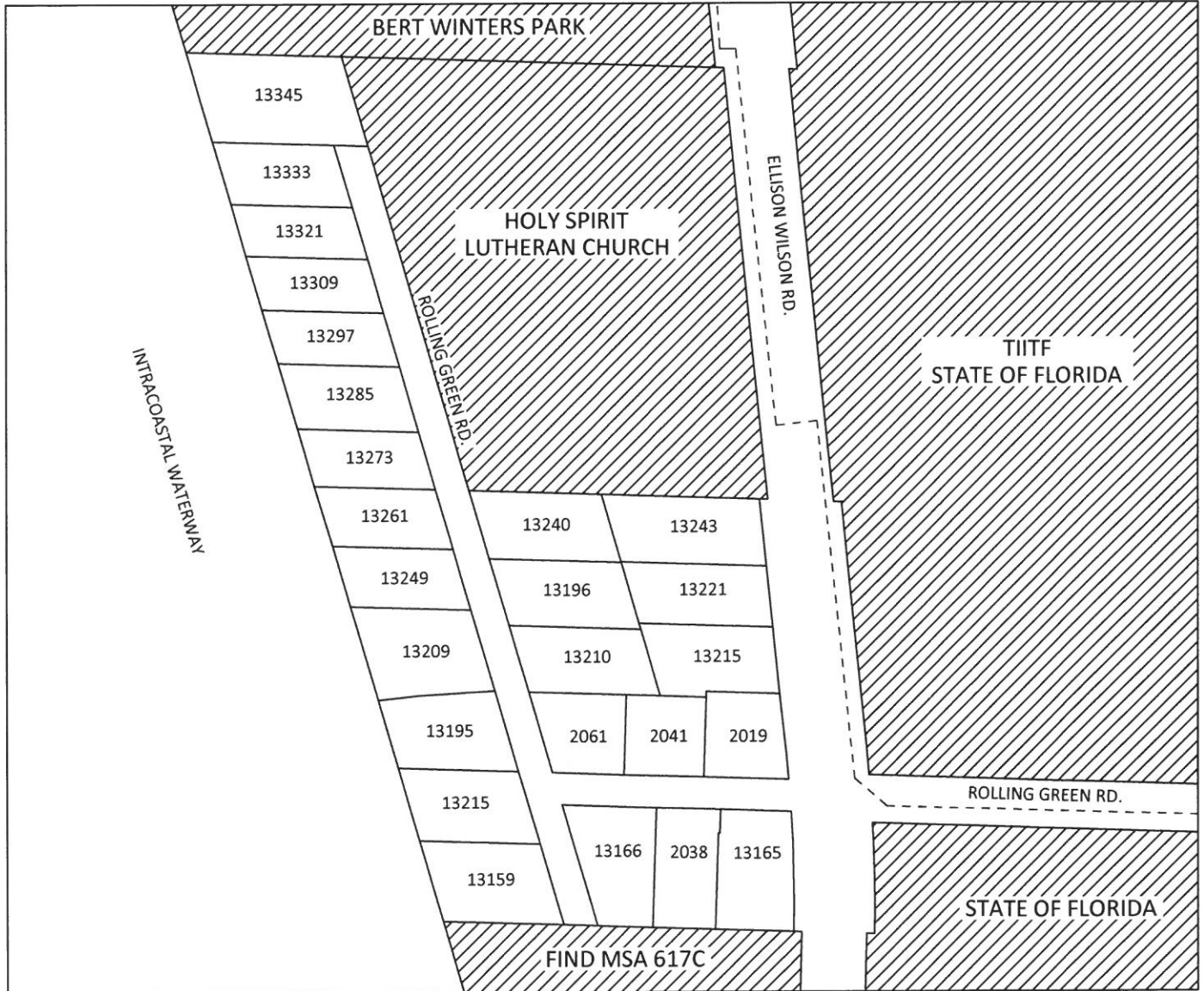

LEGEND

EXISTING FORCE MAIN



NOT IN ASSESSMENT AREA

JUNO BEACH, FLORIDA

CONRAD J. DeSANTIS
Business & Real Estate
Also Admitted in Pennsylvania

TIMOTHY W. GASKILL
Business, Probate
Family Litigation

DONALD R. SMITH
Personal Injury & Wrongful Death
Commercial Litigation

CURTIS L. SHENKMAN
Board Certified
Real Estate Attorney

BROOKE GROGAN
Attorney



DeSANTIS, GASKILL, SMITH & SHENKMAN, P.A.

ATTORNEYS & COUNSELORS AT LAW

ESTABLISHED 1973

11891 U.S. HIGHWAY ONE, SUITE100
NORTH PALM BEACH, FLORIDA 33408

TELEPHONE (561) 622-2700 FACSIMILE (561) 622-2841

www.LawPalmBeach.com

LEGAL ASSISTANTS
CIVIL TRIAL, PROBATE
AND FAMILY LAW
KAREN M. BOYDEN-LOPATOSKY
MINDY VASSER

PERSONAL INJURY
ROBIN B. MODLIN, CP
TERRI L. VLASSICK

REAL ESTATE
JUDY D. MONTEIRO
DENISE B. PAOLUCCI

February 11, 2016

Sent by email

D. Albery Arrington, PhD., Executive Director
Clint Yerkes, Deputy Executive Director
Loxahatchee River Environmental Control District
2500 Jupiter Drive
Jupiter, Florida 33458-8964

Re: Initial Resolution for **TURTLE CREEK PHASE I** Assessment Area

Dear Dr. Arrington and Mr. Yerkes:

Per your request, please attach to this letter the Pending Lien Notice, Notice of Intent to Assess, Resolution 2016-11, the PROPOSED "Exhibit B Description of Improvements", "Exhibit B Map of the Assessment Area", and preliminary List of Property Owners.

A **SUGGESTED MOTION** for the Board to consider is:

"THAT THE GOVERNING BOARD approve Resolution 2016-11 the NOTICE OF INTENT to Assess, the Pending Lien Notice, and the Exhibits for the **TURTLE CREEK PHASE I** Assessment Area."

I will bring the originals to be signed at the Governing Board meeting. Thereafter the District will record in the Public Records.

Sincerely,

Curtis L. Shenkman

Curtis L. Shenkman

RETURN TO: WC-53
Curtis L. Shenkman, Esquire
DeSantis, Gaskill, Smith & Shenkman, P.A.
11891 U.S. Highway One
North Palm Beach, Florida 33408

PENDING LIEN NOTICE
TURTLE CREEK PH I ASSESSMENT AREA

THE LOXAHATCHEE RIVER ENVIRONMENTAL CONTROL DISTRICT, a special district of the State of Florida, created in 1971 and existing pursuant to Chapter 2002-358, Laws of Florida (hereinafter referred to as the “District”, hereby clarifies the lien status of the “Notice of Intent to Assess” attached hereto and made a part hereof (referred to as the “Pending Lien”).

The Pending Lien shall not be considered certified, confirmed or ratified until such time as the passage of the Final Assessment Roll Resolution of the District.

The intention of the District in publishing this Pending Lien Notice is to assist the property owners who may be selling or refinancing their property and parties who may be placing a mortgage on their property to do so knowing that the District is not seeking the payment of any funds on the Pending Lien until the non-ad valorem tax bill is issued for the property on the date set forth in the Final Assessment Roll Resolution of the District.

Any inquiries as to the Pending Lien and the timing for the Final Assessment Roll Resolution and payment of said special assessments should be directed to:

LOXAHATCHEE RIVER ENVIRONMENTAL CONTROL DISTRICT
2500 Jupiter Park Drive
Jupiter, Florida 33458
Phone: (561) 747-5700

IN WITNESS WHEREOF, the undersigned, Executive Director of the Loxahatchee River Environmental Control District, herein certifies that on this 18th day of FEBRUARY, 2016, the information contained herein is true and accurate.

WITNESSES:

LOXAHATCHEE RIVER ENVIRONMENTAL
CONTROL DISTRICT

By: _____
D. Albrey Arrington, Ph.D.
EXECUTIVE DIRECTOR

STATE OF FLORIDA
COUNTY OF PALM BEACH

The foregoing instrument was acknowledged before me this 18th day of February, 2016, by D. Albrey Arrington, EXECUTIVE DIRECTOR of the LOXAHATCHEE RIVER ENVIRONMENTAL CONTROL DISTRICT, a special district of the State of Florida, on behalf of the District, personally known to me.

(NOTARY SEAL)

NOTARY PUBLIC, STATE OF FLORIDA

Special/Assessment/PendingLienNotice

RETURN TO: WC-53
Curtis L. Shenkman, Esquire
DeSantis, Gaskill, Smith & Shenkman, P.A.
11891 U.S. Highway One
North Palm Beach, Florida 33408

**NOTICE OF INTENT TO ASSESS
TURTLE CREEK PH I ASSESSMENT AREA**

THE LOXAHATCHEE RIVER ENVIRONMENTAL CONTROL DISTRICT, a special district of the State of Florida (the “District”) **created in 1971 and existing pursuant to Chapter 2002-358, Laws of Florida**, (the “Act”), hereby gives public notice that the District’s Governing Board on the 18th day of February, 2016, passed Resolution **2016-11**, authorizing the construction of certain local sewer improvements as further described in said Resolution **2016-11**, which is attached hereto as Exhibit “A”. It is the intent of the District to assess the owners of property specially benefited by such sewer improvements, which property is further described on the attached **Exhibit “B”**, and to apportion the District’s costs for the total expenses related to the design and construction of said improvements, based upon each owner’s proportionate share of said costs determined upon a square footage basis, or by other methods as the Governing Board may deem fair and equitable, pursuant to the Act and Rules of the District, as same may be amended from time to time hereafter.

Any inquiries to the District’s progress in completing certification of said assessments should be directed to:

LOXAHATCHEE RIVER ENVIRONMENTAL CONTROL DISTRICT
2500 Jupiter Park Drive
Jupiter, Florida 33458

IN WITNESS WHEREOF, the undersigned, Executive Director of the Loxahatchee River Environmental Control District, hereby certifies on this 18th day of FEBRUARY, 2016, that the information contained herein is true and accurate.

WITNESSES:

D. Albrey Arrington
Executive Director

STATE OF FLORIDA
COUNTY OF PALM BEACH

SWORN TO and subscribed before me this 18th day of February, 2016, by D. Albrey Arrington, EXECUTIVE DIRECTOR of the LOXAHATCHEE RIVER ENVIRONMENTAL CONTROL DISTRICT, who is personally known to me.

(NOTARY SEAL)

NOTARY PUBLIC, STATE OF FLORIDA

Special/Assessment/NoticeIntentToAssess

RESOLUTION 2016-11

A RESOLUTION OF THE LOXAHATCHEE RIVER ENVIRONMENTAL CONTROL DISTRICT RELATING TO **TURTLE CREEK PH I** ASSESSMENT AREA IMPROVEMENTS IN ACCORDANCE WITH DISTRICT RULE 31-11; STATING THE NATURE OF THE PROPOSED IMPROVEMENTS; DESIGNATING THE STREETS TO BE IMPROVED; DESIGNATING THAT PLANS, SPECIFICATIONS, AND A TENTATIVE APPORTIONMENT BE PREPARED; PROVIDING FOR THE AVAILABILITY OF PLANS AND SPECIFICATIONS AND FOR THE PREPARATION OF THE PRELIMINARY SPECIAL ASSESSMENT ROLL; PROVIDING FOR DECLARING LINE AVAILABLE FOR CONNECTION; PROVIDING FOR CONSISTENCY; PROVIDING FOR SEVERABILITY; PROVIDING AN EFFECTIVE DATE.

WHEREAS, the Governing Board of the Loxahatchee River Environmental Control District (hereinafter called the “District”) has considered the need for improvements to the **TURTLE CREEK PH I** Assessment Area (the “Area”) in Martin County, Florida;

WHEREAS the District shall construct and declare available sewerage collection lines and related appurtenances comprising a localized District sewer system in the Area as an Established Residential Neighborhood based upon the Governing Board’s determination of any of the following:

- (1) n/a; or
- (2) that a reasonable alternative to the septic tanks exists for the treatment of the sewerage, taking into consideration factors such as cost; or
- (3) the discharge from the septic tanks is adversely affecting the health of the user or the public, or the groundwater or surface water is degraded; or
- (4) to enhance the environmental and scenic value of surface waters.

WHEREAS, the Governing Board has considered the facts, evidence, and presentations of the District Engineer, District staff and consultants as to the need for sanitary sewers in the Area and considered such recommendations to be in accordance with the above referenced Criteria of the “Ellis Rule” as well as in the best interests of the citizens of the District and the citizens of this Area.

NOW, THEREFORE, BE IT RESOLVED BY THE GOVERNING BOARD OF THE DISTRICT, THAT:

Section 1. Title:

This Resolution shall be known as the Resolution Authorizing the Project known as “**TURTLE CREEK PH I** Assessment Area Improvements”.

Section 2. Nature of Improvements:

The project improvements shall consist of the construction of a waste water and sewage system within lands under the jurisdiction of the District. The proposed improvements performed shall generally consist of those set forth on Composite Exhibit “B”.

Section 3. Designation of Streets to be Improved:

The streets included within the **TURTLE CREEK PH I** Assessment Area Improvements are set forth on Composite Exhibit “B”.

Section 4. Plans, Specifications and Tentative Apportionment:

Upon adoption of this Resolution, The District Engineers and staff shall prepare plans, specifications and estimated total costs of such proposed improvements, together with a tentative apportionment of such costs between the District and individual parcels of property receiving special benefits pursuant to the improvements.

Section 5. Public Inspection:

The Plans, Specifications and tentative apportionments for the **TURTLE CREEK PH I** Assessment Area Improvements shall be available for inspection in the Office of the Executive Director,

Loxahatchee River Environmental Control District, 2500 Jupiter Park Drive, Jupiter, Florida 33458. The District's Engineer shall make available said plans and specifications prepared incident thereto, for inspection in the Office of the District's Engineer.

Section 6. Assessment Roll:

The District Clerk is directed to prepare a Preliminary Assessment Roll based upon this Resolution, District Rule 31-11, and the District Engineer's tentative apportionment, and to make publication of notice in newspapers in Martin and Palm Beach Counties, together with notice mailed to those interested parties and affected property owners requesting such in writing, in accordance with the requirements of District Rule 31-11.

Section 7. Availability for Connection and Required Connection:

The waste water and sewerage system shall be "Available" for connection in accordance with District Rule 31-3.003(3) and Florida Statutes 381.0065(2)(a) when the Florida Department of Health releases the system for service, which is the date of actual "Availability". In accordance with Florida Statutes 381.00655, the affected property owners shall be required to connect to the sewerage system within one (1) year of the actual Availability.

Section 8. All Resolutions or parts of Resolutions in conflict herewith are hereby repealed to the extent of such conflict.

Section 9. In the event that any portion of this Resolution is found to be unconstitutional or improper, it shall be severed herefrom and shall not affect the validity of the remaining portions of this Resolution.

Section 10. This Resolution shall become effective upon its passage and adoption.

PASSED AND ADOPTED BY THE GOVERNING BOARD OF THE LOXAHATCHEE RIVER ENVIRONMENTAL CONTROL DISTRICT, THIS 18th DAY OF FEBRUARY, 2016.

LOXAHATCHEE RIVER ENVIRONMENTAL CONTROL DISTRICT
VOTE

GORDON M. BOGGIE, Chairman

STEPHEN ROCKOFF

HARVEY M. SILVERMAN

JAMES D. SNYDER

DR. MATT H. ROSTOCK

EXHIBIT "B"

TURTLE CREEK - PHASE I

SEWER SYSTEM ASSESSMENT AREA

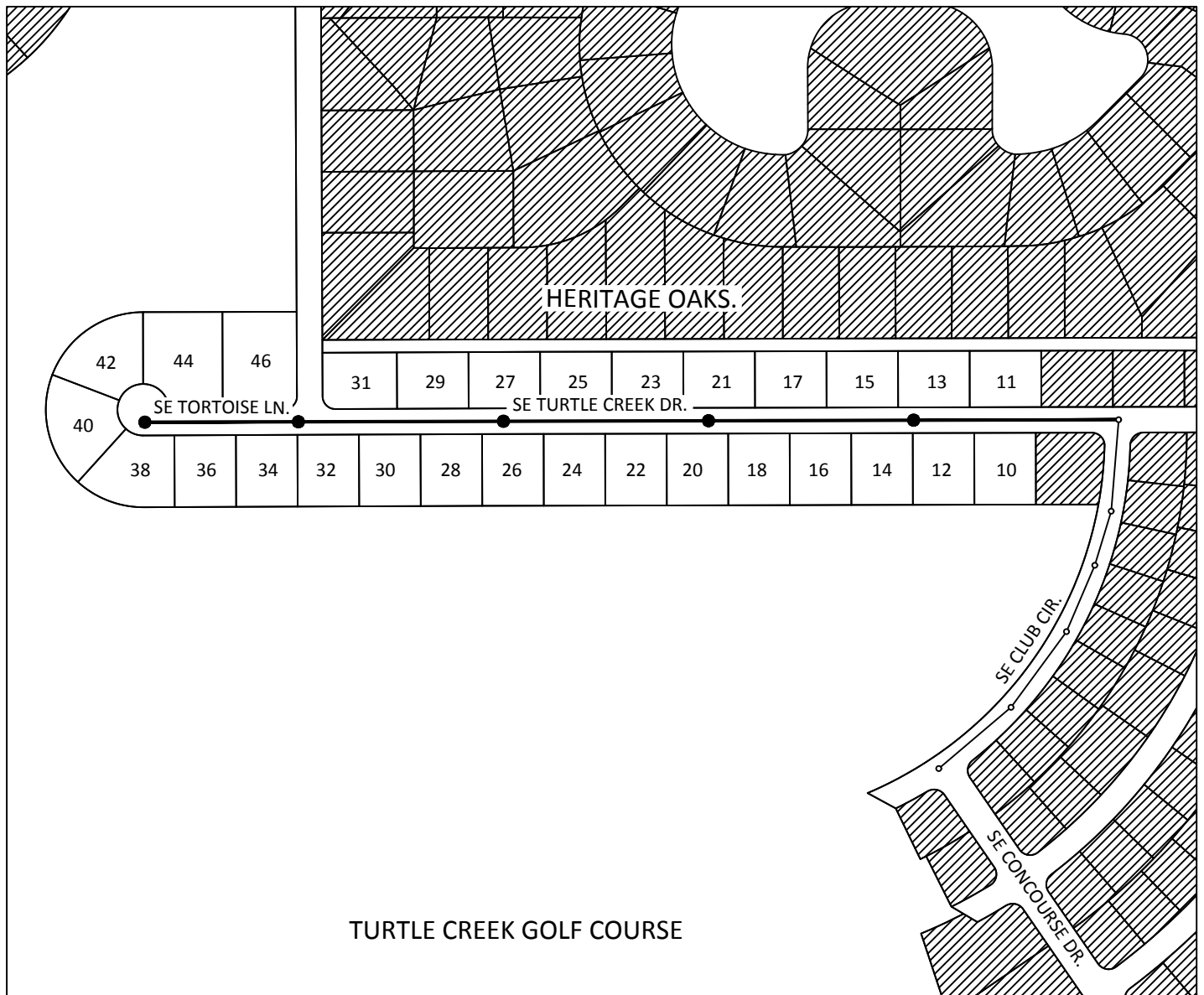

LEGEND

- NOT IN ASSESSMENT AREA
- EXISTING GRAVITY
- EXISTING MANHOLE
- PROPOSED GRAVITY
- PROPOSED MANHOLE

MARTIN COUNTY, FLORIDA

EXHIBIT “B”

PROPOSED SEWER SERVICE ASSESSMENT AREA

TURTLE CREEK PHASE I ASSESSMENT AREA

The properties to be provided sewer service are located within Section 22, Township 40 South, Range 42 East, Unincorporated Martin County, Florida and lies within the following general boundaries:

- On the North by Heritage Oaks Subdivision;
- On the South by Turtle Creek Golf Course;
- On the East by N. Fork of the Loxahatchee River; and
- On the West by Turtle Creek Golf Course.

The approximate quantity of materials required to complete the project are:

- 1,945 Lineal feet of 8” Gravity Main
- 6 Manholes
- 29 Services

Mr. & Mrs. Joseph Rabina
re: 46 SE Tortoise Ln
46 SE Tortoise Ln
Tequesta FL 33469
22-40-42-015-006-00010-0

Mr. George Baldwin IV
re: 44 SE Tortoise Ln
785 Waukegan Rd
Lake Forest IL 60045
22-40-42-015-006-00020-8

Mr. & Mrs. Charles Fonner
re: 42 SE Tortoise Ln
42 SE Tortoise Ln
Tequesta FL 33469
22-40-42-015-006-00030-6

Pariseau Fam Tr
re: 40 SE Tortoise Ln
70 Wedgemere Ave
Winchester MA 01890
22-40-42-015-006-00040-4

Mr. Leon Battiston
re: 38 SE Tortoise Ln
14 Lhirondelle Ln
Stonington CT 06378
22-40-42-015-006-00050-1

Mr. & Mrs. James Loudon
re: 36 SE Tortoise Ln
36 SE Tortoise Ln
Tequesta FL 33469
22-40-42-015-006-00060-9

Mr. & Mrs. Bruce Cassidy
re: 34 SE Tortoise Ln
34 Tortoise Ln
Tequesta FL 33469
22-40-42-015-006-00070-7

Mr. & Mrs. Bernard Kries
re: 32 SE Turtle Creek Dr
32 SE Turtle Creek Dr
Tequesta FL 33469
22-40-42-015-006-00080-5

Mr. Frederick Remmy
re: 30 SE Turtle Creek Dr
30 SE Turtle Creek Dr
Tequesta FL 33469
22-40-42-015-006-00090-3

Mr. & Mrs. Kenneth Suereth
re: 28 SE Turtle Creek Dr
28 SE Turtle Creek Dr
Tequesta FL 33469
22-40-42-015-006-00100-1

Mr. & Mrs. Albert De Grasse
re: 26 SE Turtle Creek Dr
26 SE Turtle Creek Dr
Tequesta FL 33469
22-40-42-015-006-00110-9

Mr. & Mrs. Daniel Wallen
re: 24 SE Turtle Creek Dr
24 SE Turtle Creek Dr
Tequesta FL 33469
22-40-42-015-006-00120-7

Ms. Jeanne MacLean
re: 22 SE Turtle Creek Dr
22 SE Turtle Creek Dr
Tequesta FL 33469
22-40-42-015-006-00130-5

Mr. & Mrs. David Wright
re: 20 SE Turtle Creek Dr
2111 Shadowbrook Dr
Wall Township NJ 07719
22-40-42-015-006-00140-3

Mr. & Mrs. George Weston
re: 18 SE Turtle Creek Dr
18 SE Turtle Creek Dr
Tequesta FL 33469
22-40-42-015-006-00150-0

Mr. & Mrs. Francis Bensel
re: 16 SE Turtle Creek Dr
16 SE Turtle Creek Dr
Tequesta FL 33469
22-40-42-015-006-00160-8

L Carter III/M Harkey
re: 14 SE Turtle Creek Dr
14 SE Turtle Creek Dr
Tequesta FL 33469
22-40-42-015-006-00170-6

Mr. & Mrs. James Piazza
re: 12 SE Turtle Creek Dr
12 SE Turtle Creek Dr
Tequesta FL 33469
22-40-42-015-006-00180-4

Ms. Kimberly Heatley
re: 10 SE Turtle Creek Dr
131 Viscaya Ests Dr
Palm Bch Grdns FL 33418
22-40-42-015-006-00190-2

Mr. & Mrs. Dustin Mc Clary
re: 31 SE Turtle Creek Dr
PO Box 510496
Key Colony Bch FL 33051
22-40-42-015-007-00010-8

Ms. Nancy May
re: 29 SE Turtle Creek Dr
49 Hampton Cir
Hull MA 02045
22-40-42-015-007-00020-6

Mr. & Mrs. Daniel Grieve
re: 27 SE Turtle Creek Dr
27 SE Turtle Creek Dr
Tequesta FL 33469
22-40-42-015-007-00030-4

Ms. Lisa Potter
re: 25 SE Turtle Creek Dr
25 SE Turtle Creek Dr
Tequesta FL 33469
22-40-42-015-007-00040-2

Mr. Thomas Cullen
re: 23 SE Turtle Creek Dr
PO Box 3026
Tequesta FL 33469
22-40-42-015-007-00050-9

Mr. John Lindell
re: 21 SE Turtle Creek Dr
11 W Ocean Blvd
Stuart FL 34994
22-40-42-015-007-00060-7

Ms. Margaret Baker
re: 17 SE Turtle Creek Dr
40 Mountain View Dr
W Hartford CT 06117
22-40-42-015-007-00070-5

Mr. & Mrs. Thomas Capolino
re: 15 SE Turtle Creek Dr
15 SE Turtle Creek Dr
Tequesta FL 33469
22-40-42-015-007-00080-3

Mr. & Mrs. Matthew Parisi
re: 13 SE Turtle Creek Dr
13 SE Turtle Creek Dr
Tequesta FL 33469
22-40-42-015-007-00090-1

Mr. & Mrs. Edwin Olmstead
re: 11 SE Turtle Creek Dr
11 SE Turtle Creek Dr
Tequesta FL 33469
22-40-42-015-007-00100-9

CONRAD J. DeSANTIS
Business & Real Estate
Also Admitted in Pennsylvania

TIMOTHY W. GASKILL
Business, Probate
Family Litigation

DONALD R. SMITH
Personal Injury & Wrongful Death
Commercial Litigation

CURTIS L. SHENKMAN
Board Certified
Real Estate Attorney

BROOKE GROGAN
Attorney



DeSANTIS, GASKILL, SMITH & SHENKMAN, P.A.

ATTORNEYS & COUNSELORS AT LAW

ESTABLISHED 1973

11891 U.S. HIGHWAY ONE, SUITE100
NORTH PALM BEACH, FLORIDA 33408

TELEPHONE (561) 622-2700 FACSIMILE (561) 622-2841

www.LawPalmBeach.com

LEGAL ASSISTANTS

CIVIL TRIAL, PROBATE
AND FAMILY LAW
KAREN M. BOYDEN-LOPATOSKY
MINDY VASSER

PERSONAL INJURY

ROBIN B. MODLIN, CP
TERRI L. VLASSICK

REAL ESTATE

JUDY D. MONTEIRO
DENISE B. PAOLUCCI

February 11, 2016

Sent by email

D. Albery Arrington, PhD., Executive Director
Clint Yerkes, Deputy Executive Director
Loxahatchee River Environmental Control District
2500 Jupiter Drive
Jupiter, Florida 33458-8964

Re: Initial Resolution for **TURTLE CREEK SUBSYSTEM 3** Assessment Area

Dear Dr. Arrington and Mr. Yerkes:

Per your request, please attach to this letter the Pending Lien Notice, Notice of Intent to Assess, Resolution 2016-12, the PROPOSED "Exhibit B Description of Improvements", "Exhibit B Map of the Assessment Area", and preliminary List of Property Owners.

A **SUGGESTED MOTION** for the Board to consider is:

"THAT THE GOVERNING BOARD approve Resolution 2016-12 the NOTICE OF INTENT to Assess, the Pending Lien Notice, and the Exhibits for the **TURTLE CREEK SUBSYTEM 3** Assessment Area."

I will bring the originals to be signed at the Governing Board meeting. Thereafter the District will record in the Public Records.

Sincerely,

Curtis L. Shenkman

Curtis L. Shenkman

RETURN TO: WC-53
Curtis L. Shenkman, Esquire
DeSantis, Gaskill, Smith & Shenkman, P.A.
11891 U.S. Highway One
North Palm Beach, Florida 33408

PENDING LIEN NOTICE
TURTLE CREEK SUBSYSTEM 3 ASSESSMENT AREA

THE LOXAHATCHEE RIVER ENVIRONMENTAL CONTROL DISTRICT, a special district of the State of Florida, created in 1971 and existing pursuant to Chapter 2002-358, Laws of Florida (hereinafter referred to as the “District”, hereby clarifies the lien status of the “Notice of Intent to Assess” attached hereto and made a part hereof (referred to as the “Pending Lien”).

The Pending Lien shall not be considered certified, confirmed or ratified until such time as the passage of the Final Assessment Roll Resolution of the District.

The intention of the District in publishing this Pending Lien Notice is to assist the property owners who may be selling or refinancing their property and parties who may be placing a mortgage on their property to do so knowing that the District is not seeking the payment of any funds on the Pending Lien until the non-ad valorem tax bill is issued for the property on the date set forth in the Final Assessment Roll Resolution of the District.

Any inquiries as to the Pending Lien and the timing for the Final Assessment Roll Resolution and payment of said special assessments should be directed to:

LOXAHATCHEE RIVER ENVIRONMENTAL CONTROL DISTRICT
2500 Jupiter Park Drive
Jupiter, Florida 33458
Phone: (561) 747-5700

IN WITNESS WHEREOF, the undersigned, Executive Director of the Loxahatchee River Environmental Control District, herein certifies that on this 18th day of FEBRUARY, 2016, the information contained herein is true and accurate.

WITNESSES:

LOXAHATCHEE RIVER ENVIRONMENTAL
CONTROL DISTRICT

By: _____
D. Albrey Arrington, Ph.D.
EXECUTIVE DIRECTOR

STATE OF FLORIDA
COUNTY OF PALM BEACH

The foregoing instrument was acknowledged before me this 18th day of February, 2016, by D. Albrey Arrington, EXECUTIVE DIRECTOR of the LOXAHATCHEE RIVER ENVIRONMENTAL CONTROL DISTRICT, a special district of the State of Florida, on behalf of the District, personally known to me.

(NOTARY SEAL)

NOTARY PUBLIC, STATE OF FLORIDA

Special/Assessment/PendingLienNotice

RETURN TO: WC-53
Curtis L. Shenkman, Esquire
DeSantis, Gaskill, Smith & Shenkman, P.A.
11891 U.S. Highway One
North Palm Beach, Florida 33408

**NOTICE OF INTENT TO ASSESS
TURTLE CREEK SUBSYSTEM 3 ASSESSMENT AREA**

THE LOXAHATCHEE RIVER ENVIRONMENTAL CONTROL DISTRICT, a special district of the State of Florida (the “District”) **created in 1971 and existing pursuant to Chapter 2002-358, Laws of Florida**, (the “Act”), hereby gives public notice that the District’s Governing Board on the 18th day of February, 2016, passed Resolution **2016-12**, authorizing the construction of certain local sewer improvements as further described in said Resolution **2016-12**, which is attached hereto as Exhibit “A”. It is the intent of the District to assess the owners of property specially benefited by such sewer improvements, which property is further described on the attached **Exhibit “B”**, and to apportion the District’s costs for the total expenses related to the design and construction of said improvements, based upon each owner’s proportionate share of said costs determined upon a square footage basis, or by other methods as the Governing Board may deem fair and equitable, pursuant to the Act and Rules of the District, as same may be amended from time to time hereafter.

Any inquiries to the District’s progress in completing certification of said assessments should be directed to:

LOXAHATCHEE RIVER ENVIRONMENTAL CONTROL DISTRICT
2500 Jupiter Park Drive
Jupiter, Florida 33458

IN WITNESS WHEREOF, the undersigned, Executive Director of the Loxahatchee River Environmental Control District, hereby certifies on this 18th day of FEBRUARY, 2016, that the information contained herein is true and accurate.

WITNESSES:

D. Albrey Arrington
Executive Director

STATE OF FLORIDA
COUNTY OF PALM BEACH

SWORN TO and subscribed before me this 18th day of February, 2016, by D. Albrey Arrington, EXECUTIVE DIRECTOR of the LOXAHATCHEE RIVER ENVIRONMENTAL CONTROL DISTRICT, who is personally known to me.

(NOTARY SEAL)

NOTARY PUBLIC, STATE OF FLORIDA

Special/Assessment/NoticeIntentToAssess

RESOLUTION 2016-12

A RESOLUTION OF THE LOXAHATCHEE RIVER ENVIRONMENTAL CONTROL DISTRICT RELATING TO **TURTLE CREEK SUBSYSTEM 3** ASSESSMENT AREA IMPROVEMENTS IN ACCORDANCE WITH DISTRICT RULE 31-11; STATING THE NATURE OF THE PROPOSED IMPROVEMENTS; DESIGNATING THE STREETS TO BE IMPROVED; DESIGNATING THAT PLANS, SPECIFICATIONS, AND A TENTATIVE APPORTIONMENT BE PREPARED; PROVIDING FOR THE AVAILABILITY OF PLANS AND SPECIFICATIONS AND FOR THE PREPARATION OF THE PRELIMINARY SPECIAL ASSESSMENT ROLL; PROVIDING FOR DECLARING LINE AVAILABLE FOR CONNECTION; PROVIDING FOR CONSISTENCY; PROVIDING FOR SEVERABILITY; PROVIDING AN EFFECTIVE DATE.

WHEREAS, the Governing Board of the Loxahatchee River Environmental Control District (hereinafter called the “District”) has considered the need for improvements to the **TURTLE CREEK SUBSYSTEM 3** Assessment Area (the “Area”) in Martin County, Florida;

WHEREAS the District shall construct and declare available sewerage collection lines and related appurtenances comprising a localized District sewer system in the Area as an Established Residential Neighborhood based upon the Governing Board’s determination of any of the following:

- (1) n/a; or
- (2) that a reasonable alternative to the septic tanks exists for the treatment of the sewerage, taking into consideration factors such as cost; or
- (3) the discharge from the septic tanks is adversely affecting the health of the user or the public, or the groundwater or surface water is degraded; or
- (4) to enhance the environmental and scenic value of surface waters.

WHEREAS, the Governing Board has considered the facts, evidence, and presentations of the District Engineer, District staff and consultants as to the need for sanitary sewers in the Area and considered such recommendations to be in accordance with the above referenced Criteria of the “Ellis Rule” as well as in the best interests of the citizens of the District and the citizens of this Area.

NOW, THEREFORE, BE IT RESOLVED BY THE GOVERNING BOARD OF THE DISTRICT, THAT:

Section 1. Title:

This Resolution shall be known as the Resolution Authorizing the Project known as “**TURTLE CREEK SUBSYSTEM 3** Assessment Area Improvements”.

Section 2. Nature of Improvements:

The project improvements shall consist of the construction of a waste water and sewage system within lands under the jurisdiction of the District. The proposed improvements performed shall generally consist of those set forth on Composite Exhibit “B”.

Section 3. Designation of Streets to be Improved:

The streets included within the **TURTLE CREEK SUBSYSTEM 3** Assessment Area Improvements are set forth on Composite Exhibit “B”.

Section 4. Plans, Specifications and Tentative Apportionment:

Upon adoption of this Resolution, The District Engineers and staff shall prepare plans, specifications and estimated total costs of such proposed improvements, together with a tentative apportionment of such costs between the District and individual parcels of property receiving special benefits pursuant to the improvements.

Section 5. Public Inspection:

The Plans, Specifications and tentative apportionments for the **TURTLE CREEK SUBSYSTEM 3** Assessment Area Improvements shall be available for inspection in the Office of the

Executive Director, Loxahatchee River Environmental Control District, 2500 Jupiter Park Drive, Jupiter, Florida 33458. The District’s Engineer shall make available said plans and specifications prepared incident thereto, for inspection in the Office of the District’s Engineer.

Section 6. Assessment Roll:

The District Clerk is directed to prepare a Preliminary Assessment Roll based upon this Resolution, District Rule 31-11, and the District Engineer’s tentative apportionment, and to make publication of notice in newspapers in Martin and Palm Beach Counties, together with notice mailed to those interested parties and affected property owners requesting such in writing, in accordance with the requirements of District Rule 31-11.

Section 7. Availability for Connection and Required Connection:

The waste water and sewerage system shall be “Available” for connection in accordance with District Rule 31-3.003(3) and Florida Statutes 381.0065(2)(a) when the Florida Department of Health releases the system for service, which is the date of actual “Availability”. In accordance with Florida Statutes 381.00655, the affected property owners shall be required to connect to the sewerage system within one (1) year of the actual Availability.

Section 8. All Resolutions or parts of Resolutions in conflict herewith are hereby repealed to the extent of such conflict.

Section 9. In the event that any portion of this Resolution is found to be unconstitutional or improper, it shall be severed herefrom and shall not affect the validity of the remaining portions of this Resolution.

Section 10. This Resolution shall become effective upon its passage and adoption.

PASSED AND ADOPTED BY THE GOVERNING BOARD OF THE LOXAHATCHEE RIVER ENVIRONMENTAL CONTROL DISTRICT, THIS 18th DAY OF FEBRUARY, 2016.

LOXAHATCHEE RIVER ENVIRONMENTAL CONTROL DISTRICT
VOTE

GORDON M. BOGGIE, Chairman

STEPHEN ROCKOFF

HARVEY M. SILVERMAN

JAMES D. SNYDER

DR. MATT H. ROSTOCK

EXHIBIT "B"

TURTLE CREEK - SUBSYSTEM 3

SEWER SYSTEM ASSESSMENT AREA

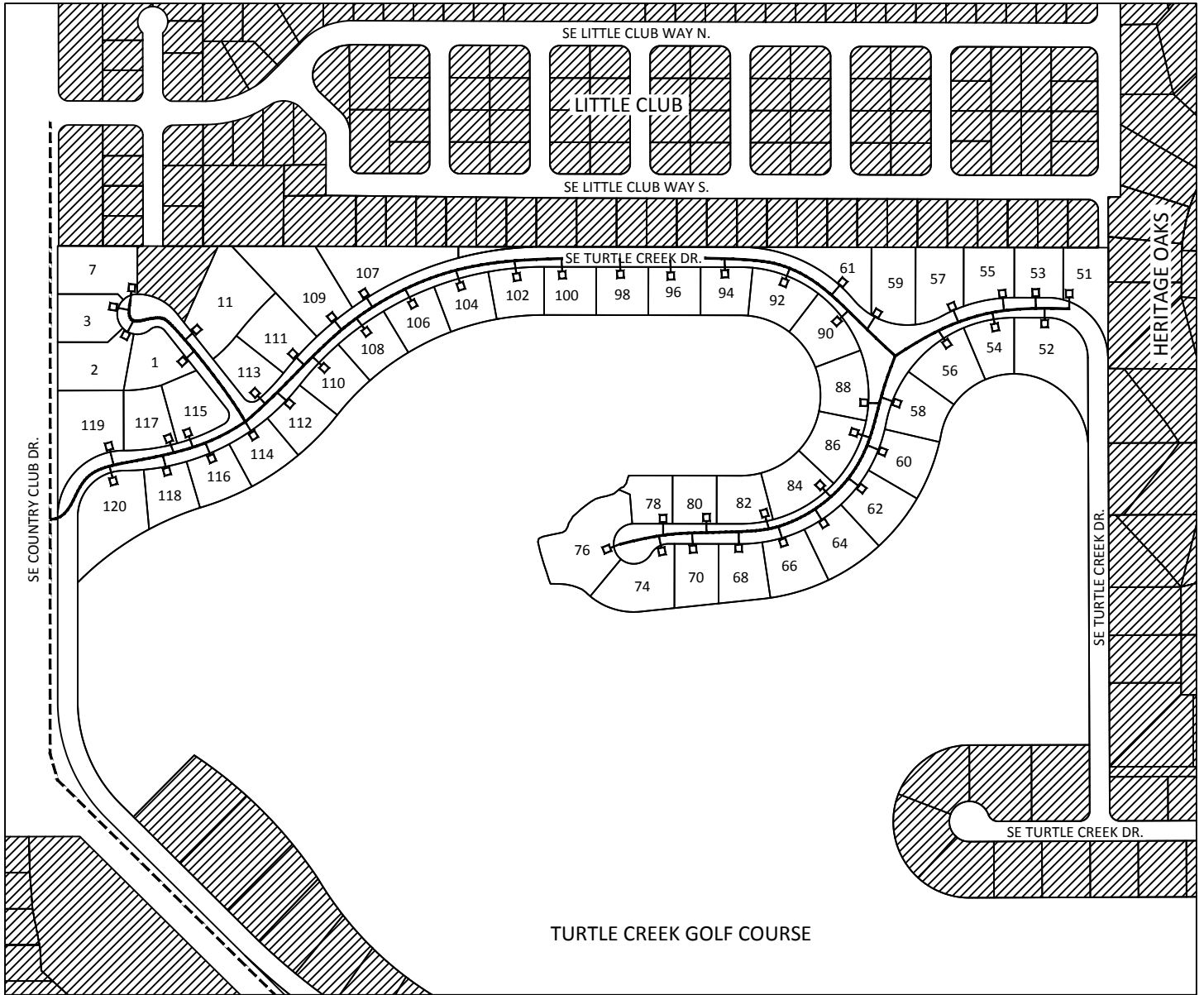

LEGEND

- NOT IN ASSESSMENT AREA
- EXISTING 6" FORCE MAIN
- PROPOSED 2" FORCE MAIN
- PROPOSED LP SEWER SERVICE

MARTIN COUNTY, FLORIDA

EXHIBIT “B”

PROPOSED SEWER SERVICE ASSESSMENT AREA

TURTLE CREEK SUBSYSTEM 3 ASSESSMENT AREA

The properties to be provided sewer service are located within Section 22, Township 40 South, Range 42 East, Unincorporated Martin County, Florida and lies within the following general boundaries:

- On the North by Little Club Subdivision;
- On the South by Turtle Creek Golf Course;
- On the East by Heritage Oaks Subdivision; and
- On the West by SE Country Club Drive.

The approximate quantity of materials required to complete the project are:

- 4,410 Lineal Feet 2” Low Pressure Sewer Lines
- 52 Service Connections
- 52 Low Pressure Pumping Units
- 3 Terminal Flushing Ports
- 9 Inline Flushing Ports

Mr. & Mrs. Larry Viens
re: 52 SE Turtle Creek Dr
PO Box 7359
Jupiter FL 33468
22-40-42-015-001-00010-1

Mr. & Mrs. Arthur Lahr
re: 54 SE Turtle Creek Dr
54 SE Turtle Creek Dr
Tequesta FL 33469
22-40-42-015-001-00020-9

Mr. & Mrs. Richard Tessaro
re: 56 SE Turtle Creek Dr
56 SE Turtle Creek Dr
Tequesta FL 33469
22-40-42-015-001-00030-7

Mr. & Mrs. William Hawkins
re: 58 SE Turtle Creek Dr
58 SE Turtle Creek Dr
Tequesta FL 33469
22-40-42-015-001-00040-5

Ms. Carole Fambrini
re: 60 SE Turtle Creek Dr
60 SE Turtle Creek Dr
Tequesta FL 33469
22-40-42-015-001-00050-2

Mr. & Mrs. William Mc Nealy
re: 62 SE Turtle Creek Dr
62 SE Turtle Creek Dr
Tequesta FL 33469
22-40-42-015-001-00060-0

Mr. & Mrs. Stephen Wilgar
re: 64 SE Turtle Creek Dr
64 SE Turtle Creek Dr
Tequesta FL 33469
22-40-42-015-001-00070-8

Mr. & Mrs. Clement Springer
re: 66 SE Turtle Creek Dr
66 SE Turtle Creek Dr
Tequesta FL 33469
22-40-42-015-001-00080-6

Mr. & Mrs. Dennis Coffey
re: 68 SE Turtle Creek Dr
68 SE Turtle Creek Dr
Tequesta FL 33469
22-40-42-015-001-00090-4

D Greene/S Johnson
re: 70 SE Turtle Creek Dr
70 SE Turtle Creek Dr
Tequesta FL 33469
22-40-42-015-001-00100-2

Mr. & Mrs. Edwin Frost
re: 74 SE Turtle Creek Dr
74 SE Turtle Creek Dr
Tequesta FL 33469
22-40-42-015-001-00110-0

Ms. Mary Larizza
re: 76 SE Turtle Creek Dr
76 SE Turtle Creek Dr
Tequesta FL 33469
22-40-42-015-001-00120-8

Mr. & Mrs. Fred Ash
re: 78 SE Turtle Creek Dr
78 SE Turtle Creek Dr
Tequesta FL 33469
22-40-42-015-001-00140-4

Mr. & Mrs. David Wales
re: 80 SE Turtle Creek Dr
80 SE Turtle Creek Dr
Tequesta FL 33469
22-40-42-015-001-00150-1

Mr. Lew Rumsmoke
re: 82 SE Turtle Creek Dr
82 SE Turtle Creek Dr
Tequesta FL 33469
22-40-42-015-001-00160-9

Mr. & Mrs. Anton Greaton
re: 84 SE Turtle Creek Dr
84 SE Turtle Creek Dr
Tequesta FL 33469
22-40-42-015-001-00170-7

Mr. & Mrs. John Maentanis
re: 86 SE Turtle Creek Dr
5337 Fairview
Skokie IL 60077
22-40-42-015-001-00180-5

B Vankat/V Goger
re: 88 SE Turtle Creek Dr
305 Baltimore Ave
Pt Pleasant Bch NJ 08742
22-40-42-015-001-00190-3

Mr. & Mrs. Ronald Harrison
re: 90 SE Turtle Creek Dr
PO Box 221
Orleans MA 02643
22-40-42-015-001-00200-1

Mr. & Mrs. John Andersen
re: 92 SE Turtle Creek Dr
92 SE Turtle Creek Dr
Tequesta FL 33469
22-40-42-015-001-00210-9

Mr. & Mrs. Lawrence Magar
re: 94 SE Turtle Creek
94 SE Turtle Creek
Tequesta FL 33469
22-40-42-015-001-00220-7

Mr. & Mrs. Douglas Knowles
re: 96 SE Turtle Creek Dr
13 Saddleback Rd
Tequesta FL 33469
22-40-42-015-001-00230-5

Mr. & Mrs. Arthur Hanoian
re: 98 SE Turtle Creek Dr
98 SE Turtle Creek Dr
Tequesta FL 33469
22-40-42-015-001-00240-3

Mr. Mark Sedelnik
re: 100 SE Turtle Creek Dr
100 SE Turtle Creek Dr
Tequesta FL 33469
22-40-42-015-001-00250-0

Ms. Dorothy Koteski
re: 102 SE Turtle Creek Dr
27 Cooper Run Dr
Cherry Hill NJ 08003
22-40-42-015-001-00260-8

Mr. & Mrs. Frank Horgan
re: 104 SE Turtle Creek Dr
180 Park Ave
Centerville MA 02632
22-40-42-015-001-00270-6

Mr. & Mrs. Christopher Housen
re: 106 SE Turtle Creek Dr
403 1/2 Osprey Pt Dr
Brielle NJ 08730
22-40-42-015-001-00280-4

Mr. & Mrs. Robert Hendrickson
re: 108 SE Turtle Creek Dr
108 SE Turtle Creek Dr
Tequesta FL 33469
22-40-42-015-001-00290-2

Mr. & Mrs. James Scott
re: 110 SE Turtle Creek Dr
110 SE Turtle Creek Dr
Tequesta FL 33469
22-40-42-015-001-00300-0

Mr. & Mrs. Arthur Fritz
re: 112 SE Turtle Creek Dr
112 SE Turtle Creek Dr
Tequesta FL 33469
22-40-42-015-001-00310-8

Mr. & Mrs. John Sullivan
re: 114 SE Turtle Creek Dr
114 SE Turtle Creek Dr
Tequesta FL 33469
22-40-42-015-001-00320-6

Ms. Adelor Warren
re: 116 SE Turtle Creek Dr
116 SE Turtle Creek Dr
Tequesta FL 33469
22-40-42-015-001-00330-4

Mr. & Mrs. Richard Greisch
re: 118 SE Turtle Creek Dr
402 Reserve Trl
Chagrin Falls OH 44022
22-40-42-015-001-00340-2

Mr. & Mrs. Peter Holcomb
re: 120 SE Turtle Creek Dr
120 SE Turtle Creek Dr
Tequesta FL 33469
22-40-42-015-001-00350-9

Mr. & Mrs. Janis Partlow
re: 51 SE Turtle Creek Dr
112 E Coral Fish Ln
Jupiter FL 33477
22-40-42-015-002-00010-9

Mr. Patrick Cicalese
re: 53 SE Turtle Creek Dr
53 SE Turtle Creek Dr
Tequesta FL 33469
22-40-42-015-002-00020-7

Mr. Roger Buckwalter
re: 55 SE Turtle Creek Dr
48 Wingo St
Tequesta FL 33469
22-40-42-015-002-00030-5

Mr. & Mrs. Harry Fry Jr
re: 57 SE Turtle Creek Dr
57 SE Turtle Creek Dr
Tequesta FL 33469
22-40-42-015-002-00040-3

Ms. Patricia Millman
re: 59 SE Turtle Creek Dr
59 SE Turtle Creek Dr
Tequesta FL 33469
22-40-42-015-002-00050-0

F Latimer/C Colitz
re: 61 SE Turtle Creek Dr
61 SE Turtle Creek Dr
Tequesta FL 33469
22-40-42-015-002-00060-8

Ms. Tania Rosello
re: 107 SE Turtle Creek Dr
107 SE Turtle Creek Dr
Tequesta FL 33469
22-40-42-015-003-00010-7

Mr. & Mrs. Sam Van Sickle
re: 109 SE Turtle Creek Dr
109 SE Turtle Creek Dr
Tequesta FL 33469
22-40-42-015-003-00020-5

Ms. Pauline Brociner
re: 111 SE Turtle Creek Dr
111 SE Turtle Creek Dr
Tequesta FL 33469
22-40-42-015-003-00030-3

Mr. & Mrs. Ronald Johnson
re: 113 SE Turtle Creek Dr
113 SE Turtle Creek Dr
Tequesta FL 33469
22-40-42-015-003-00040-1

Mr. & Mrs. Jerold Miller
re: 115 SE Turtle Creek Dr
115 SE Turtle Creek Dr
Tequesta FL 33469
22-40-42-015-003-00050-8

Ms. Geraldine Gardner
re: 117 SE Turtle Creek Dr
117 SE Turtle Creek Dr
Tequesta FL 33469
22-40-42-015-003-00060-6

Mr. & Mrs. Anthony Interdonato
re: 119 SE Turtle Creek Dr
119 SE Turtle Creek Dr
Tequesta FL 33469
22-40-42-015-003-00070-4

Mr. & Mrs. Forest Padon
re: 1 SE Loggerhead Ln
1 SE Loggerhead Ln
Tequesta FL 33469
22-40-42-015-003-00080-2

Mr. & Mrs. John Rice
re: 2 SE Loggerhead Ln
2 SE Loggerhead Ln
Tequesta FL 33469
22-40-42-015-003-00090-0

Mr. & Mrs. John Bachman
re: 3 SE Loggerhead Ln
3 SE Loggerhead Ln
Tequesta FL 33469
22-40-42-015-003-00100-8

Ms. Kathleen Jennings
re: 7 SE Loggerhead Ln
7 SE Loggerhead Ln
Tequesta FL 33469
22-40-42-015-003-00110-6

Ms. Catherine Von Paul
re: 11 SE Loggerhead Ln
11 SE Loggerhead Ln
Tequesta FL 33469
22-40-42-015-003-00130-2

The Palm Beach County Interlocal Agreement covering County Road Open Cuts is not available at this time.

Loxahatchee River District

Water Reclamation | Environmental Education | River Restoration

2500 Jupiter Park Drive, Jupiter, Florida 33458

Telephone (561) 747-5700 • Fax (561) 747-9929 • www.loxahatcheeriver.org



D. Albrey Arrington, Ph.D., Executive Director

MEMORANDUM

TO: D. ALBREY ARRINGTON, Ph.D.
Executive Director

FROM: CLINTON R. YERKES
Deputy Executive Director

DATE: FEBRUARY 9, 2016

SUBJECT: ROLLING GREEN ROAD
Purchase of Low Pressure Pump Units

The Rolling Green Road low pressure transmission system construction has recently been completed and certified complete.

A total of 25 homes are included in this project. Most of the homes (20) will use a simplex system however 5 homes will require duplex units. The costs break down for this purchase, based upon the February, 2013 pricing is as follows:

20 Simplex Units @ \$3,235.00 = \$64,700.00
5 Duplex Units @ \$8,188.00 = \$40,940.00

As you may recall Southeastern Pumps has been designated by the District as a sole source provider for the low pressure grinder stations.

The following motion is suggested for this purchase:

“THE DISTRICT GOVERNING BOARD has received documentation from the Purchasing Principal that the following materials can only be obtained through a “sole source”, as described in the District Procurement Policy, and approves excepting this purchase from bid requirements; therefore

THE DISTRICT GOVERNING BOARD authorizes the purchase of 20 simplex grinder pump units, and 5 duplex grinder pump units, from Southeastern Pump in the total amount of \$105,640.00.”

Should you have any questions regarding this purchase please contact me.

v://cip/special/lpss/pumppurch/2016/Board Memo

Stephen B. Rockoff
Board Member

Dr. Matt H. Rostock
Board Member

Gordon M. Boggie
Chairman

Harvey M. Silverman
Board Member

James D. Snyder
Board Member

Loxahatchee River District

Water Reclamation | Environmental Education | River Restoration

2500 Jupiter Park Drive, Jupiter, Florida 33458-8964

Telephone (561) 747-5700 • Fax (561) 747-9929 • www.loxahatcheeriver.org



D. Albrey Arrington, Ph.D., Executive Director

MEMORANDUM

TO: FILE
ACCOUNTING DEPT.

FROM: PURCHASING PRINCIPAL – Clinton Yerkes

DATE: JUNE 18, 2014

SUBJECT: SOLE SOURCE PURCHASE DETERMINATION

In accordance with Chapter 255.04 of the Florida Statutes the following equipment or system has been determined to be a sole source purchase in accordance with the following:

- (1) I, Clinton R. Yerkes, as Purchasing Principal have reviewed the requirements and specifications for the low pressure pumping units and have determined after consideration of all available alternative materials and systems that the specification of a sole material or system is justifiable based upon its standardized configuration and interchangeability;
- (2) The sole source specification has been recommended by the engineer of record (See **attached written recommendation**); and
- (3) The consideration by, and the justifications of, the governmental body are documented, in writing, in the project file.

In accordance with District Purchasing Procedure a sole source purchase is allowed under the following conditions:

Category 1 & 2 Purchases - if the Purchasing Principal provides written statement of the conditions and circumstances requiring the purchase of a sole source item. The statement shall be filed with Accounting attached to the Purchase Order.

Category 3 Purchases - Purchasing Principal has determined that the service or good is available from a single source the purchase may be excepted from bid requirements by the Board, upon the filing of a certification by the Purchasing Principal stating conditions and circumstances requiring the purchase. The intention shall be presented to the Board on the consent agenda at the next regularly scheduled public meeting.

V:/specl/lpss/pmppurchase/solesource 6-2014

Gordon M. Boggie
Board Member

Stephen B. Rockoff
Board Member

Dr. Matt H. Rostock
Chairman

Harvey M. Silverman
Board Member

James D. Snyder
Board Member

Loxahatchee River District

Water Reclamation | Environmental Education | River Restoration

2500 Jupiter Park Drive, Jupiter, Florida 33458-8964

Telephone (561) 747-5700 • Fax (561) 747-9929 • www.loxahatcheeriver.org



D. Albrey Arrington, Ph.D., Executive Director

MEMORANDUM

TO: Clinton R. Yerkes, Deputy Executive Director

FROM: Kris Dean, P.E., Director of Engineering Services

DATE: June 17, 2014

SUBJECT: Sole Source Purchase Determination
Southeastern Pump Low Pressure Pump Station

I have reviewed the low pressure pumping unit specifications and details and based on the District's desire to minimize variations in the field with standardized installations recommend the sole source purchase of the low pressure pumping units from Southeastern Pump.

Signed,

Kris Dean, P.E.
Director of Engineering Services

MA\ENGINEER\SOLE SOURCE\Southeastern Low Pressure Pumping Units.docx

Loxahatchee River District

Water Reclamation | Environmental Education | River Restoration

2500 Jupiter Park Drive, Jupiter, Florida 33458

Telephone (561) 747-5700 • Fax (561) 747-9929 • www.loxahatcheeriver.org



D. Albrey Arrington, Ph.D., Executive Director

MEMORANDUM

TO: D. ALBREY ARRINGTON, Ph.D.
Executive Director

FROM: CLINTON R. YERKES
Deputy Executive Director

DATE: FEBRUARY 8, 2016

SUBJECT: FILTER PUMP STATION #2 PUMP & MOTOR PURCHASE

This is a budgeted item for the purchase of a new pump & motor for this area of the Plant. Once purchased, this pump & motor will go in the maintenance rotation so while a unit may be taken out for rehabilitation, the Filter Pump Station will remain fully operational. Lead times on these items can run several months.

One pump & motor units s scheduled for removal and maintenance when the new unit arrives.

The attached quotation has been determined to be a sole source by our plant consultant engineers, and approved by the Director of Operations and Purchasing Agent.

The following motion is suggested for approval of this item:

“THE DISTRICT GOVERNING BOARD has received documentation from the Purchasing Agent that the following materials can only be obtained through a “sole source”, as described in the District Procurement Policy, and approves excepting this purchase from bid requirements; therefore

THE DISTRICT GOVERNING BOARD authorize the purchase of 1 new Goulds/Xylem pump and motor for Filter Pump Station #2, in accordance with their Quotation dated January 26, 2016, and in the amount of \$74,734.00.

Should you have any questions regarding this item please contact Tom or me.

V://cip/proj/miscequip/pumps/fps#2 2016

Stephen B. Rockoff
Board Member

Dr. Matt H. Rostock
Board Member

Gordon M. Boggie
Chairman

Harvey M. Silverman
Board Member

James D. Snyder
Board Member



Pump & Equipment

A Division of Tencarva Machinery Company

3524 Craftsman Boulevard • Lakeland, FL • 33803

Tel: (863) 665-7867 • **Fax:** (863) 666-5649

Municipal Division

Quote No: 012616CJ1
 Customer: Loxahatchee River District
 Location:
 Attn: Anthony Nicoletto
 Phone:
 Fax:
 Email: Anthony.nicoletto@loxahatcheeriver.org
 From: Cathy Jackson/Larry Strickland

Date: 02/09/16
 No. Pages: 1
 Your No.:
 Delivery: 18 weeks
 Terms: N30
 F.O.B.: Destination
 Freight included

Conditions of Service: Filter Pump Station Pump 3336 GPM @ 30' TDH

We are pleased to quote as follows:

Qty.	Description	Price Each	Delivery
1	Goulds/Xylem VIC-FLFM – Canned Turbine Open Lineshaft Pump, Model 16RGHC/1-Stage Bowl Assembly, 14" x 1.50" Flanged W/L Column Assembly, 16" x 16.5" FL 150# Discharge Head Assembly, Tnemec 141 8 Mil Coating for Bowl Assy OD, OD & ID of Column & Head Assy, US Motor VSS 40Hp, 1200 RPM, TEFC Premium Efficient Motor. Replacement to S/N 501949-2 Less Can.	\$73,734.00	18 weeks

Quote Valid for 90 Days

With the following notes:

1. Freight is included.

Best Regards,

Cathy Jackson

HUDSON PUMP & EQUIPMENT

phone: (863) 665-7867

Quoted By: Cathy Jackson



Hazen and Sawyer
2101 NW Corporate Blvd., Suite 301
Boca Raton, FL 33062 • 561-997-8070

February 11, 2016

Transmitted Electronically

Hazel M. Figueroa, Purchasing Agent
Loxahatchee River Environmental Control District
2500 Jupiter Park Drive
Jupiter, Florida 33458-8964

Re: Wastewater Treatment Plant - Goulds/Xylem Pump Purchase - Filter Pump Station No. 2

Dear Ms. Figueroa:

It is the desire of Loxahatchee River District (District) staff to purchase a Goulds/Xylem turbine pump and motor to serve as a spare replacement for existing Goulds/Xylem turbine pump and motors installed at Filter Pump Station No. 2 of the District's Wastewater Treatment Facility.

It is proposed that the Goulds/Xylem turbine pump and motor be provided by Hudson Pump and Equipment who is the exclusive municipal representative of Goulds/Xylem turbine pumps and motors. A Goulds/Xylem pump and motor is necessary to match the existing pump station discharge piping, controls, electrical, and other support elements of the installed, existing Goulds/Xylem configuration at Filter Pump Station No. 2. As this equipment is only available from the exclusive municipal representative (Hudson Pump and Equipment), we recommend that the Goulds/Xylem turbine pump and motor be purchased from Hudson Pump and Equipment.

We appreciate the opportunity to assist you in this effort. Please contact us if you require any additional information.

Very truly yours,

John C. Koroshec, P.E.
Senior Associate

c: File 42009-025-3.1.2

42009-025-3.1.2_Hudson Pump/FPS

Loxahatchee River District

Water Reclamation | Environmental Education | River Restoration

2500 Jupiter Park Drive, Jupiter, Florida 33458

Telephone (561) 747-5700 • Fax (561) 747-9929 • www.loxahatcheeriver.org

D. Albrey Arrington, Ph.D., Executive Director



MEMORANDUM

TO: File
Accounting Department

FROM: Hazel Figueroa, Purchasing Agent

DATE: February 11, 2016

SUBJECT: Sole Source Purchase Determination

In accordance with Chapter 255.04 of the Florida Statutes, the following equipment or system has been determined to be a sole source purchase in accordance with the following:

- (1) I, Hazel Figueroa, as Purchasing Principal, have reviewed the requirements and specifications for the Goulds/Xylem Turbine Pump Purchase – Filter Pump Station No. 2 and have determined, after consideration of all available alternative materials and systems, that the specification of a sole material or system is justifiable based upon its cost or interchangeability;
- (2) The sole source specification has been recommended by the engineer of record; and
- (3) The consideration by, and the justifications of, the governmental body are documented, in writing, in the project file.

In accordance with District Purchasing Procedure, a sole source purchase is allowed under the following conditions:

Category 1 & 2 Purchases - if the Purchasing Principal provides written statement of the conditions and circumstances requiring the purchase of a sole source item. The statement shall be filed with Accounting attached to the Purchase Order.

Category 3 Purchases - Purchasing Principal has determined that the service or good is available from a single source. The purchase may be excepted from bid requirements by the Board upon the filing of a certification by the Purchasing Principal stating conditions and circumstances requiring the purchase. The intention shall be presented to the Board on the consent agenda at the next regularly scheduled public meeting.

Loxahatchee River District

Water Reclamation | Environmental Education | River Restoration

2500 Jupiter Park Drive, Jupiter, Florida 33458-8964

Telephone (561) 747-5700 • Fax (561) 747-9929 • www.loxahatcheeriver.org



D. Albrey Arrington, Ph.D., Executive Director

SOLE SOURCE APPROVAL FORM

ITEM: Turbine Pump and Motor for Filter Pump Station #2

REASON FOR SOLE SOURCE: Vendor is the Municipal representative for Xylem, Inc./Goulds Water Technology Pumps, as manufactured by Xylem Texas Turbine Operations. Vendor also represents Xylem Inc./AC branded pumps. This representation is on an exclusive basis into the Municipal Utility market in the State of Florida.

VENDOR NAME: Hudson Pump & Equipment

ESTIMATED COST: \$ 73,734.00 (Includes Freight)

USING DEPT: Operations / Maintenance

APPROVAL:

DEPARTMENT HEAD NAME: Thomas Vaughn

DEPARTMENT HEAD SIGNATURE: _____

DEPARTMENT HEAD TITLE: Director of Operations

DATE: 2 / 9 / 2016

No Board action is required on this item.

Loxahatchee River District

Water Reclamation | Environmental Education | River Restoration

2500 Jupiter Park Drive, Jupiter, Florida 33458-8964

Telephone (561) 747-5700 • Fax (561) 747-9929 • www.loxahatcheeriver.org

D. Albrey Arrington, Ph.D., Executive Director



MEMORANDUM

TO: GOVERNING BOARD
FROM: KARA PETERSON
DATE: FEBRUARY 11, 2016
SUBJECT: LIABILITY INSURANCE

We are not seeking any Board action this month. This memo is to serve as a reminder that last year the District Governing Board authorized the Executive Director to enter into a two-year agreement locking in the rate with Public Risk Insurance Agency for Property, General Liability, Automobile Liability and Physical Damage, and Workers Compensation. These rates will remain the same through April 30, 2017. The premium due will be updated based on actual payroll and asset schedules. If there is no change in the District's exposure the premium will be the same as the prior year.

Please let me know if you have any questions.

F:\Albrey\Board Memos\2016-Feb_Liability-Insurance.docx

Loxahatchee River District



Water Reclamation | Environmental Education | River Restoration

2500 Jupiter Park Drive, Jupiter, Florida 33458

Telephone (561) 747-5700 • Fax (561) 747-9929 • www.loxahatcheeriver.org

D. Albrey Arrington, Ph.D., Executive Director

MEMORANDUM

TO: D. ALBREY ARRINGTON, Ph.D.
Executive Director

FROM: CLINTON R. YERKES
Deputy Executive Director

DATE: FEBRUARY 3, 2016

SUBJECT: LIFT STATION REHABILITATIONS 2015
Approval of Change Order #2

Last month the Governing Board authorized Change Order #1 to this contract. The change order had exceeded the authorized contingency for the project. The Change Order was presented at that time not knowing how close we were to closing out the contract.

Change Order #2 presented this month is an adjusting Final Change Order which results in a reduction of \$600.00 to the contract.

The attached Change Order has been approved by the Contractor and Engineer.

The following motion is suggested for approval of this item:

“THAT THE DISTRICT GOVERNING BOARD authorize execution of Change Order #2 to the Lift Station Rehabilitations for 2015 contract with B&B Underground Construction, Inc., in the amount of a \$600.00 reduction to the contract.”

Please contact me or Kris Dean if you have any questions concerning this item.

V://cip/proj/lift stations/2015 rehab/CO#2 Board mmo

Stephen B. Rockoff
Board Member

Dr. Matt H. Rostock
Board Member

Gordon M. Boggie
Chairman

Harvey M. Silverman
Board Member

James D. Snyder
Board Member

LOXAHATCHEE RIVER ENVIRONMENTAL CONTROL DISTRICT
2500 JUPITER PARK DRIVE, JUPITER, FLORIDA 33458
(561) 747-5700 FAX (561) 747-9929

CHANGE ORDER # 2

DATE: January 27, 2016

PROJECT NAME: LIFT STATION REHABILITATIONS for 2015

OWNER: Loxahatchee River Environmental Control District

CONTRACTOR: B&B Underground Construction, Inc.

THE FOLLOWING CHANGES:

Reduced 6 hours of estimated 10 hours for wet well leak repairs

JUSTIFICATION: Final adjustments based upon actual field conditions

CHANGE TO CONTRACT PRICE:

Original CONTRACT PRICE: \$198,550.00

Current Contract Price \$205,708.18

Contract Price due to this Change Order
will be *DECREASED* by: (\$ 600.00)

The New Contract Price including
this Change Order will be: \$205,108.18

CHANGE TO CONTRACT TIME:

The DATE OF SUBSTANTIAL COMPLETION will be: Unchanged

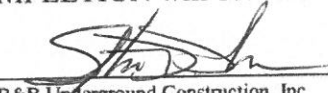
APPROVED BY CONTRACTOR:  _____ 1-29-2016
B&B Underground Construction, Inc. DATE

APPROVED BY ENGINEER:  _____ 2/1/16
Kris Dean, P.E. DATE

APPROVED BY OWNER: _____
LOXAHATCHEE RIVER ENVIRONMENTAL CONTROL DISTRICT DATE

THIS
PAGE
INTENTIONALLY
LEFT
BLANK

Loxahatchee River District

Water Reclamation | Environmental Education | River Restoration

2500 Jupiter Park Drive, Jupiter, Florida 33458-8964

Telephone (561) 747-5700 • Fax (561) 747-9929 • www.loxahatcheeriver.org



D. Albrey Arrington, Ph.D., Executive Director

MEMORANDUM

TO: GOVERNING BOARD
FROM: KARA PETERSON
DATE: FEBRUARY 12, 2016
SUBJECT: AUDIT FOR FISCAL YEARS 2015 & 2014

The Draft Annual Financial Report, prepared by Rampell & Rampell, P.A., is provided for your review.

I am proud to tell you we received an unmodified or 'clean' audit opinion with no recommendations to improve financial management from the auditors. As you read the draft audit, I suggest you pay particular attention to the "Management's Discussion and Analysis" (pages 9-16), this section is prepared by the District and provides an overview of the financial activities of the District for the fiscal year ended September 30, 2015, with comparative information for the prior two years.

The following reports are prepared by the auditors and are required by either Auditing Standards or Florida Statutes. These reports describe what is required by the auditors and detail any findings and conclusions.

- Independent Auditor's Report (pages 5-6)
- Independent Auditor's Report on Internal Control over Financial Reporting and on Compliance and Other Matters Based on and Audit of Finance Statements Performed in Accordance with *Government Auditing Standards* (pages 37-38)
- Independent Accountant's Report on an Examination Conducted in Accordance with *AICPA Professional Standards*, Section 601, Regarding Compliance Requirements in Accordance with Chapter 10.550, Rules of the Auditor General (page 39)
- Management Letter in Accordance with the Rules of the Auditor General of the State of Florida (pages 43-44)

No formal Board action is requested this month regarding the audit. The audit firm, represented by Ms. Debbie Diaz and Ms. Julia D'Antonio, will present the draft audit at our Board meeting this month. Ms. Diaz will be prepared to discuss the draft audit and answer any questions you may have.

After your review with the auditors, they will make clarifications where appropriate and return to the March meeting with the Final Audit Report for Board acceptance.

Should you have any questions concerning the Annual Financial Report, please give me a call or feel free to call Ms. Diaz directly at (561) 655-5855.

The link to the audit report is: <http://loxahatcheeriver.org/docs/DraftAudit.pdf>

Stephen B. Rockoff
Board Member

Dr. Matt H. Rostock
Board Member

Gordon M. Boggie
Chairman

Harvey M. Silverman
Board Member

James D. Snyder
Board Member

Loxahatchee River District

Water Reclamation | Environmental Education | River Restoration

2500 Jupiter Park Drive, Jupiter, Florida 33458-8964

Telephone (561) 747-5700 • Fax (561) 747-9929 • www.loxahatcheeriver.org

D. Albrey Arrington, Ph.D., Executive Director



MEMORANDUM

TO: GOVERNING BOARD
FROM: D. ALBREY ARRINGTON, Ph.D. 
DATE: FEBRUARY 10, 2016
SUBJECT: HEALTH INSURANCE OPTIONS

This month, Dustin Kuehn from the Gehring Group will be at our Board Meeting to discuss Alternative Funding Arrangements for Health Insurance. Using the attached presentation, Mr. Kuehn will discuss three general categories of health insurance: fully-insured plans (what we have now), self-funded plans, and hybrid options. Mr. Kuehn will discuss pros and cons of each approach, present a few case studies of each, and answer any questions you may have.

We are not seeking any Board action this month. This is simply an information gathering opportunity, so that the Board may more fully understand our options as we consider a strategy for 2017. Of course, depending on the Board's interest, Mr. Kuehn will be prepared to discuss prudent next steps.

Please let me know if you have any questions, and I will answer them if I am able. Otherwise, you may contact Dustin Kuehn at 561-626-6797.

F:\Albrey\Board Memos\2016-Feb_Health-Insurance-Options.docx

Alternative Funding Arrangements

February 18th, 2016



Discussion Items

- The Funding Spectrum
- Fully Insured Plans
- Hybrid Funding Products
- Self Funding Arrangements
- Case Studies
- Next Steps

The Funding Spectrum

Lowest Risk

Lowest Return Potential

Highest Risk

Highest Return Potential

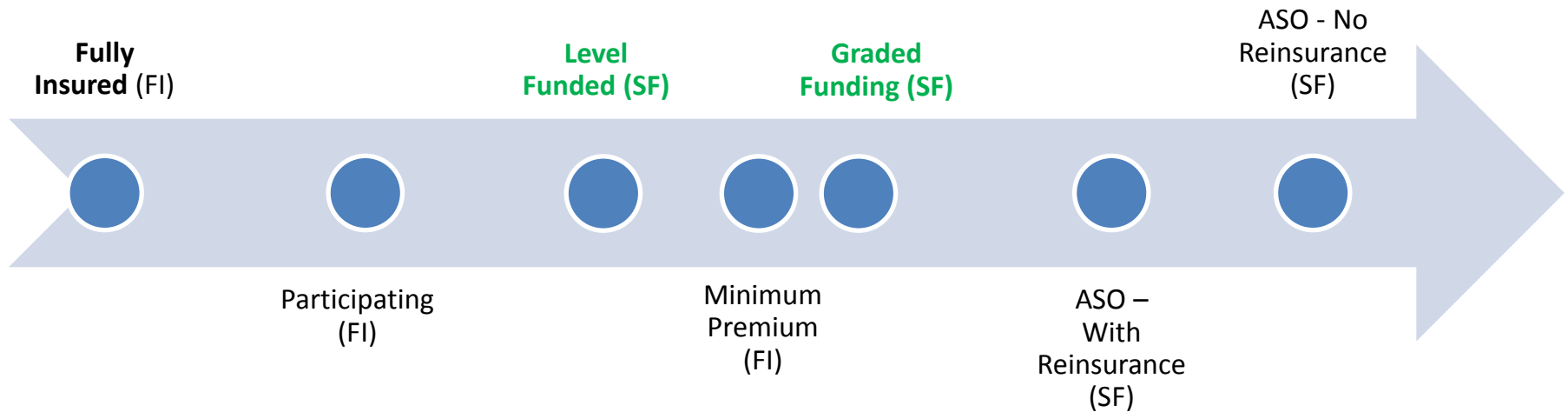

FI=Fully Insured in terms of ACA compliance. Carrier takes on ACA requirements, as necessary.
SF=Self Funded in terms of ACA Compliance. Plan sponsor takes on ACA requirements. E.g. PCORI, TRF, etc.

What Funding Options Are Available

- **Fully Insured**
 - Premiums Paid to Insurance Company
 - “Winner Take All”
 - Gains or losses stay with Insurance Carrier (assume liability)
 - Plan design aligned by state, no flexibility

What Carriers Offer Fully Insured?	All Carriers
How Are Costs Determined?	Standard Underwriting (Manual Claims + Creditable Claims)
What are potential pitfalls to be worried about?	“Buying Business”, Manual Experience, Unjustified Renewals, minimal transparency

What Funding Options Are Available

Fully Insured Monthly Premiums Include:

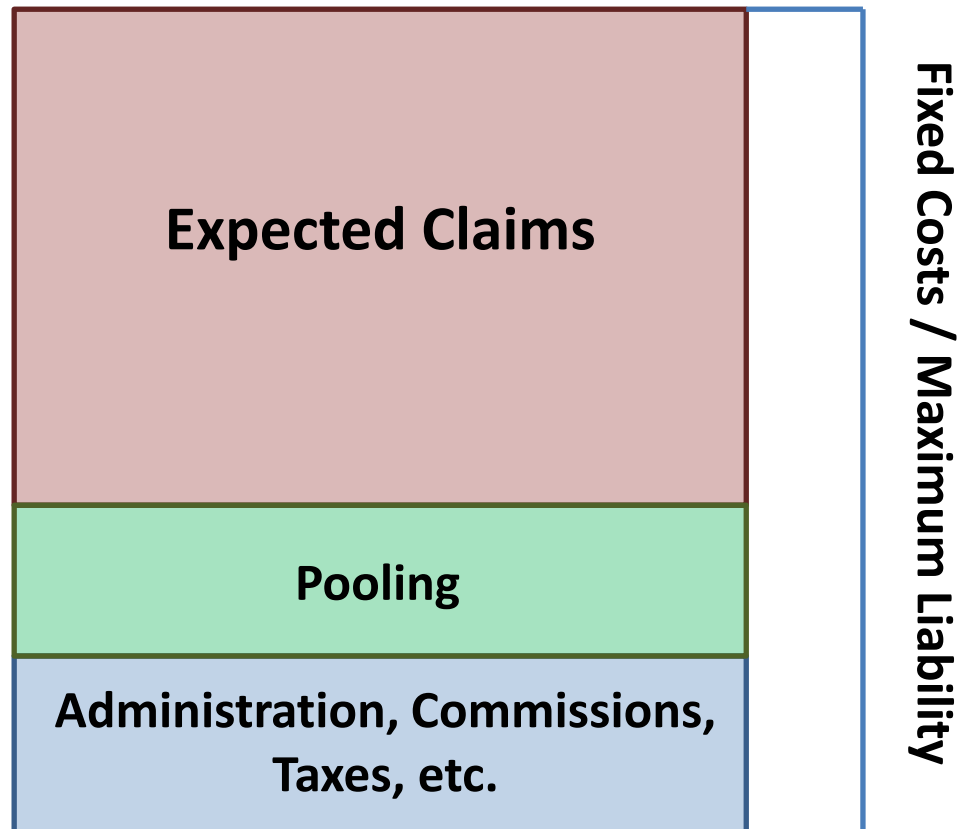

What Funding Options Are Available

- **Participating Contracts**

- Premiums Paid to Insurance Company
- Full Insured Contract
- Formula applied at end of year – “surplus” provided to group

What Carriers Offer Participating?	Florida Blue – “ProShare”(75+) Cigna – “Shared Returns” (100+) United Healthcare
How Are Costs Determined?	Standard Underwriting plus a margin
What are potential pitfalls to be worried about?	Fully insured concerns plus renewal terms e.g. requirement to renew.

What Funding Options Are Available

- **Level Funding –**

- Level premiums paid to carrier each month
- Fixed Costs and Claims pre-paid to insurance company
- Formula applied at end of year (month 15) – “surplus” credit provided to group if they renew (33% / 50% / 66% / 100%)
- Flexibility to design customized benefit plan

What Carriers Offer Level Funding?	Cigna, Aetna, Humana, UHC
How Are Costs Determined?	Standard Underwriting plus a margin/claims corridor
What are potential pitfalls to be worried about?	Renewal terms, billing, Individual Questionnaires needed under 100 employees, PPACA fees, banking (EFT)

What Funding Options Are Available

Level Funding Monthly Premiums Include:

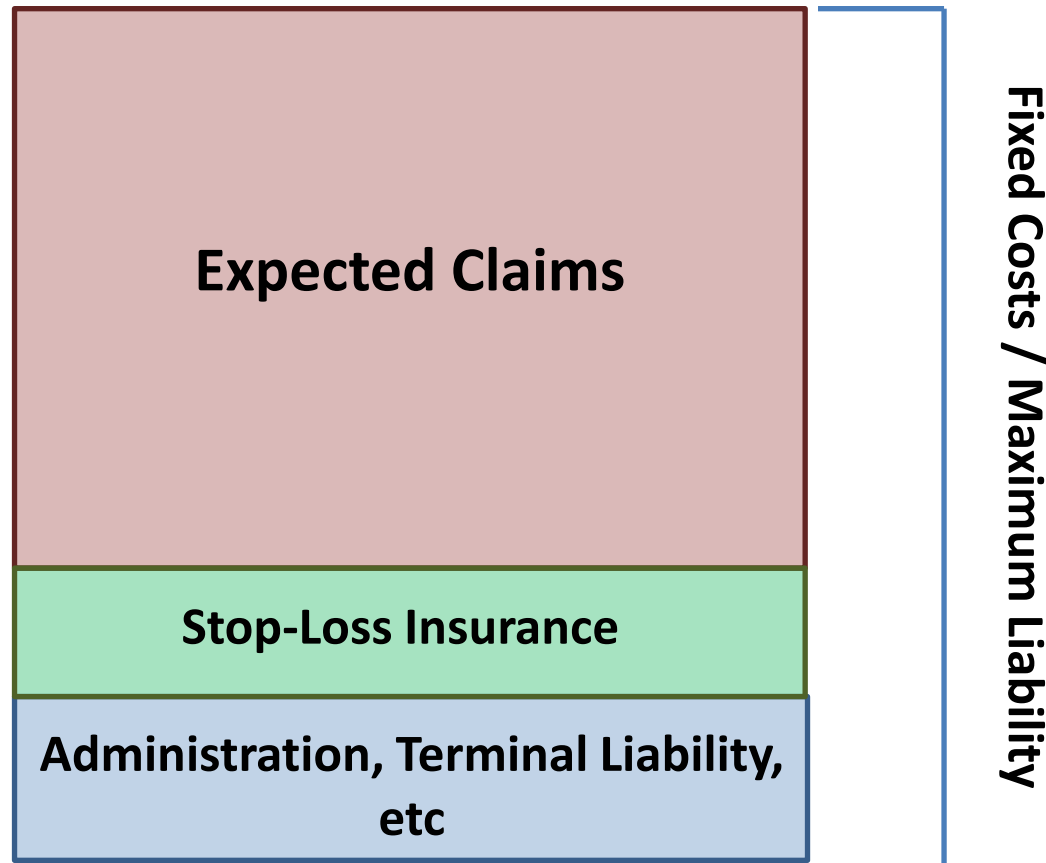

What Funding Options Are Available

- **Graded Funding–**
 - Fixed Costs paid to insurance company
 - Claims paid on a monthly frequency
 - Monthly costs will fluctuate
 - Costs will never exceed monthly or annual maximum and may be lower

What Carriers Offer Min. Premium?	Cigna (<250 EE's)
How Are Costs Determined?	Standard Underwriting plus a corridor
What are potential pitfalls to be worried about?	Banking, Fluctuations in monthly payments, Deficit Carryover, terminal liability

What Funding Options Are Available

Graded Funded Monthly Costs Include:

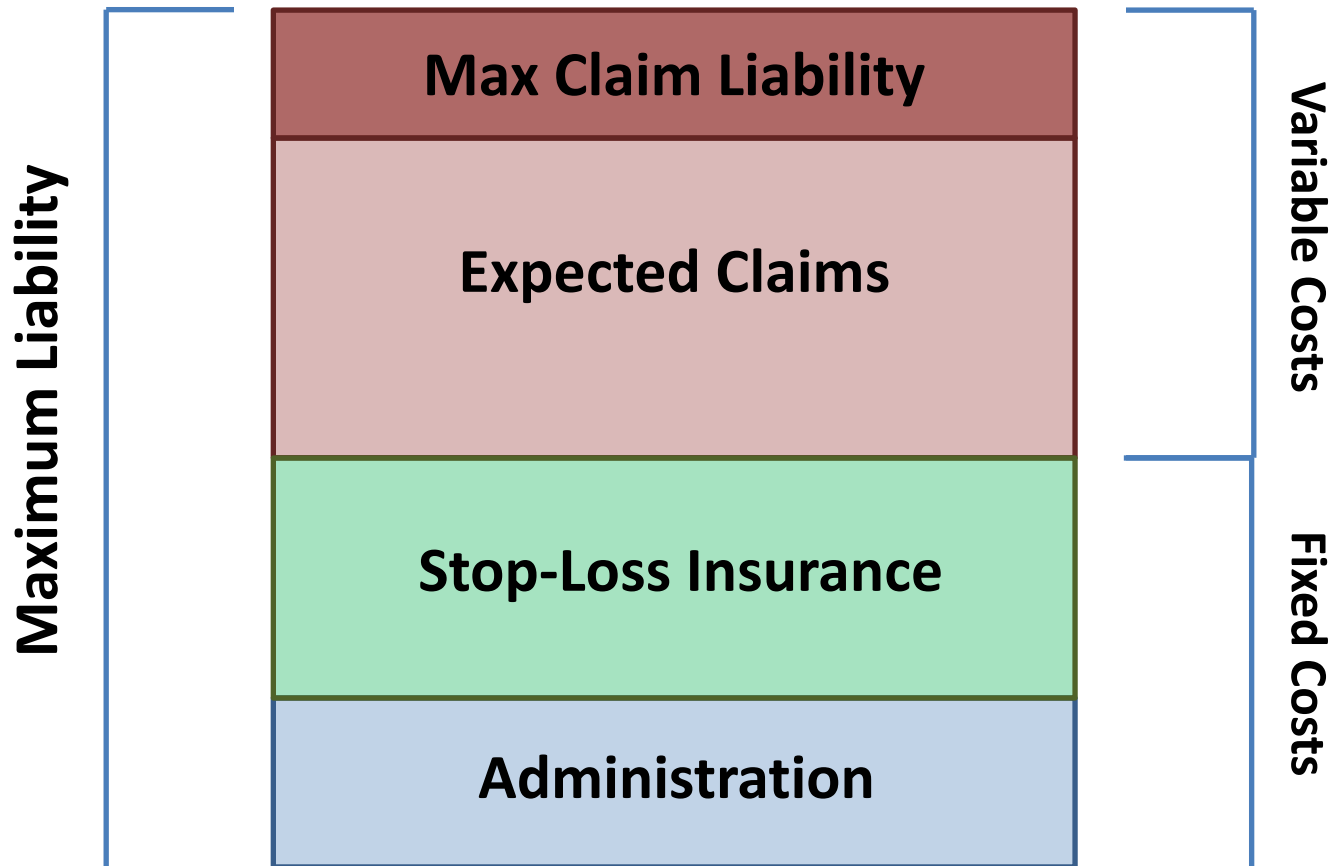

Advantages/Disadvantages of Self Funding

Advantages

- Flexibility in plan design
- Additional cash flow (employer holds reserves in stabilization account)
- Retention – administration costs less expensive
- Not responsible for HCR Health Insurer Fee
- Elimination of “Margin”
- Provides highest level of Return on Investment when offering a clinic

Disadvantages

- Employer assumes risk between the anticipated claims and stop loss coverage levels
- Reserve requirements specific to public sector entities (112.08)
- Actuarial Fees (112.08)
- Increased employer administration (finance & benefits staff)
- Employer assumes responsibility for reporting & payment of HCR Reinsurance and PCORI fees
- If leave TPA or stop loss carrier:
 - “Run out” claims
 - Additional TPA cost to process run out claims

Summary of Products by Carrier

- **Mid-Market Offerings (50-300 employees)**

	Fully Insured	Level Funding	Self Funding
Florida Blue	X		
Cigna	X	X	X (Graded Funded)
United Healthcare	X	X	
Aetna	X	X	
Humana	X	X	X (100+)

Individual Questionnaires are required to be completed by all eligible employees

Case Studies:

	# of EE's	Carrier	Funding Type	Funding Transition Date	FI Renewal offer before switch	Alternative Funding Rate Inc.	Avg. Renewal Inc / Yr	2015 Deficit / Surplus
1	28	CIGNA	Level Funded	1/1/14	12.18%	0.70%	10.5% inc	Deficit
2	33	CIGNA	Level Funded	Prior to 2010	N/A	N/A	9.88% inc	\$100k refund
3	57	CIGNA	Level Funded	10/1/11	N/A	0%	11.88% inc	Deficit
4	89	CIGNA	Graded Funded	10/1/15	27.16%	27%	N/A	N/A
5	112	CIGNA	Graded Funded	10/1/15	28.3%	10.5%	13%	\$98k surplus
6	137	CIGNA	Level Funded	10/1/12	17.3%	4.5%	3.97%	\$7k Deficit

Case Study: Level Funded

Cost Comparison and Loss Ratios

Date	Total Plan Funding	Fixed Costs (Stop Loss Prem & ASO fees)	Actual Paid Claims (Net of ISL)	Total	Reserve Accumulation	Total EE's	Claims / EE / Month
October-14	\$161,125	\$39,460	\$171,294	\$210,753	(\$49,628)	135	\$1,268.84
November-14	\$159,410	\$39,039	\$155,509	\$194,548	(\$35,139)	135	\$1,151.92
December-14	\$158,797	\$39,039	\$135,324	\$174,363	(\$15,566)	134	\$1,009.88
January-15	\$161,738	\$39,760	\$114,568	\$154,328	\$7,410	136	\$842.41
February-15	\$160,512	\$39,610	\$142,320	\$181,929	(\$21,417)	134	\$1,062.09
March-15	\$159,992	\$39,182	\$110,464	\$149,646	\$10,346	135	\$818.25
April-15	\$161,830	\$39,632	\$116,063	\$155,695	\$6,134	138	\$841.04
May-15	\$162,381	\$39,917	\$126,770	\$166,687	(\$4,306)	138	\$918.62
June-15	\$161,768	\$39,617	\$82,242	\$121,859	\$39,909	137	\$600.31
July-15	\$157,082	\$38,469	\$156,055	\$194,524	(\$37,443)	133	\$1,173.35
August-15	\$155,366	\$38,049	\$76,148	\$114,197	\$41,169	133	\$572.54
September-15	\$157,143	\$38,484	\$66,799	\$105,283	\$51,860	135	\$494.81
Annual Total	\$1,917,142.47	\$470,259.28	\$1,453,554.47	\$1,923,813.75	-\$6,671.28	1623	\$895.60

Individual Stop-Loss Benefits Received		\$354,061.36
Terminal Fund on Account with Cigna		\$154,356.00

* Total Paid Claims only include claims up to the stop loss limit.

Case Study: Graded Funded

Cost Comparison and Loss Ratios

Plan Totals	PLAN FUNDING								
	Plan Funding	Administration Fees	Stop Loss Fees	Total Paid Claims*	Admin Terminal Liability	Stop Loss Terminal Liability	Claims Terminal Liability	Total Plan Cost	Reserve Accumulation
October-14	\$72,394.10	\$1,253.35	\$4,826.63	\$23,653.36	\$3,758.18	\$14,495.68	\$36,045.38	\$84,032.58	(\$11,638.48)
November-14	\$72,980.72	\$2,526.13	\$9,731.47	\$47,813.86	\$2,526.02	\$9,747.31	\$24,224.41	\$96,569.20	(\$23,588.48)
December-14	\$74,153.96	\$5,133.39	\$19,791.72	\$41,070.89	\$0.00	\$0.00	\$0.00	\$65,996.00	\$8,157.96
January-15	\$72,394.10	\$5,011.53	\$19,322.31	\$64,627.23	\$0.00	\$0.00	\$0.00	\$88,961.07	(\$16,566.97)
February-15	\$74,153.96	\$5,133.39	\$19,791.72	\$35,441.33	\$0.00	\$0.00	\$0.00	\$60,366.44	\$13,787.52
March-15	\$71,220.86	\$4,930.29	\$19,009.37	\$33,351.70	\$0.00	\$0.00	\$0.00	\$57,291.36	\$13,929.50
April-15	\$71,807.48	\$4,970.91	\$19,165.84	\$23,096.64	\$0.00	\$0.00	\$0.00	\$47,233.39	\$24,574.09
May-15	\$72,394.10	\$5,011.53	\$19,322.31	\$21,163.26	\$0.00	\$0.00	\$0.00	\$45,497.10	\$26,897.00
June-15	\$74,382.52	\$5,148.81	\$19,856.84	\$23,981.33	\$0.00	\$0.00	\$0.00	\$48,986.98	\$25,395.54
July-15	\$74,382.52	\$5,148.81	\$19,856.84	\$48,170.99	\$0.00	\$0.00	\$0.00	\$73,176.64	\$1,205.88
August-15	\$73,209.28	\$5,067.57	\$19,543.90	\$26,584.33	\$0.00	\$0.00	\$0.00	\$51,195.80	\$22,013.48
September-15	\$71,449.42	\$4,945.71	\$19,074.49	\$26,347.40	\$0.00	\$0.00	\$0.00	\$50,367.60	\$21,081.82
Annual Total	\$874,923.02	\$54,281.42	\$209,293.44	\$415,302.32	\$6,284.20	\$24,242.99	\$60,269.79	\$769,674.16	\$105,248.86
PCORI FEE (\$2.08 PMPY)									(\$287.04)
REINSURANCE FEE (\$63 PMPY- 2014) (\$44 PMPY- 2015)									(\$6,727.50)
Reserve Accumulation									\$98,234.32

Estimated Terminal Liability (Claims & Admin) \$ 90,797

Specific Stop-Loss Benefits YTD \$ 572,615

* Total Paid Claims only include claims up to the stop loss limit.

This document is subject to copyright and may not be transmitted or reproduced without express written permission from Gehring Group.

Considerations

- Risk Tolerance
- Financial / Banking Concerns
- Transparency (Claims Experience & Plan Utilization)
- Large Claim Activity
- Wellness / Clinics

Timeline of Expectations

Scenario #1: Waiting for Renewal before RFP

<u>DATE:</u>	<u>ACTION:</u>
8/01/2016 (TBD)	Pre-Renewal Strategy Meeting
9/30/2016	Census Requested from District
10/03/2016	Renewal received by Gehring Group
10/05– 10/20/2016	Individual Questionnaires completed by Employees
10/20/2016	Board Meeting – Discuss Renewal Offer
10/21/2016	RFP released to the market (If necessary)
11/4/2016	RFP responses due at Gehring Group
11/7-11/10/2016	RFP Responses evaluated by Gehring Group
11/11/2016 (TBD)	RFP review of RFP analysis with LRD Staff
11/14/2016	RFP analysis packet provided to Board Members
11/17/2016	Board Meeting – Approve Carrier Recommendation
11/21 - 11/30/2016	Prepare Open Enrollment Materials
December 2016	Open Enrollment Meetings
1/01/2017	Plan Year begins

Scenario #2: Automatic RFP before Renewal

<u>DATE:</u>	<u>ACTION:</u>
8/01/2016 (TBD)	Pre-Renewal Strategy Meeting
8/30/2016	Census Requested from District
8/30 – 9/13/2016	Individual Questionnaires Completed by employees
9/14/2016	RFP released to the market
10/5/2016	RFP / Renewal responses due at Gehring Group
10/6-10/13/2016	RFP Responses evaluated by Gehring Group
10/14/2016 (TBD)	Initial review of RFP analysis with LRD Staff
10/20/2016	Board Meeting – Review Initial RFP responses
10/28/2016	Best and Final Offers (BAFO) Due at Gehring Group
11/04/2016	BAFO Responses reviewed with LRD Staff
11/14/2016	RFP analysis packet provided to Board Members
11/17/2016	Board Meeting – Approve Carrier Recommendation
11/18 - 11/30/2016	Prepare Open Enrollment Materials
December 2016	Open Enrollment Meetings
1/01/2017	Plan Year begins

Loxahatchee River District

Water Reclamation | Environmental Education | River Restoration

2500 Jupiter Park Drive, Jupiter, Florida 33458-8964

Telephone (561) 747-5700 • Fax (561) 747-9929 • www.loxahatcheeriver.org



D. Albrey Arrington, Ph.D., Executive Director

MEMORANDUM

TO: GOVERNING BOARD
 FROM: D. ALBREY ARRINGTON, Ph.D.
 DATE: FEBRUARY 12, 2016
 SUBJECT: PROPOSED REVISION OF RULE 31-10 RATES, FEES, CHARGES

This is the time of year we discuss our annual rate study. Through the Rate Study process, your staff looks forward to working with you to maintain both our sound financial position and quality customer service through implementation of a reasonable rate structure.

The annual Rate Study Model is a spreadsheet model that we use to assess the long-term fiscal position of LRD. The model uses an annual time step and includes terms for expected development within our service area (i.e., customer growth), and the model has explicit terms for operational and capital revenues and expenses. The Rate Study model provides useful estimates of future budgetary conditions. This year, the Model is based on the following general assumptions:

1. **Revenue from Quarterly Service Charges** – is projected to increase at a rate of 3% to 8% for the next several years based on adopted District Rule 31-10 scheduled rate increases and growth within the customer base. The figure on the right shows growth in residential equivalent connections is increasing as the economy recovers. Once the remaining developable land is consumed (within 5 years), this pattern is anticipated to abruptly decline. However, significant re-development projects (e.g., Love Street, Suni Sands, and etc) or a systematic effort to sewer the remainder of the District could extend this pattern for several additional years.

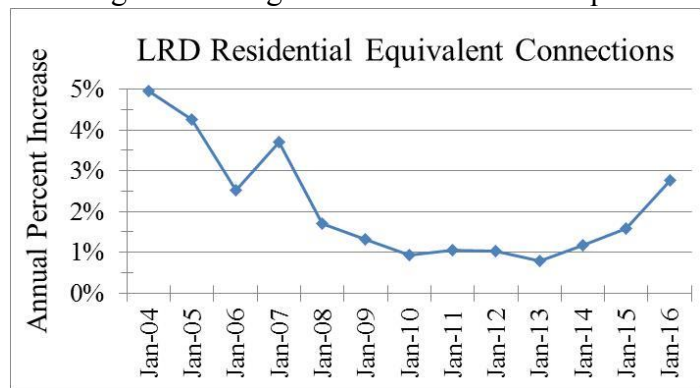

2. **Revenue from New Development (Plant and Line Charges)** – is anticipated to remain relatively flat for the next five years based on the rate at which new developer agreements are executed (see chart below).

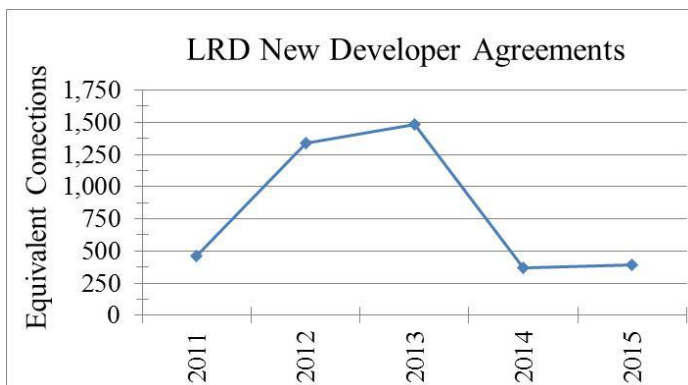

While the rate of new residential connections is increasing (see chart above), many of these new connections are derived from developer agreements that were executed in 2012 and 2013 or before. In fact, new developer agreements in 2015 only accounted for 390 equivalent connections. While developer agreements may spike again, once the remaining developable land is developed or preserved Plant Charge revenues are expected to abruptly decline.

3. **Revenue from Neighborhood Sewering Assessments** – Significant neighborhood sewerage projects have been ongoing for over 20 years, so we are starting to experience a decline in assessment revenues. For example, based on completed sewerage projects FY2016 projected sewer assessment payments equal \$1,326,717. This amount declines to \$ 762,127 in 2023 and \$56,460 in 2035. Repayment of the Jupiter Inlet Colony sewer assessment is projected to occur as a lump sum payment of approximately \$4,200,000 at the end of FY2017.
4. Service Availability Standby (SAS) revenues are projected to continue a slow, gradual decline, which has been occurring as our service area is nearing built-out conditions.
5. Revenue from the sale of IQ water will increase proportionate to CCI (Construction Cost Index) per our existing contracts. CCI is projected to increase about 2.5% per year.
6. Grant revenues are expected to increase based on anticipated legislative priorities; however, neighborhood sewerage grant funds merely offset homeowner’s connection fees.
7. Investments are expected to earn an interest rate of 1% through 2016 and 2% in 2017 and beyond, though deflationary pressures may be emerging in the market.
8. **Operating Expenses** – are projected to increase by 4.5% per year, which is less than the U.S. Department of Labor Statistics’ Water and Sewerage Maintenance Index (WSMI). For the period FY2006 through FY2015 LRD’s actual operating expenses increased by an average 4.4% per year, while the Water and Sewerage Maintenance Index for the same period increased by an average 5.7%. More recently, for the period FY2011 through FY2015 LRD’s operating expenses increased by an average 4.1% per year (WSMI was 5.2%). Staff continue working to improve efficiencies and expect to outperform the WSMI.
9. **I.Q. Expenses** – Beginning in 2020, I.Q. operating expenses could be increased by approximately \$750,000 if we have to pay market rate for Seacoast’s I.Q. water once the Seacoast/MacArthur Agreement expires (expiration date is April, 2020). Staff are actively exploring alternative water supply projects and other options by which this volume of water could be acquired on a long-term basis.
10. **Neighborhood Sewering Expenses** – Neighborhood sewerage programs are ongoing with construction of the Jupiter Inlet Colony Neighborhood Rehabilitation project beginning in April, 2016 and lasting approximately 16 months. This project will rehabilitate potable water system and stormwater system, and install new sanitary sewers in the community at a cost of approximately \$9.3 million. The sewer assessment for this project is projected to be \$4.2 million. Otherwise, the rate study assumes neighborhood sewerage will continue at an annual cost of approximately \$1 million per year through 2019 (i.e., completing Turtle Creek, Imperial Woods, Whispering Trails, and other scheduled areas). At some point in the next 12 to 24 months, it will be beneficial for the Governing Board to convene a workshop to discuss potential strategies to improve water quality throughout the remainder of the District. Such decisions/directions could have far reaching effects on the District’s finances.
11. **Capital Collection & Transmission System Expenses** – include construction of a new emergency bypass system for the wastewater force main that crosses the Loxahatchee River adjacent to the railroad bridge (\$450k). This force main is the single point by which nearly all the wastewater from north of the river flows under the river on its journey to our wastewater treatment facility. The force main is particularly critical, and it is nearing the end of its useful life. So, a full replacement of this force main is anticipated to occur in FY 2018 at a cost of approximately \$1 million. A new force main to connect Jupiter Farms Elementary is planned pending grant funding. Significant improvements to remote monitoring of wastewater pumping stations are also planned.
12. **Renewal & Replacement Collection & Transmission System Expenses** – Over the next 5 years approximately \$1.5 million is budgeted for condition assessment and renewal and replacement of

existing collection and transmission system features. We have budgeted \$450k to upgrade lift station 82 (US1 & Indiantown Rd), our last ‘can’ station, to a submersible pump station.

13. **Capital Treatment & Disposal System Expenses** – \$850k per year over the next 5 years is projected to provide new features/components within our wastewater treatment facility. These features include installation of a new press in the biosolids building, installation of aeration basin covers, moderate upgrades to odor control facilities, and improved remote (electronic) monitoring throughout the facility.
14. **Renewal & Replacement Treatment & Disposal System Expenses** – Replacement of our traveling bridge filters with deep bed sand filters is budgeted at \$8.5 million (\$2.5 million less than projected in last year’s rate study). Additional work anticipated in the rate study includes systematic rehabilitation of key components throughout the wastewater treatment facility (e.g., electrical, pumps, blowers, etc) as these systems age.
15. In the Rate Study Model we continue to ‘set aside’ \$250,000 per year towards the construction of a new deep well, or alternatively an Aquifer Storage and Recovery (ASR) well that could temporarily store unused reclaimed water during the wet season and recover some portion of it during the dry season. While this money remains in our enterprise account, the Year End Total Cash from the Rate Study does not include the funds ‘set aside’ for the Deep Well. The Deep Well funds accumulate in the New Deep Well \$ Available column of the Rate Study.
16. **Bonds** – All of our bond debt has been retired, and no additional bond is projected at this time.
17. Minimum cash balance should remain \geq restricted cash + 4 months operating budget.

Given the various assumptions in the Model, the chart below shows our projected year end available cash through 2022. Actual values are shown for the period 2013 through 2015. Budgeted values are shown for 2016, and model projections are shown through 2022. Of course, the further into the future we look the greater our uncertainty. It is quite interesting to compare this year’s projections to last year’s projections (i.e., 2015 Rate Study thin dotted line). The blue line with filled diamond symbols (%: 0,3,3,3,3) represents no rate increase this year followed by 3% rate increases in following years. This line also closely approximates the effect of a significant slowdown in development if we maintain our rate increases as generally projected. In all cases, we are projecting a strong financial position.

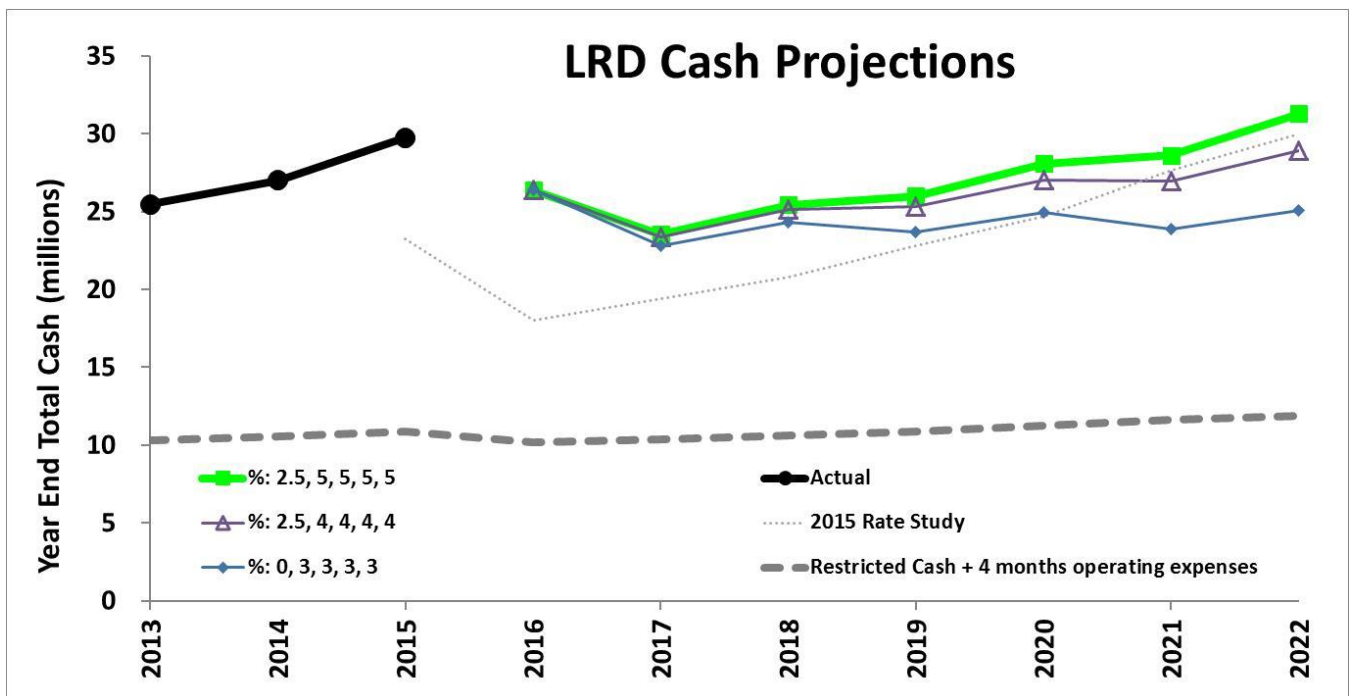

Looking forward, we continue to maintain our projected annual operating expense at 4.5% per year. This is a significant improvement over the Water and Sewerage Maintenance Index (as discussed above), and we expect to move this to 4% or below as we work on internal efficiencies. Nonetheless, external factors (like negotiating the Seacoast IQ Contract renewal) could significantly impact this number.

Presently, Chapter 31-10 includes 5% annual rate increases for the years 2016 through 2019. Given the assumptions in the Rate Study model and results of the model, I believe we can lower the 2016 rate increase from 5% to 2.5% or even 0% (because of lower than expected cost for the deep bed filters and the delays we have experienced in JIC sewerage). Furthermore, I believe we can lower the predicted annual rate increases for future years from 5% to 4.5%. Of course, as future uncertainties are better understood we will have the opportunity to incrementally adjust our rates as needed.

Your staff takes pride in providing excellent service to our rate payers. We understand your desire to operate as efficiently as possible, but we also recognize the expectation to provide award-winning service. I believe our planned rate increases attempt to balance these competing demands, and provide for the increasing costs of treating and recycling wastewater in the face of increasing regulations and expenses.

Staff looks forward to discussing the rate study with you, and answering any questions you may have. No action is necessary this month, but we will need to take action at your March meeting.

Thank you, and please feel free to call Clint or me if you have any questions.

Loxahatchee River District

Water Reclamation | Environmental Education | River Restoration

2500 Jupiter Park Drive, Jupiter, Florida 33458

Telephone (561) 747-5700 • Fax (561) 747-9929 • www.loxahatcheeriver.org



D. Albrey Arrington, Ph.D., Executive Director

MEMORANDUM

TO: Albrey Arrington, Ph.D., Executive Director

FROM: Bud Howard, Director of Information Services

DATE: February 11, 2016

SUBJECT: Board Discussion of Policy Updates for Customer Service

As part of our forthcoming updates to our Rule 31-10 for Rates, Fees and Charges we seek the Governing Board's guidance on several policy and procedural issues as it relates to managing our customers' accounts.

The Customer Service Department is in the process of implementing a series of efficiency improvements that will: 1) enable us to be more responsive to our customers, 2) significantly reduce the amount of time the District and Attorney's staff spend managing delinquent accounts; and 3) provide consistency and clarity on how we manage delinquent accounts. Additional policy discussion is requested for managing credit card transaction costs. Below we summarize several items for the Board's discussion.

To review, the District bills our sewer customers quarterly (January, April, July, and October). We typically mail the bills the first week of the quarter and they are due roughly one and a half months later, near the midpoint of the quarter. Past Due notices are sent two weeks later (at the two month mark) and are due the week prior to the end of the quarter. Customers that have not paid prior to the next quarterly bill receive a second quarter regular bill showing a past due balance. After the customer is two full quarters behind (the 3rd quarter billing) we send a letter indicating the account is seriously past due. At the 4th quarter of delinquency we send a letter indicating we will forward their account to our attorney for lien processing. At the 5th quarter we send a letter indicating the account information has been sent to the attorney's office for lien processing. There are inconsistencies in the timing of perfecting liens because of a backlog. Approximate counts are:

	Total Active Customers	30,500	% of Active Customers
Print Bills	28,000		91.8 %
Email Bills	5,500		18.0 %
Past Due Print Bills	3,800		12.5%
Past Due Email Bills	700		2.2%
Seriously Past Due Letters	300		1.0 %
Final Notice Letter	80		0.3 %
Accounts presently at Attorney for Lien processing/mgmt.	500		1.6 %

Stephen B. Rockoff
Board Member

Dr. Matt H. Rostock
Board Member

Gordon M. Boggie
Chairman

Harvey M. Silverman
Board Member

James D. Snyder
Board Member

Late and Delinquent Charges. Late fees incentivize customers to pay their bills on time and reduce the time and costs associated with managing past due accounts. We seek the Board's guidance regarding a nominal Late Fee (ex. \$5.00 or a small percentage) to encourage our customers to pay on the Due Date, and a Delinquent Fee (ex. \$25.00 or appropriate percentage) to further incentivize our customers to pay their bill by the end of the quarter. These charges could apply to each quarter's bills. These charges are similar to other utilities (ex. Town of Jupiter).

Lien Processing. Historically, the District has been lenient in processing delinquent accounts. We believe that clear and consistent communication to our customers regarding the process and timeline to perfect a lien could reduce numbers of accounts that get to lien status. Further, improvements to data processing can free up staff time to research accounts that have changed ownership – the most common reason for non-payment. We seek the Board's guidance regarding an acceptable timeline for lien processing delinquent accounts (ex. 9 or 12 months).

Last Chance Payments Plan. For those customers making a good faith effort to satisfy their delinquent charges, we seek the Board's guidance on a payments option where the customer can pay delinquent fees over a fixed amount of time before we send the account for lien processing. The payments plan would require payments each month.

Standardized Attorney Charges. Computing past due charges, fees and interest in our billing software, rather than by the attorneys office, will significantly reduce the workload of District and Attorney's office staff. We believe we can further improve efficiency and clarity to our customers by having standardized lien processing fees by our Attorney's office. For example, the Attorney's fee to file the initial lien is \$xxx and the cost of annual lien amendment is \$xxx. Our Attorney's office is supportive of this approach with a fee schedule to be approved by the District.

Credit Card Convenience Fee or Payment Limit. Increasing numbers of our customers are paying by credit card over the phone or through our web page. We are now able to process those payments very efficiently which frees our Customer Service staff to spend their valuable time on other important tasks. However, credit card processing and interchange fees are meaningful - averaging 2.7 to 3% of the transaction. For the more than 91% of our customers with bills less than \$100, the *cost per transaction* versus the *efficiency of processing that transaction* is strongly in the District's favor. However, for those few large credit card payments, the transaction costs become significant and are not efficient for the District. The District's attorney is researching our options for applying convenience fee to recover some of the costs associated with higher dollar credit card payments. If permitted by law, we seek the Board's guidance regarding convenience charges (ex. 2.5% or 2.8%) for credit card payments over a specified amount (ex. \$1,000 or \$5,000); or limiting the amount that the customers can pay by credit card. Note that only 1.5% (~450) of our customers pay more than \$1,000, and 0.2% (~65) pay more than \$5,000.

We look forward to receiving the Board's guidance on these important policy and/or procedure decisions for possible inclusion into our amendments to Rule 31-10.

Loxahatchee River District

Water Reclamation | Environmental Education | River Restoration

2500 Jupiter Park Drive, Jupiter, Florida 33458-8964

Telephone (561) 747-5700 • Fax (561) 747-9929 • www.loxahatcheeriver.org



D. Albrey Arrington, Ph.D., Executive Director

MEMORANDUM

TO: GOVERNING BOARD
FROM: D. ALBREY ARRINGTON, Ph.D.
DATE: FEBRUARY 12, 2016
SUBJECT: PROCUREMENT POLICY

The most significant draft revisions to the policy regard improving/clarifying the process by which change orders are handled and approved.

This item is not yet ripe for discussion with the Governing Board. Staff hope to have this item fully ready for discussion next month.

F:\Albrey\Board Memos\2016-Feb_Procurement-Policy.docx

LOXAHATCHEE RIVER DISTRICT

Neighborhood Sewering Schedule



Rank *	Area Description	# Lots	Activity	Target Date
6	Jupiter Inlet Colony	240	Notified Owners – August, 2010 Notice of Intent – February, 2013 Interlocal Agreement Complete - April, 2014 Engineering Contract Awarded– Sept., 2014 Construction Contract Award – Nov., 2015	2013
9	Little Oaks/River Oaks	73	Notified Owners – September, 2011 Notice of Intent to Assess – April, 2014 Permitting – April, 2015 Construction Started – August, 2015 Substantial Completion – January, 2016	2015
10	Turtle Creek Phase I	29	Notified Owners – September 2012 Engineering Study Complete – May, 2015 Phase I Design – November, 2015 Notice of Intent – February, 2016	2016
10	Turtle Creek Subsystem 3	52	Notified Owners – September 2012 Engineering Study Complete – May, 2015 Notice of Intent – February, 2016	2016
10	Turtle Creek Subsystem 2	TBD balance 56 lots	Notified Owners – September 2012 Engineering Study Complete – May, 2015	2016
10	Turtle Creek Subsystem 1	TBD balance 56 lots	Notified Owners – September 2012 Engineering Study Complete – May, 2015	2016
11	Jupiter Farms (East)	708		TBD
11	PB Country Estates	1547		TBD
14	Whispering Trails	181	Notified Owners – January 2013	2017
16	Limestone Creek Road-West	82	Notified Owners – January 2013	2018
19	US Coast Guard Station Offices <i>(institutional)</i> PX Commercial <i>(commercial)</i> Residences <i>(residential)</i>	2 ECs 2 ECs 10	US Government - private roads Albrey- mtg. w/BLM & Historical 3-2011 Prelim design prepared In House 4-2011	2019
20	New Palm Beach Heights	34	Notified Owners – January, 2016	2019
22	Bridgewater	70		2019
	UN-RANKED (not in priority order)			
	Jupiter Farms <i>(commercial)</i> RV Park	72.5 ECs	By Agreement Developer Project Permitted–February, 2015	2011
	PBC Riverbend Park <i>(institutional)</i>	12 ECs	Construction complete Notified of sewer availability Costs paid, plans reviewed	2011

* Rank based upon “2010 Septic System Inventory & Assessment”

Remnant Areas

Rank	Area Description	Lots	Activity	Target
A	North A-1-A	3	Postponed -Town Activities in area	2012
C	FDOT Turnpike Station <i>(institutional)</i>	2 ECs	Owner notified FDOT budget request submittal April, 2011 Design in Process – In House All Easements obtained	2012
D	Loggerhead Park <i>(institutional)</i>	6 ECs	Obtaining Easements from Town of Jupiter	2014
F	Rolling Green Road	25	Notified Owners – March, 2012 Notice of Intent – March, 2015 Notified to Connect – December, 2015 Final Assessment-February, 2016	2015
F	815 S. US 1 (Yum Yum Tree)	9 ECs	Notified Owners – November, 2014	2016
G	Hibiscus Ave, Juno	10	Notified Owners – June, 2013 Design in Process - 2015	2016
G	Olympus Dr., Juno (LP)	3	Notified Owners – June, 2013	2016
G	Ocean Dr., Juno (LP)	6	Notified Owners – June, 2013	2016
G	Riverside Dr. Remnants	4	Notified Owners – February, 2014 Design Complete – February, 2016	2016
G	3831 Beacon Hill Rd	1	Notified Owner – January, 2015 Notice of Intent – January, 2016 Design in Process – January, 2016	2016
G	10828 Whispering Pines Trl-MC	1	Notified Owners – October 2012 Notice of Intent – January, 2016 Design in Process – January, 2016	2016
G	Hyland Terr Properties Services-MC	9	Notified Owners – October 2012 Notice of Intent – January, 2016 Design in Process – January, 2016	2016
G	SE Linden St-MC	8	Notified Owners – October 2012 Notice of Intent – January, 2016 Design in Process – January, 2016	2016
G	SE Pine Grove St-MC	8	Notified Owners – October 2012 Notice of Intent – January, 2016 Design in Process – January, 2016	2016
G	SE Harken Terr Ph I	7	Notified Owners – October 2012 Notice of Intent – January, 2016 Design in Process – January, 2016	2016
G	SE Harken Terr Services	2	Notified Owners – October 2012 Notice of Intent – January, 2016 Design in Process – January, 2016	2016
H	SE Harken Terr Ph II	2	Notified Owners – December 2015	2017
H	Lenmore Drive	6	Notified Owners – October, 2014	2017
H	US 1, Juno Beach <i>(commercial)</i>	2	Notified Owners – January, 2014	2017
H	Shay Place, Tequesta	11	Notified Owners – July, 2013	2017
H	County Line Road - Martin Co.	3	Notified Owners – July, 2013	2017
H	Tequesta Dr E	2	Notified Owners-March, 2015	2017
H	14100 US Hwy 1, Juno Beach	1	Notified Owners-March, 2015	2017
H	96 Pine Hill Trl E	1	Notified Owner – February, 2015	2018
I	8 th Street	3	Notified Owners – January, 2014	2018
I	Chippewa Street	6	Notified Owners – January, 2014	2018

* Rank based upon "2010 Septic System Inventory & Assessment"

** Revised Date

TBD = To be determined

Private Road Areas

Rank *	Area Description	# Lots	Activity	Target Date
AA	Peninsular Road	5	*Private Road Notice of Intent – February, 2010 Partial construction complete - June, 2013 Soliciting easements for remainder of project	2010
BB	Rivers Edge Road (Martin Co)	35	Notified Owners – August, 2010 Private Road - Design started Notice of Intent – February, 2014 Easements Solicited – May, 2014 Project Delayed	2013
CC	Clark Lane Phase II	3	*Private Road Owners notified June, 2012 Notice of Intent to Assess – June, 2015 Easement Obtained – February, 2016	2014
CC	171 st Street Martin Co.	7	*Private Road In House Design Owners notified October, 2012 Possible Coord. w/Water Co.	2014
CC	Jamaica Dr	11	*Private Road Owners notified Oct, 2012 In House Design started	2014
CC	197 th Place, 66 th Terrace, 66 th Way	21	Notified Owners – Aug, 2010 *Private Roads Notice of Intent to Assess – February, 2015	2014
DD	Taylor Road	38	Notified Owners – September, 2011 *Private Roads	2015
EE	Imperial Woods	47	Notified Owners – October, 2010 Withdrew Notification – Feb, 2011 Private HOA	2016
EE	Hyland Terr Ph II/E of River Ridge • Hobart St • Seminole Terr	18	Notified Owners – October 2012 Private Roads	2016
FF	Rolling Hills	51	Notified Owners – January 2013 Private HOA	2017
FF	Gardiner Lane	2	Notified Owners – July, 2013 Private Road	2017
HH	Harbor Rd. S. LPSS	6	Notified Owners – January 2014 Private Road	2017
GG	Rockinghorse (north of Roebuck Road)	10	Notified Owners – January 2013	2018
GG	Island Country Estates	47	Notified Owners – January 2013 Private HOA	2018
HH	SE Indian Hills	12	Notified Owners – January, 2016 Easement for Road & Utilities, No Dedication	2019

* Rank based upon "2010 Septic System Inventory & Assessment"

** Revised Date

TBD = To be determined



DESANTIS, GASKILL, SMITH & SHENKMAN, P.A.

CONRAD J. DESANTIS
Business & Real Estate
Also Admitted in Pennsylvania

TIMOTHY W. GASKILL
Business, Probate
Family Litigation

DONALD R. SMITH
Personal Injury & Wrongful Death
Commercial Litigation

CURTIS L. SHENKMAN
Board Certified
Real Estate Attorney

BROOKE A. GROGAN
Personal Injury & Litigation

ATTORNEYS & COUNSELORS AT LAW
ESTABLISHED 1973
11891 U.S. HIGHWAY ONE, SUITE 100
NORTH PALM BEACH, FLORIDA 33408
TELEPHONE (561) 622-2700 FACSIMILE (561) 622-2841
www.LawPalmBeach.com

February 5, 2016

LEGAL ASSISTANTS
CIVIL TRIAL, PROBATE
AND FAMILY LAW
KAREN M. B. LOPATOSKY
SENIOR PARALEGAL
MINDY VASSER, SECRETARY

PERSONAL INJURY
ROBIN B. MODLIN, CP
TERRI L. VLASSICK

REAL ESTATE

JUDY D. MONTEIRO
DENISE B. PAOLUCCI

ADMINISTRATOR

CURTIS L. SHENKMAN

Loxahatchee River Environmental Control District
D. Albrey Arrington, Exec. Dir. and Board Members
2500 Jupiter Park Drive
Jupiter, FL 33458

RE: PENDING LITIGATION STATUS REPORTS

Dear Board Members:

We are enclosing herewith a brief status report relating to all litigation in which the Loxahatchee River Environmental Control District is presently involved. This status report updates the last monthly status report previously submitted and consists of a summary of the record proceedings which have occurred in each of the pending cases since last month.

There are no analyses of the pending cases included, as the inclusion of such items might constitute a waiver of any attorney/client privilege that exists between our firm and the District. Therefore, if you would like to discuss the particulars of any specific case in more detail or would like to obtain more information concerning the strategy, status, or settlement posture of any of the individual cases, please feel free to contact me.

As always, we are available at any time to discuss any of these lawsuits with each individual Board Member by telephone or by conference, if there are any questions.

Respectfully submitted,

TIMOTHY W. GASKILL

/kmb

Attachments

cc: Curtis L. Shenkman, Esquire

OTHER LITIGATION

ACTION: In Re Estate of Israel Marquez et al ... Loxahatchee River Envir Control District
Owner: Estate of Israel Marquez **Property:** 911 Hawie St.
 Case No. 50-2010-CP-004006XXXXSBIY

TYPE OF ACTION: Mortgage Foreclosure by Lender, Encon named for its (possible) lien interest –

COMMENCEMENT: Service of Summons/Petition

COMMENTS: Action foreclosing mortgage– Encon named for lien interest

STATUS: Pending

11/24/14	District served with Petition re Homestead and Real Property as Estate Asset; Filed Answer and Affirmative Defenses; Hearing to be held
12/10/14-1/6/15	No change in status
2/3/15	No change in status
3/6/15-5/11/15	No change in status; monitoring probate action; monitoring for activity;
6/8/15-7/9/15	No change in status
8/7/15 – 10/12/15	No change in status, continuing to monitor probate
11/10/15	There is a pending Motion to sell real estate set for hearing in December, continue to monitor
12/7/15	No change in status
1/18/16 – 2/5/16	No change in status

LIEN FORECLOSURES

NONE

MORTGAGE FORECLOSURES / ENCON CROSSCLAIMS

ACTION: Habitat for Humanity of Palm Beach County Inc et al ...Loxahatchee River Envir Control District
Owner: CONOLIUS SHIVERS **Property:** 6868 Church Street
Case No. 50-2015-CA-010595 XXXXMBAW

TYPE OF ACTION: Mortgage Foreclosure by Lender, Encon named for its (possible) lien interest –

COMMENCEMENT: Service of Summons/Complaint upon District

COMMENTS: Action foreclosing mortgage– Encon named for lien interest

STATUS: Pending

11/10/15	Mortgage foreclosure action; District served with Complaint; Notice of Appearance; Notice of E-Mail Designation and service address filed; Improper Summons; Filed Answer, Affirmative Defenses and Counterclaim/Crossclaim
12/7/15	LRD's claims were paid in full as part of settlement of foreclosure action by Lender/Plaintiff; Satisfactions to be prepared and recorded for outstanding liens.
1/18/16	Paid in full for outstanding liens in settlement and Satisfactions and Voluntary Dismissal/Release of Lis Pendens to be filed upon receipt of Plaintiff's Notice of Dropping Party Defendant LRECD.
2/5/16	File to be closed upn receipt of Notice Dropping Party.

ACTION: West Coast Servicing Inc. v Guy-Wilson et al ... Loxahatchee River Envir Control District
Owner: JOHANNA GUY-WILSON **Property:** 6359-6 Riverwalk Ln
Case No. 50-2015-CA-014203 XXXXMBAW

TYPE OF ACTION: Mortgage Foreclosure by Lender, Encon named for its (possible) lien interest –

COMMENCEMENT: Service of Summons/Complaint upon District

COMMENTS: Action foreclosing mortgage– Encon named for lien interest

STATUS: Pending

2/5/16	Mortgage foreclosure action; District served with Complaint; Notice of Appearance; Notice of E-Mail Designation and service address filed; Answer, Affirmative Defenses and Counterclaim/Crossclaim/ filed; in process of serving defendants

MORTGAGE FORECLOSURES / ENCON CROSSCLAIMS (continued)

ACTION: Mortgage Solutions of Colorado, LLC v Osborne et al ...Loxahatchee River Envir Control District
Owner: JAMES CLAYTON OSBORNE, JR. **Property:** 6334 Ungerer St.
Case No. 50-2015-CA-014396 XXXXMBAW

TYPE OF ACTION: Mortgage Foreclosure by Lender, Encon named for its (possible) lien interest –

COMMENCEMENT: Service of Summons/Complaint upon District 1/19/16

COMMENTS: Action foreclosing mortgage– Encon named for lien interest

STATUS: Pending

2/5/16	Mortgage foreclosure action; District served with Complaint; Notice of Appearance; Notice of E-Mail Designation and service address filed; To file Answer/Counterclaim/Crossclaim

MEMORANDUM

TO: Albrej Arrington, Ph.D. / Loxahatchee River District

COPY: Clint Yerkes / Loxahatchee River District
Tom Vaughn / Loxahatchee River District
John Koroshec / Hazen and Sawyer
Felipe Martinez / Hazen and Sawyer

FROM: Albert Muniz / Hazen and Sawyer

DATE: February 11, 2016

FILE: 42009-012.3.1.3

SUBJECT: Loxahatchee River District
Engineer's Monthly Status Report through January 2016

The following is a summary of work performed by Hazen and Sawyer, P.C. (Hazen) on Loxahatchee River District (LRD) projects through the above referenced date.

General Operational Assistance – This project involves providing LRD with engineering assistance related to wastewater operations.

Monthly Progress

- LRD staff and Hazen personnel continue to communicate to discuss plant operations on an as needed basis. The wastewater treatment process continues to perform well
- Hazen continues to provide assistance on an as needed basis

Deep Bed Sand Filters – Final Design and Construction Management Services – The existing traveling bridge filters and filter structure have served the LRD wastewater treatment facility for over 20 years and are in need of significant rehabilitation and repair. In lieu of repair and replacement, it is the LRD staff's desire to replace the filters with deep bed sand filters. Deep bed filters offer additional benefits over traveling bridge filters including de-nitrification capabilities as well as proven performance during plant upset conditions. Design of the project is complete and the project has entered the construction phase.

Monthly Progress

- Bid opening occurred on October 29, 2015
- A letter recommending award to the lowest cost, qualified, responsive and responsible bidder (i.e., Kirlin Florida, Inc.) was prepared and submitted to LRD on November 4, 2015
- The Board approved the Kirlin contract at the November 19, 2015 Board Meeting
- Following Board approval, a Notice of Award letter and four sets of contract documents for execution of the contract was delivered to Kirlin on November 23, 2015
- Kirlin delivered signed contracts to the District on December 4, 2015, and subsequently reviewed

by the District attorney prior to execution by the District

- A pre-construction meeting was held on January 13, 2016 and Kirlin was issued a Notice to Proceed on January 18, 2016
- Kirlin is currently securing permits and preparing to mobilize on-site within the next few weeks
- Progress meetings are being held bi-monthly

Mechanical Integrity Testing for 2016 – Hazen was authorized to begin permitting for the 2016 standard 5-year Mechanical Integrity Test (MIT) as required by the injection well operating permit. Testing must be completed by May 31, 2016. Below is a summary of activities performed to date:

- Hazen submitted the MIT plan to FDEP on November 11, 2015
- FDEP reviewed the plan and approved it on November 13, 2015
- Hazen has finalized the technical specifications and will coordinate with LRD staff to determine if the project will be bid or piggy-backed with a publicly bid similar project in January 2016
- Hazen is obtaining a copy of recent low bids for conducting a MIT and will be sharing this information with LRD staff by end of February to finalize contracting. It appears that at least one favorable contract is available to piggy-back the MIT test

As always, please feel free to contact us should you have any questions or need to discuss the progress of any of the above projects in more detail.

**LOXAHATCHEE RIVER ENVIRONMENTAL CONTROL DISTRICT
ENGINEER'S MONTHLY STATUS REPORT THRU JANUARY 31, 2016**

JUPITER INLET COLONY NEIGHBORHOOD REHABILITATION PROJECT

- Completion of conformed documents for incorporation of contractor executed documents.
- Addressed comments from Palm Beach County Roadway on the off-site turn lane improvements.
- Held a meeting at the Colony to coordinate the on-site residential irrigation well testing required prior to construction.
- Attended the Colony Property Owners Association meeting with Albrey Arrington and gave the residents an update on the project and answered questions.
- Scheduled the pre-pre construction meeting with the contractor, Giannetti Contracting Corp., to occur on February 2, 2016.

ARCADIS, Inc.

Sira Prinyavivatkul, PE

Kimley-Horn and Associates, Inc.

Thomas C. Jensen, PE



HOLTZ CONSULTING ENGINEERS, INC.
50 South U.S. Highway One, Suite 206, Jupiter, FL 33477 (561) 575 2005

MEMORANDUM

To: Clint Yerkes, Deputy Director, Loxahatchee River Environmental Control District

From: Christine Miranda, PE
Holtz Consulting Engineers, Inc.

Date: February 11, 2016

Subject: **Loxahatchee River Environmental Control District Monthly Status Report**

The following is a summary of work performed by Holtz Consulting Engineers, Inc. (HCE) on Loxahatchee River District projects through February 11, 2016:

Loxahatchee River Road Reclaimed Water Main Replacement

- We are waiting for the Florida Department of Environmental Protection to issue the submerged land lease. This is the only outstanding permitting issue. Upon receipt of the submerged land lease the final plans and specifications will be submitted and the project will be advertised for bidding.

Jupiter Plantation Lift Station #13 Force Main Replacement

- The project was advertised for bidding on January 31, 2016.
- The pre-bid meeting is scheduled for February 17, 2016.
- Bids will be opened on March 3, 2016.

Maplewood Lift Station #21 Force Main Extension

- Upon receipt of issuance of the permit from Palm Beach County Engineering, the 100% design submittal will be submitted and the project will be advertised for bidding.

Turtle Creek Phase I

- The preliminary design analysis technical memorandum has been reviewed by LRD staff and comments were provided to HCE on February 8, 2016.
- The 30% design submittal and cost estimate for Subsystem 5 will be submitted to staff during the week of February 15, 2016.



*Loxahatchee River Environmental Control District
Monthly Status Report
February 10, 2016*

Submitted To: Clinton Yerkes, Deputy Director

The following is a summary of work performed by Mathews Consulting, Inc. (MC) on District projects through February 10, 2016.

Little Oaks / River Oaks Neighborhood Sewering

The Construction Contract was awarded to Foster Marine Contractors in the amount of \$1,548,615. NTP was issued to the Contractor on 7-20-15. The Substantial Completion date is anticipated to be 2-15-16 and the final completion date is anticipated to be 4-24-16. MC attended the monthly meeting, reviewed shop drawings, responded to RFI's, coordinated construction activities with the District, Contractor and PBC, and provided resident inspection services.

Alternate A1A Subaqueous Forcemain Study

A kick-off meeting was held with the District on 9-18-15. MC completed preparing the Base Drawings; conducted a field reconnaissance of the pipeline corridor on both sides of the bridge; completed photographic log walk-thru of the project; and completed Utility coordination. The District provided MC with the requested downstream pressure readings on 10-23-15. MC completed the hydraulic modeling task now that we have this information. MC continued development of the Draft Preliminary Design Report. A coordination meeting was held with the District on 1-27-16 to discuss the alternatives to rehab/replace the Alt. A1A subaqueous forcemain.

The Draft Temporary / Emergency Bypass Pumping Plan was submitted to the District for review on 1-13-16. The District provided MC comments on the Draft Temporary / Emergency Bypass Pumping Plan on 2-10-16. MC anticipates finalizing the Draft Study Report the week of 2-22-16.

Master Lift Station #1 Rehabilitation

MC completed the Preliminary Design Criteria to be incorporated into the Preliminary Design Report. MC prepared a Flow Analysis Technical Memorandum and submitted it to the District on 1-5-16 for review and comment. Final comments were received from the District on 2-3-16. MC is currently finalizing the Draft Preliminary Design Report.

Respectfully Submitted by:

MATHEWS CONSULTING, INC.

Rene L. Mathews, P.E.
President



Busch Wildlife Sanctuary

The 1st Quarter Report will be presented at the
April, 2016 Board Meeting.



Friends of the Loxahatchee River February 2016



River Center Summary Statistics

Year Month	General Visitors	Program Visitors	Outreach	Gift Shop	Donations	Memberships	Sponsors	Education Programs	River Center Programs	Special Events	Volunteer Hours
2015-01	1433	645	942	\$905	\$1,583	\$185	\$550	\$564	\$1,348	\$1,379	267
2015-02	1259	308	1313	\$1,360	\$987	\$200	\$532	\$130	\$3,025	\$2,872	215
2015-03	1695	219	274	\$1,451	\$1,003	\$365	\$3,500	\$100	\$5,390	\$9,647	358
2015-04	1326	518	150	\$1,600	\$1,023	\$250	\$1,400	\$1,818	\$6,770	\$1,561	130
2015-05	1138	358	183	\$944	\$643	\$210	\$2,950	\$49	\$5,179	\$1,599	81
2015-06	2078	1031	160	\$1,355	\$837	\$200	\$520	\$3,087	\$4,365	\$420	487
2015-07	1936	1294	46	\$1,985	\$524	\$50	\$650	\$5,073	\$1,490	\$377	645
2015-08	1544	305		\$1,432	\$691	\$75	\$1,460	\$732	\$215	\$892	404
2015-09	1047	278	34	\$771	\$491		\$520	\$60		\$160	116
2015-10	1055	549		\$872	\$636	\$25		\$128	\$128	\$626	139
2015-11	881	255	140	\$1,192	\$560	\$150	\$460		\$667	\$815	128
2015-12	1078	277	51	\$2,749	\$663	\$250	\$8,460	\$82	\$210	\$186	142
2016-01	1083	606		\$1,083	\$496	\$150	\$2,410	\$93	\$4,065	\$679	143

River Center

River Center staff participated in an Active Shooter Training class in January. Plans are to brainstorm and run training scenarios every six months. Also, the River Center hosted the Loxahatchee River Management Coordinating Council (LRMCC) and the Florida Association of Environmental Professionals (FAEP).

Friends of the Loxahatchee River

Friday, February 5, the River Center welcomed Benji Studt, the Environmental Program Supervisor from Palm Beach County's Department of Environmental Resources Management, as he presented a discussion entitled "Palm Beach County's Natural Areas: Healing the Land and Opportunities for Adventure." He discussed the restoration efforts that have occurred at our local natural areas and how they are ready to be explored by nature lovers. Over 70 guests attended this excellent lecture.



Special Programs

Loxahatchee by Night Campfire

The River Center continued with the "Loxahatchee by Night" Camp Fire season on Friday, January 8th. Over 40 participants of all ages joined River Center educators for a night of fun. Our January theme was "Take a Hike." In our Chiki Hut, Benji Studt of PBC Environmental Resource Management presented a fantastic talk about our local natural areas. Inside the center guests had the opportunity to create their own trail maps! Guests were invited to explore the exhibits inside the center, touch animals in the touch tank, and discover various plants and animals in the migratory bird and butterfly garden. The campfire

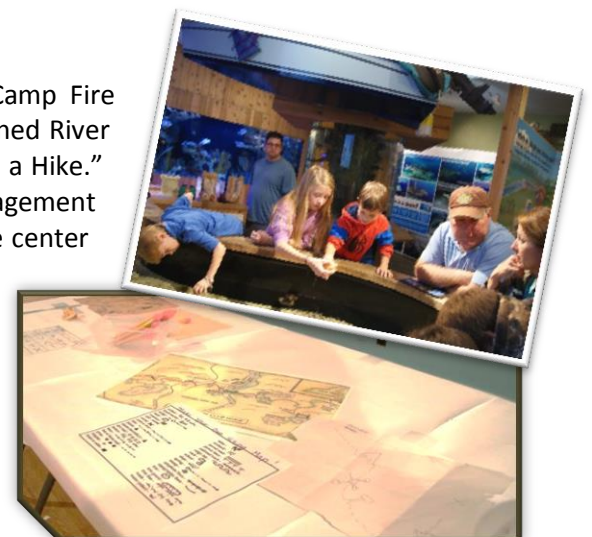

was roaring all night, as families roasted marshmallows and enjoyed delicious s'mores throughout the evening.

River Center's Adult Environmental Education Program: "Separating" Myth from Reality: Squid Dissection

On Thursday, January 21st the River Center hosted another Adult Environmental Education Series titled "Separating" Myth from Reality: Squid Dissection and the Family Cephalopod. Ancient Greek mariners told tales of a sea creature with giant tentacles called Scylla. Norseman warned of the Kraken, a fearsome ocean monster large enough to pull massive whaling ships deep beneath the waves. From Homer's epic poetry of 8th century BC, to Jules Verne's depiction in Twenty Thousand Leagues under the Sea in 1870, and even an appearance in the popular Pirates of the Caribbean



movie franchise in 2006, the legends persist. So what exactly is this creature that has terrified seafarers and captivated our imaginations? Thirteen participants had a chance to work together in teams, using proper dissection tools and techniques, to perform a scientific dissection of a squid. They also learned about the classification of squid, their anatomical characteristics, and their unique adaptations. We uncovered the reality behind one of our ocean's greatest mysteries.



Girl Scout Fishing Clinic

Ten Girl Scouts and six parents attended the clinic conducted at Burt Reynolds Park on Saturday, January 9th. The program began with a classroom session lasting about 45 minutes, discussing fishing regulations, knot tying, various forms of tackle, and fish identification. Before heading down to the water, we discussed the importance of safety while fishing, and considered potential hazards if these rules were neglected (i.e. holding the fishing pole vertical by your side, being aware of your surroundings when casting, and hooks). We had a successful day of fishing, with a variety of fish caught.



Project Learning Tree

On Saturday, January 30th Community Outreach Coordinator, Sara Duggan, and Environmental Education Manager Jocelyn O'Neill attended the Project Learning Tree training at Pine Jog Environmental Education Center. The training was conducted by Danielle Vande Zande, former River Center intern and now an environmental education specialist at Pine Jog. Project Learning Tree is an award-winning environmental education program designed for teachers and other non-formal educators, parents, and community leaders working with youth from preschool through grade 12. This particular style of teaching encourages students how to think, not what to think. The River Center plans to use the training and resources provided to enhance our environmental education programs.



Education Training: Project Flying WILD and Schoolyard WILD at MacArthur Beach State Park

River Center staff Sara Duggan and Megan Harris attended Project WILD training at John D. MacArthur Beach State Park on Monday, January 4th. Project WILD is one of the most widely-used conservation and environmental education programs among educators of students in kindergarten through high school. It is based on the premise that young people and educators have a vital interest in learning about our natural world. The workshop incorporated Project Flying WILD focusing on environmental education and birds and Schoolyard WILD creating classroom and schoolyard programs for the River Center's future education programs.

Special Dr. Seuss Story Time

On Thursday, January 21st the River Center hosted a special Dr. Seuss Story Time. Over 50 parents and young children came to celebrate all things Seuss. We read "If I Ran the Zoo" and "Green Eggs and Ham" and danced to silly Seuss songs. Afterwards children got a chance to get up close to touch tank animals that look like they are right out of the world of Dr. Seuss. Families were then invited to make Truffula trees, the Lorax mustaches, Thing 1s and Thing 2s, and create their very own creatures from their imagination.



Outreach Activities

Port Salerno Seafood Festival:

Environmental Education Coordinator Megan Harris participated in the Port Salerno Seafood Festival on Saturday January 30th, as an exhibitor showcasing the environmental education programs of the River Center. This event featured live music, arts & crafts, vendors, a kid's fun zone, and the very best seafood on the Treasure Coast. The River Center's booth saw over 350 visitors getting out information about the Loxahatchee River, the River Center, and upcoming programs and events.



Volunteer of the Month: The River Center's February Volunteer of the Month is awarded to Ken Stark. Ken came to the River Center in October 2015 and said "I would like to help wherever needed!" He has been volunteering every week since earning over 45 hours of service. Ken is our Mr. Fix It, visitor greeter, touch tank docent, and tank interpreter. He is always willing to help with a smile on his face and the River Center appreciates all of his hard work and dedication. We are honoring his continued service and thank him for being part of our River Center family!

Friends Membership – 73 active members; 3 new/renewals; 44 current sponsors

Annual Sponsors Recognition – **Morgan Procter, John & Carol Vispo, Ann Howard, Edward Butzin – Wolverine Ventures**

Shark Exhibit Sponsors – Peter & Elanie McCusker

Night on the Loxahatchee Sponsors – Cotleur - Hearing

Upcoming River Center Events – RSVP at rivercenter@lrecd.org or 561-743-7123.

February 20 – 10 a.m. Sharks for Families! A special program with arts and crafts, games, and information about sharks.

February 23 – “If You Build It, They Will Come” 3 p.m. – Special presentation given by Jupiter High School Environmental Academy senior, Josh Wenkert-Lane. As part of his senior project, Josh will provide information about both local and migrating birds, their needs and habitats, and ways that we can help and support them. Please come and support this budding environmental educator!

March 4 – 12pm: Friends of the Loxahatchee River. Join us for an adventurous look at sharks in anticipation of our new exhibit opening in March!

March 9 – 5:30 p.m.: hYPe of the North Palm Beach Chamber of Commerce – Young professionals of the area will mix and mingle at the River Center while enjoying our new shark exhibit.

March 15 – 9 a.m.: River Center Public Kayak Tour

March 17 – 10 a.m. and 1 p.m.: “Jupiter U” – new or “seasoned” residents of Jupiter venture from place to place learning about all that Jupiter has to offer. They will attend either a kayak trip (morning) or an Adult Education session (afternoon) at the River Center.

March 17 – 6 p.m.: Shark presentation to be given at PGA National.

April 2 – 7pm: Save the Date! Night on the Loxahatchee: Shipwrecked in Paradise annual fundraiser for the River Center. Presentations by shipwreck and pirate experts, food by Food Shack and imported wines.

SOCIETYDIARY

Place of Hope's work with kids ...

No. 1 AGAIN



Chatter
CAROL
SAUNDERS

Executive Director Charles Bender. "Our entire Place of Hope network can take credit for changing the lives of children in need and doing so in a manner of transparency, quality and excellence."

Place of Hope features several programs and locations, including Villages of Hope of Palm Beach Gardens, a smaller campus and extended foster care program for youth who age out of the system; Joann's Cottage of Palm Beach Gardens, a maternity home for young mothers and pregnant young women; Place of Hope at The Leighan and David Rinker Campus in Boca Raton; and new foster parent recruitment offices in Hobe Sound and Port St. Lucie.

Currently, Place of Hope at The Leighan and David Rinker in Boca Raton is home to foster children in The Genesis Cottage, and the Alumni Impact Girls' Cottage is home to young women who have aged out of care. In 2015, Place of Hope expanded beyond Palm Beach County into Martin, St. Lucie, Okeechobee and Indian River counties with its

model of family-style, community-centric programs and outreach.

Place of Hope is located in Palm Beach Gardens. For more information, call 561-775-7195 or visit online at www.placeofhope.com.

NIGHT ON THE LOXAHATCHEE TO BENEFIT THE RIVER CENTER

Night on the Loxahatchee, with a theme of "Shipwrecked in Paradise," the annual benefit for the River Center in Jupiter will be held Saturday, April 2 from 7 to 9:30 p.m.

The proceeds raised will help fund the outstanding environmental education programming the River Center offers to all ages throughout the year.

This highly anticipated event offers opportunities for socializing and learning more about one of the area's greatest natural resources, the Loxahatchee River.

Fascinating expert speakers, engaging storytellers, unique entertainment, silent auction items and raffles are also a hallmark of this event. The delicious fare from the legendary Food Shack always creates a buzz with its unique, gourmet spin on local culinary delights.

This year's "Shipwrecked in Paradise" theme will harken back to the days of paddle boats and early families in Jupiter accompanied

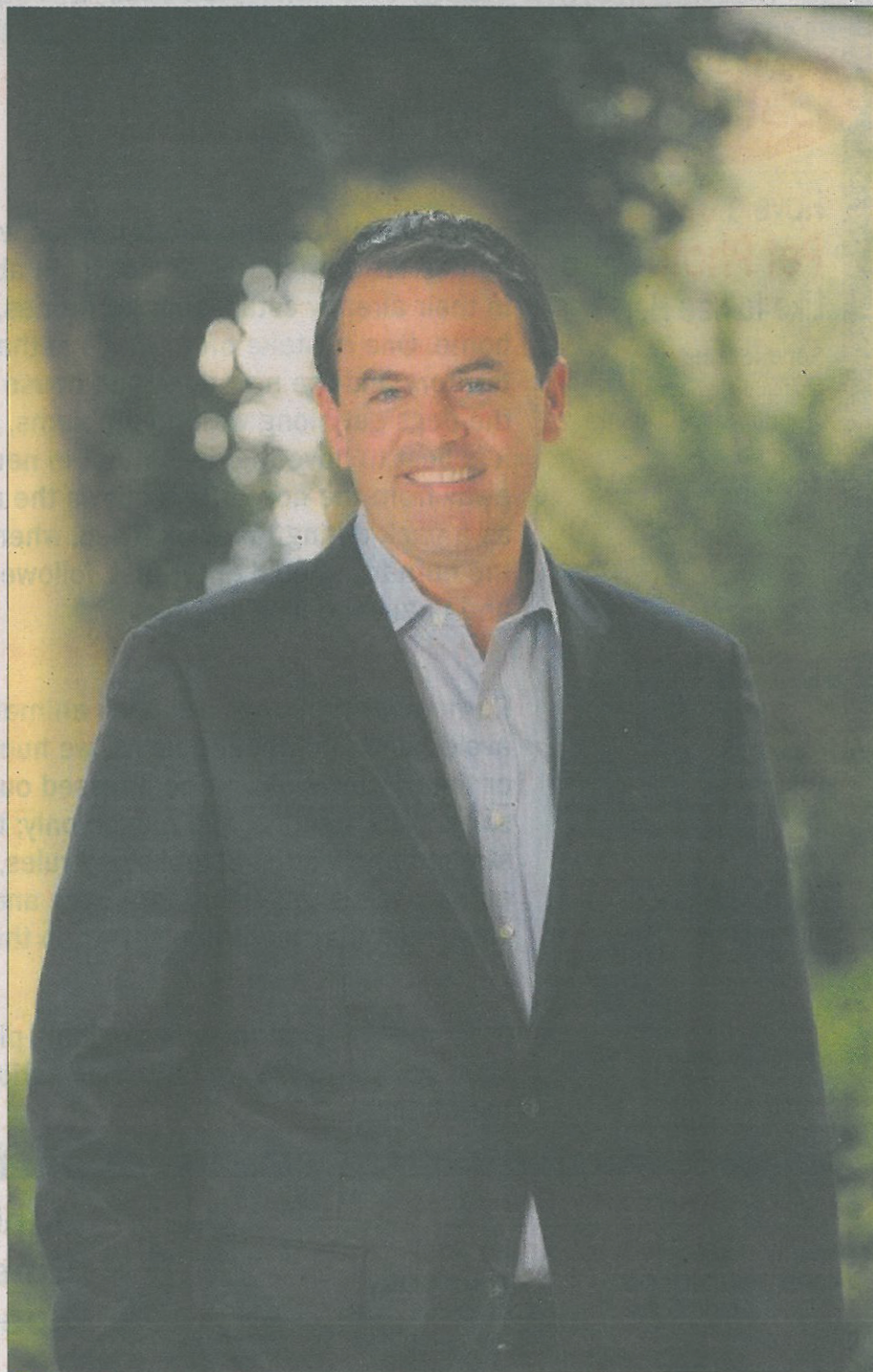

PROVIDED PHOTO

Place of Hope, one of Palm Beach County's largest children's organization, earned the highest ranking of excellence in 2015 for its work with youth from the nation's largest charity rating service, Charity Navigator. The award was presented to Executive Director Charles Bender, pictured, who said, "Our entire Place of Hope network can take credit for changing the lives of children in need and doing so in a manner of transparency, quality and excellence."

Place of Hope, one of the largest children's organizations in Palm Beach County, earned the highest ranking of excellence in 2015 for its work with youth from the nation's largest charity rating service Charity Navigator.

The year 2015 marks the second year in a row that Place of Hope has ranked highest in the category of "Youth Development, Shelter and Crisis Services" by Charity Navigator.

In 2014, Place of Hope's top ranking was featured in The Huffington Post as one of the charities that "changed the world."

According to Charity Navigator, "Only 9 percent of the charities rated have received at least four consecutive 4-star evaluations, indicating that Place of Hope outperforms most other charities in America. This 'exceptional' designation from Charity Navigator differentiates Place of Hope from its peers and demonstrates to the public it is worthy of their trust."

The confirmation, which was announced Dec. 23, of its second consecutive, first-place ranking came as wonderful news to the leadership of Place of Hope.

"We thank God and congratulate our family of donors, supporters, volunteers and staff as we all celebrate this momentous occasion and recognition for the nation's most highly regarded evaluator of nonprofit organizations," said Ex-

SOCIETY DIARY

HOPE from 6

by musical performers to help transport our visitors to another time.

As always, guests can count on a savory selection of hors d'oeuvres to enjoy at the event. The Food Shack Restaurant has created a "river inspired" menu and wines from African Tradition Wines and locally roasted gourmet coffee by Oceana Coffee will be served.

Tickets to Night on the Loxahatchee are \$60 per person with a \$10 discount for members of Friends of the Loxahatchee River. (Limit two tickets at discount rate per membership.) Tickets are \$70 after March 22.

For information about the event, sponsorship opportunities, the River Center, or to purchase tickets by phone, please call 561-743-7123 or click on www.loxahatcheeriver.org.

THE 79TH ANNUAL "SILVER SAILFISH DERBY" SET FOR JAN. 6-9

The West Palm Beach Fishing Club's 79th annual "Silver Sailfish Derby," headquar-



PROVIDED PHOTO

Steve Weagle, emcee at Night on the Loxahatchee, and Jocelyn O'Neill, environmental education manager of The River Center

Director's Report

- Admin. & Fiscal Report attach. #1
- Engineering Report attach. #2
- Operations Report attach. #3
- Information Services Report attach. #4
- Other Matters attach. #5

Loxahatchee River District

Water Reclamation | Environmental Education | River Restoration

2500 Jupiter Park Drive, Jupiter, Florida 33458-8964

Telephone (561) 747-5700 • Fax (561) 747-9929 • www.loxahatcheeriver.org

D. Albrey Arrington, Ph.D., Executive Director



Memorandum

To: Governing Board

From: Kara Peterson, Director of Finance and Administration

Date: February 12, 2016

Subject: Monthly Financial Report

Balances as of January 31, 2016

Certificates of Deposit:

Institution	Original Term	Maturity	Rate	Amount
FL Community Bank	9 Months	10/12/16	0.50%	\$ 2,033,139
Centerstate Bank of FL	1 Year	02/28/16	0.60%	2,075,440
FL Community Bank	1 Year	03/06/16	0.65%	2,010,925
TD Bank	6 Months	07/18/16	0.56%	2,000,338
FL Community Bank	18 Months	02/28/17	0.75%	2,025,893
FL Community Bank	18 Months	02/28/17	0.75%	2,025,893
TD Bank	3 Years	06/02/17	0.92%	2,030,925
TD Bank	3 Years	08/04/17	1.19%	1,017,951
TD Bank	4 Years	08/19/17	1.40%	2,069,888
TD Bank	2.5 Years	03/02/18	1.11%	2,009,262
TD Bank	3 Years	05/22/18	1.14%	2,015,985
TD Bank	5 Years	08/19/18	1.87%	2,093,875
TD Bank	5 Years	04/29/19	1.88%	1,550,470
TD Bank	5 Years	09/22/19	2.09%	2,057,684
Subtotal				\$ 27,017,668
Other:				
FL Community Bank - Public Demand			0.85%	\$ 3,534,140
SunTrust-Business Account			0.35%	2,691,870
Subtotal				\$ 6,226,010
Total				\$ 33,243,678

Average weighted rate of return on investments is: 1.00%

As of 01/31/16:

3 month Short Term Bond: 0.33%

1 month Federal Fund Rate: 0.50%

Cash position for January 2015 was \$27,434,173. Current Cash position is **up** by \$5,809,505.

Stephen B. Rockoff
Board Member

Dr. Matt H. Rostock
Board Member

Gordon M. Boggie
Chairman

Harvey M. Silverman
Board Member

James D. Snyder
Board Member

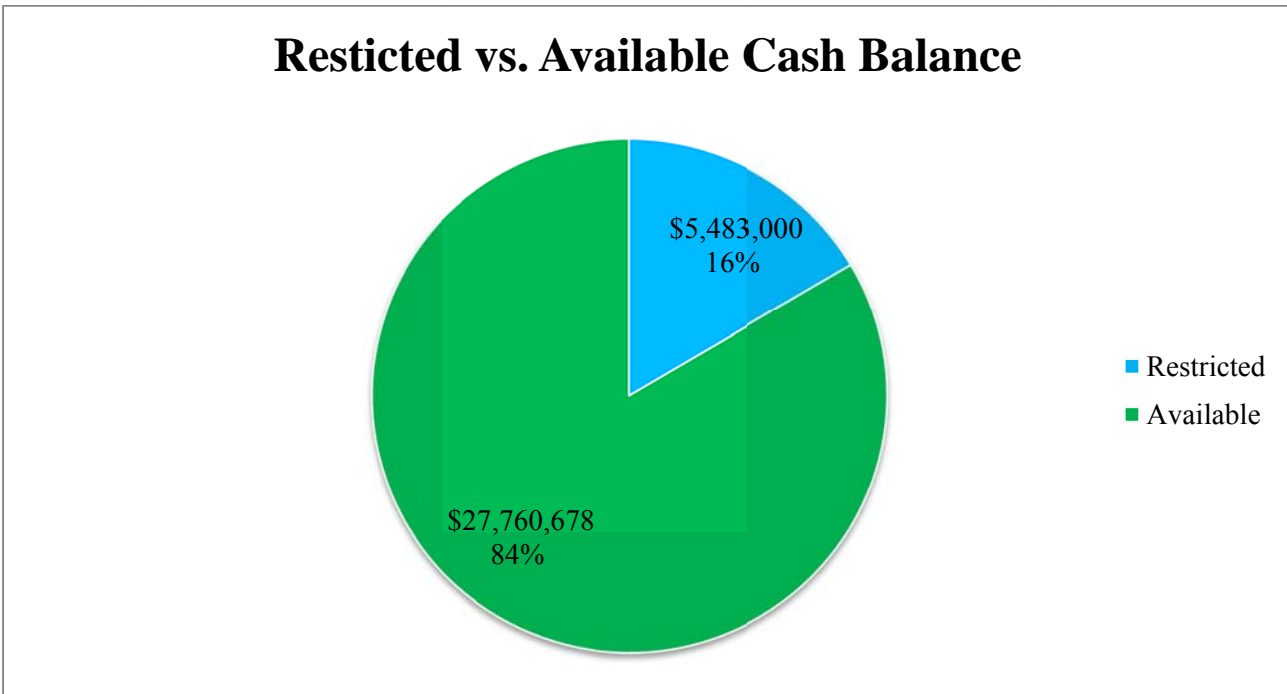
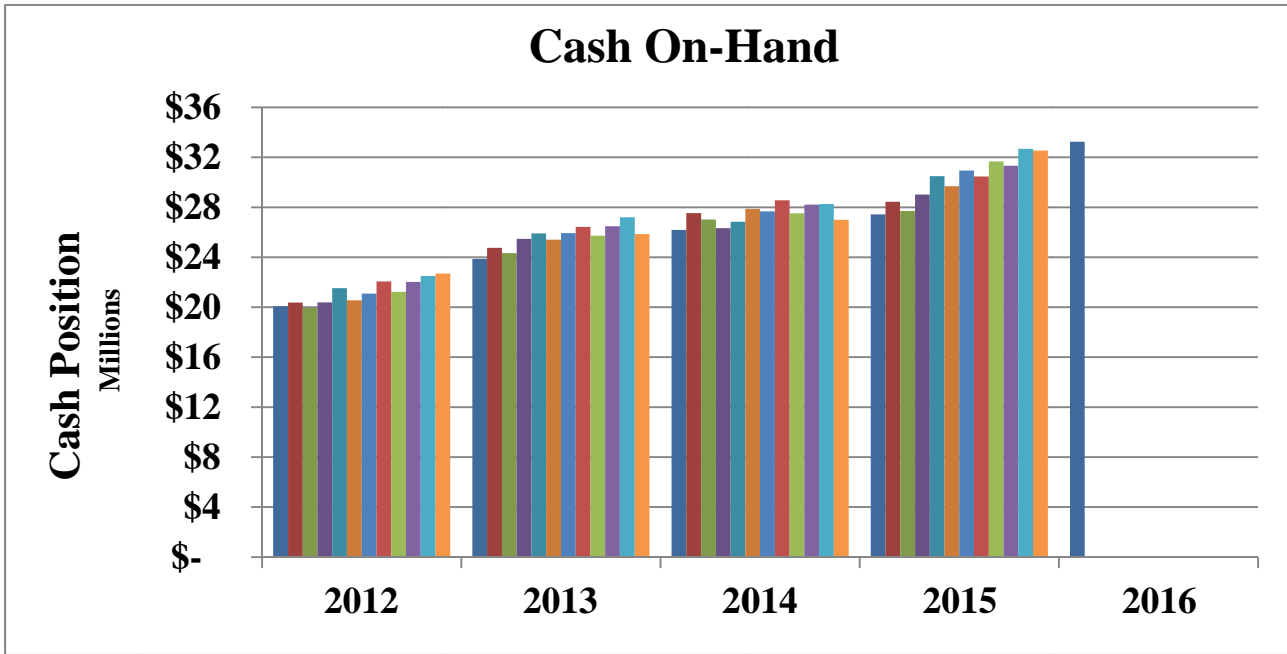

Accounting:

- Legal fees collected for the month of January were \$8,228. The fiscal year-to-date total is \$58,436.
- Septage billing for January was \$1,246. All septage dumping accounts are current.
- Developer’s Agreement – There were no new developer agreements in January.
- I.Q. Water Agreements – Dakota is past due for November and December and Indian Creek is past due for December.
- Estoppels – For January is \$5,400. The fiscal year-to-date total is \$23,100.
- Accounts in Bankruptcy – 19; Accounts in ‘Prior to Lien Process’ – 174; Lien – 58 Accounts; Attorney – 486 Accounts; Mortgage Foreclosure (active) – approximately 3 (there are 4 on attorney’s report: 1 has paid).

LRD Accounts Falling Behind

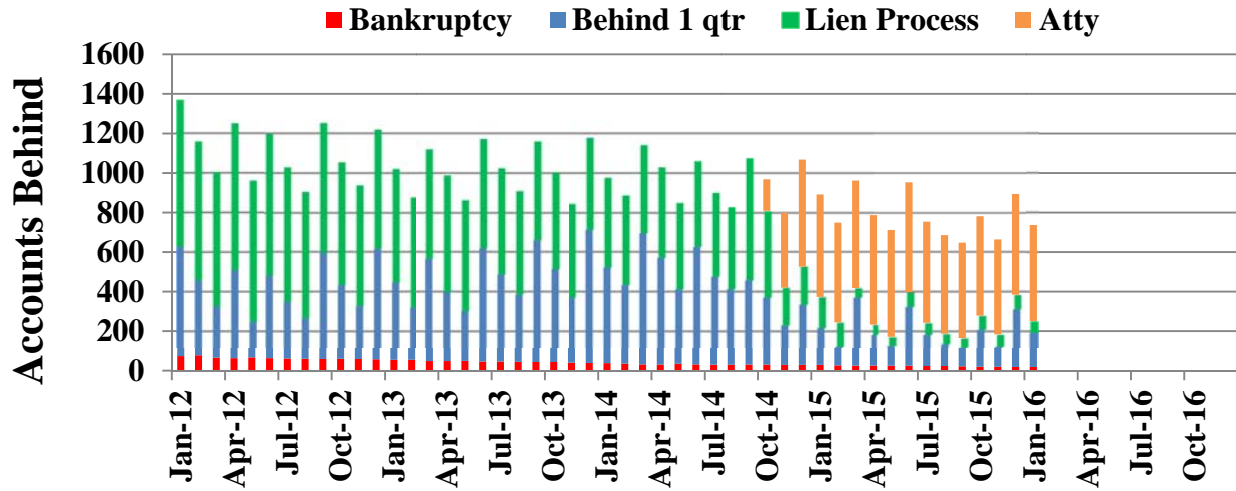

Loxahatchee River District

Water Reclamation | Environmental Education | River Restoration

2500 Jupiter Park Drive, Jupiter, Florida 33458

Telephone (561) 747-5700 • Fax (561) 747-9929 • www.loxahatcheeriver.org



D. Albrey Arrington, Ph.D., Executive Director

MEMORANDUM

TO: D. Albrey Arrington, Ph.D.
Executive Director

FROM: Kris Dean, P.E.
Director of Engineering Services

DATE: February 10, 2016

SUBJECT: Director's Report - Engineering Division
February 2016 Board Meeting

Developer Projects

Staff were active on 9 Developer projects including the following activities.

Construction: Staff performed construction inspections, shop drawing review, RFI responses and/or attended preconstruction meetings for the following projects.

Sonoma Isles Residential Phase 1 & 2: This project provides a gravity collection system and lift station to serve approximately 275 residential units and club facilities. This project was formerly known as Lakewood and Parcel 19.

Jonathan Dickenson State Park: This project provides modifications to the River Campground for bath houses. This system is private, however staff will perform inspections to ensure compliance with District standards.

Final Completion: Staff performed final completion activities to include final inspections, record drawings review and punch lists.

Sonoma Isles Commercial: This project provides a gravity collection system to serve the new commercial development at Sonoma Isles (fka Lakewood).

Jupiter Country Club Pod D (Phase 1): This project provides the first phase of the gravity sewer system to serve 40 residential lots in Jupiter Country Club.

Stephen B. Rockoff
Board Member

Dr. Matt H. Rostock
Board Member

Gordon M. Boggie
Chairman

Harvey M. Silverman
Board Member

James D. Snyder
Board Member

Capital Projects

Staff were active on 15 Capital projects including the following activities.

Design/Bid: Staff are currently in the design or bidding phase for the following projects.

Lift Station Rehabilitations for 2016: This project bid on January 12, 2016.

Merritt Way Low Pressure Service Upgrades: Staff are scheduled to begin construction of this project in March and should complete the project in April.

County Line Rd: Staff are working on the design for low pressure sewer systems to serve various residences on Harken Terrace, Whispering Pines Trail, Linden Street, Pine Grove Street and County Line Rd as part of the Neighborhood Septic Tank Conversion to Sewering Program (See Tabs 5C, D, E, F, G and H).

Hibiscus Avenue: Staff are working on the gravity sewer design.

Lift Station # 6 Rehabilitation: Staff have obtained the necessary easements and are beginning design to provide better access to the station.

Consultant Projects:

Master Lift Station Rehabilitation Preliminary Engineering Report: Staff coordinated with the consultant for flow analysis. This project looks at the final phase of rehabilitation for the Master Lift Station located just east of Pennock Ln and Indiantown Rd. The project will include pump replacement, electrical system evaluation, piping modifications, bypass facilities, isolation valves and coatings.

Alternate A1A Subaqueous Crossing Preliminary Engineering Report: The consultant submitted a draft bypass plan and met with staff to review options. This project looks at the replacement options and emergency bypass pumping plan for the 24" wastewater force main crossing the Loxahatchee River at Alternate A1A.

Loxahatchee River Road IQ Main Replacement: The consultant is working with ACOE for permitting. This project replaces the existing aerial crossing just north of the Eagles Nest development with a subaqueous directional drill.

Jupiter Inlet Colony Neighborhood Rehabilitation: This project provides a gravity collection system and lift station to serve the approximate 240 homes and town facilities located in Jupiter Inlet Colony. Construction is anticipated to begin in April 2016.

Little Oaks/River Oaks Gravity Collection System: Staff coordinated with the engineering consultant, attended progress meetings and provided periodic site inspections for progress, construction materials and dewatering sampling for this project that installs a gravity collection system and lift station to serve a combined 73 lots in the Little Oaks and River Oaks developments off of Roebuck Road.

Maplewood Drive Force Main: Staff performed plan, specification and permit reviews for this project that installs a new back up force main from LS 21 to the force main in Indian Creek

Parkway. This project is currently out to bid.

Jupiter Plantation Force Main Replacement: Staff performed plan, specification and permit reviews for this project that replaces the existing force main from LS 13 in Jupiter Plantation to the gravity collection system in Center St. This project is currently in permitting with PBC Land Development

Construction: Staff provided construction inspection and engineering oversight for the following projects.

Cleaning, TV Inspection and Lining Services: The contractor is scheduled to begin TV Inspection of the gravity collection systems for Lift Stations 57, 58, 62, 65, 66, 68, 94 and 97 this month.

Other Utility Projects

These projects include plan review, coordination and inspections associated with other utilities such as the Town of Jupiter, Village of Tequesta, Town of Juno Beach, Palm Beach County and Martin Co.

Jupiter Park Drive (Beacon St. and surrounding area): this is a Town of Jupiter right of way improvement project that installs sidewalks along portions of Jupiter Park Drive. Staff are coordinating with the Town to avoid existing force mains in the right of way.

Donald Ross Rd Improvements: A road way improvement project between I-95 and Military on Donald Ross.

Pine Gardens South: A Town of Jupiter project that provides storm system upgrades in the Pine Gardens South development.

Construction

Staff were involved in various projects including the following activities.

Jupiter North (Town of Jupiter): Staff are working to raise and repair buried and/or damaged cleanouts identified during investigations/locations for the Town of Jupiter.

Lift Stations 57, 58, 62, 65, 66, 68, 94 and 97: Staff are systematically working in these areas to locate or install right of way clean outs in coordination with upcoming TV inspections.

Signed,

Kris Dean, P.E.
Director of Engineering Services

/KD

M:\ENGINEER\MONTHLY REPORTS\2016\021816_Board Meeting_Engineering Report.docx

Loxahatchee River District

Water Reclamation | Environmental Education | River Restoration

2500 Jupiter Park Drive, Jupiter, Florida 33458-8964

Telephone (561) 747-5700 • Fax (561) 747-9929 • www.loxahatcheeriver.org



D. Albrey Arrington, Ph.D., Executive Director

MEMORANDUM

TO: Albrey Arrington, Executive Director

FROM: Tom Vaughn, Director of Operations

DATE: February 5, 2016

SUBJECT: Operations Department Monthly
Report for January 2016

Treatment Plant Division

For the month of January, operations continued its efforts to enhance the skills and knowledge of its employees by providing Florida D.E.P. wastewater exam preparation classes. Twice a month, employees participating in these classes are given real world scenario training as well as wastewater concepts and principles. The classes are primarily geared towards assisting employees in obtaining a higher D.E.P. certification. In the process, the operators are refreshing their existing knowledge. Another facet of our training process is the cross training of employees from traditionally different disciplines. These include operations, maintenance, collections, and reuse. The cross training provides for a more experienced and cohesive workforce and has generated a lot of excitement.



We have had another great month of no Permit exceedances.

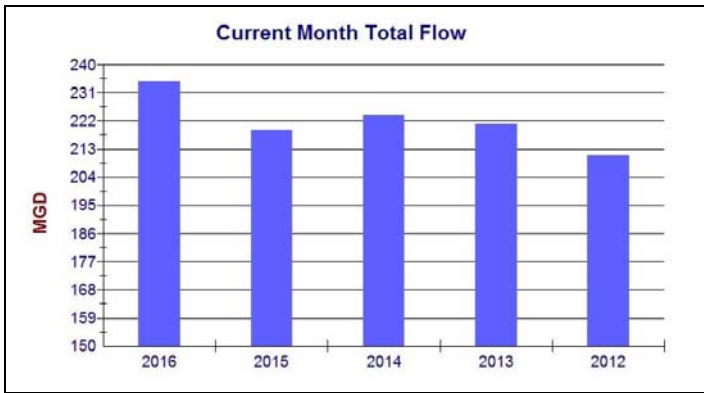

The plant total flow for the month of January was 234.71 million gallons.

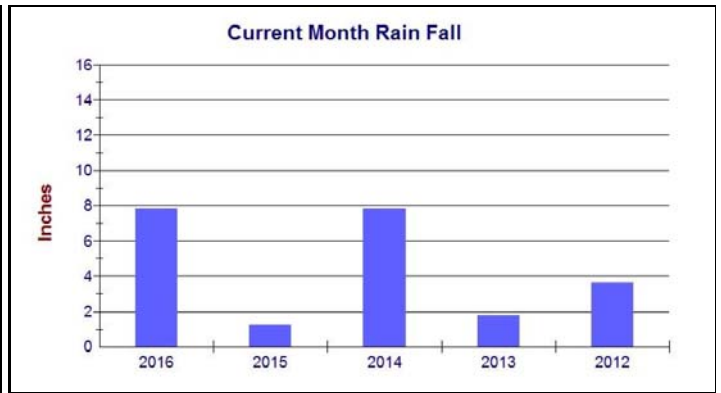

7.85 inches of rainfall were recorded at the plant site during the month of January.

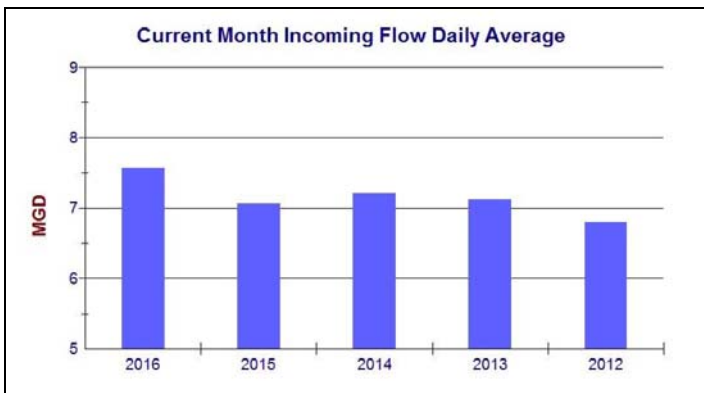

The treatment plant incoming flow for the month of January averaged 7.57 MGD compared to 7.06 MGD one year ago for the same month.

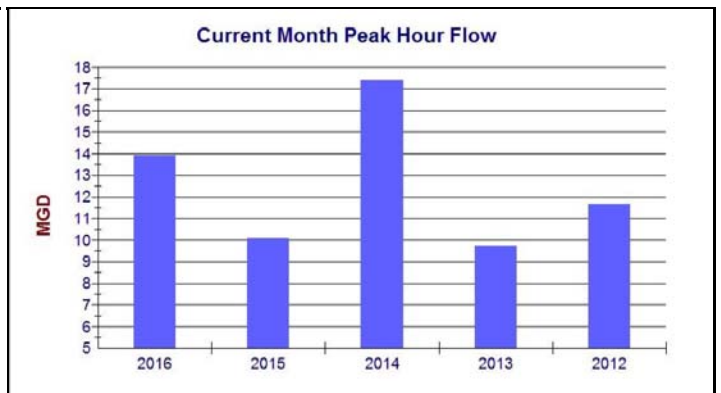

The peak hourly flow rate in January was 13.92 MGD.

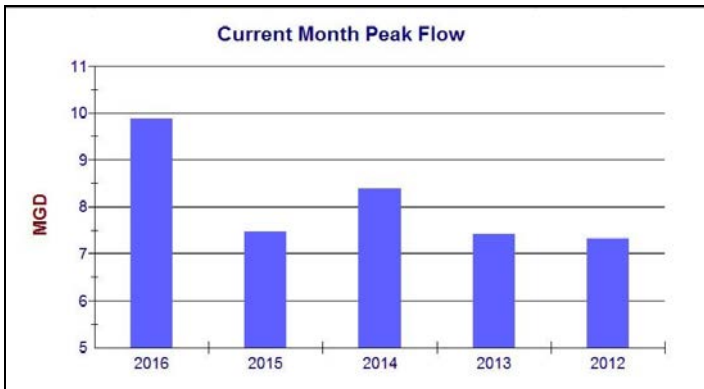

The greatest single day average flow in January was 9.89 MGD.

The plant received 234.71 MG of influent flow of which 60.07 million gallons were sent to the IQ storage system where they were dispersed as needed to the various golf courses and the Abacoa development sites. Due to wet weather conditions and 7.85 inches of rain during the month, 216.17 million gallons of blended effluent was diverted to the Injection Well. Overall, 25.59% of incoming flows was recycled for IQ use and the plant delivered 37.81 million gallons of IQ water to the Reuse customers.

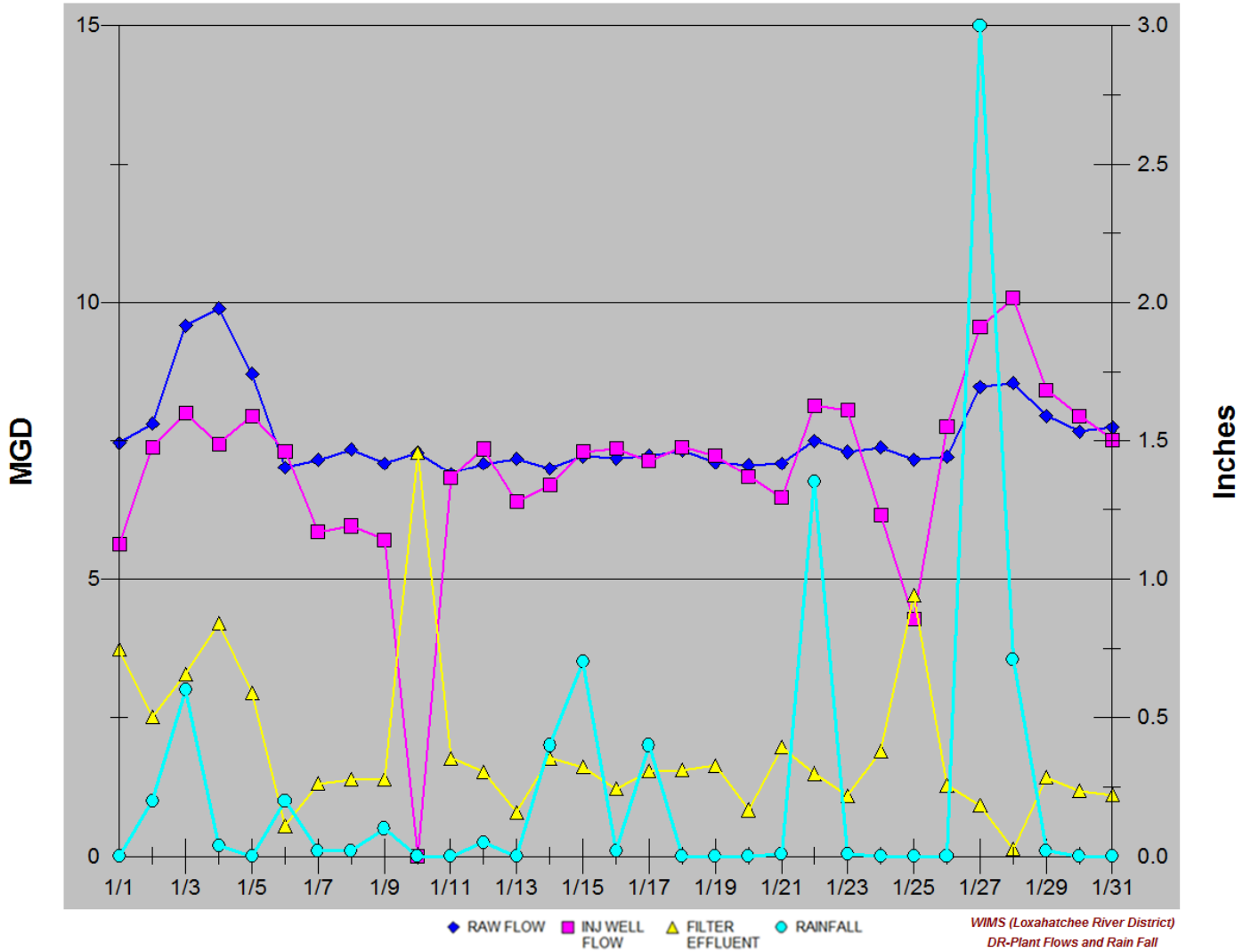

For the year 2016, the plant recycled 25.59% of all incoming flow and the total amount of IQ water delivered to reuse customers stands at 37.81 million gallons.

All required monthly reporting has been submitted on time.

Safety / Compliance

TRAINING. Training for the month of January focused on Permit Required Confined Spaces. Each employee involved in performing an entry into a confined space will have a specific duty. The responsibilities of the Entry Supervisor are to issue a work permit with detailed descriptions of the location, equipment needed and the work to be performed.

The Entrant must make entry into the space and complete the work described on the issued permit. The Attendant must be positioned immediately outside the space and be in constant communication with the entrant to monitor their safety at all times and record atmospheric conditions inside the space. Equipment essential to make a safe entry will include a means of ingress/egress; in most cases a ladder. Fall protection/retrieval system which will aid in the case of a slip and fall or will allow for a “non-entry” rescue of any entrant who may become incapacitated.

Gas detection equipment must also be used to accurately monitor the atmospheric conditions inside the space before and during entry. The levels of oxygen, hydrogen sulfide, carbon monoxide and lower explosive limits (LEL) must be observed on a continuous basis.



Above Picture: Retrieval System Training

D.E.P. The District hosted the DEP certification testing on January 19th and 20th. Two testing sessions were held each day, morning and afternoon. Over one hundred people attended in the hope of advancing their current license or certification status. After having the opportunity to speak with many of the attendees, I must convey the many compliments the District receives regarding our facility, staff and hospitality.

One of the comments was “This place is amazing, are you hiring?”



Active Shooter Training. The Palm Beach County Sheriff's office visited the River Center and Treatment Facility properties during the month of January. Their mission was to educate District employees about the preventative measures, dangers and defensive tactics that may be encountered or used during an "active shooter" scenario. This program was developed by Homeland Security and used by PBSO to demonstrate how broad and rapidly evolving these situations may be.

The foundation of the training is based on three core decisions to either Run, Hide or Fight.

These three tactics were reviewed, for which would be your best response during such a situation, given your location at the time.



The District has no injuries or accidents to report for the month of January.

Collections and Transmissions Division



LEFT. On the District's plant site, the upgrade to the bypass line on the POC (point of connection) for Nano filtration concentrate from the Town of Jupiter water treatment plant was completed. The bypass line has been painted with a fresh coat.

RIGHT. At the District Warehouse a lot happens daily. One of the regular responsibilities is the loading of one of many of the field's submersible pumps. New and rebuilt pumps for field Collection crews go into and out of the warehouse throughout a budget year.



BELOW. At Abacoa Booster station #200, the District Collection crew set up to install the new backflow actuator hardware on the new 20 inch check valve. The project was scheduled and the force main section was isolated and drained so that the installation could be performed. The purpose of the new hardware is to keep the check valve open if reverse flow to the East is needed.

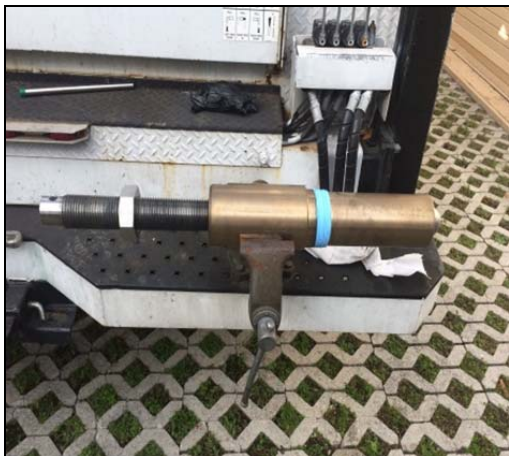

BELOW. On the District's plant site, Reclaimed Master pump station; #511 received new signage. It was installed for information and visitor protection. Students from Jupiter High school work and take care of the new fruit trees near the pump station and storage lake #4.



BELOW. For the reporting month, eight (8) new low pressure systems came online in the Low Pressure Pump Station System.

The District's Vac Con Crew cleaned the following lift stations in January 2016: # 172, 24, 159, 9, 154, 83, 175, 193, 53, 224, 249, 52, 76, and 16.



Maintenance

RIGHT. The annual cleaning and inspection of the bar screen weir have been conducted and completed in January. Maintenance is cross training with the Operations team to familiarize all personnel with the on-site equipment.



LEFT. The elbow of the Vac Con was removed because it was worn through and unusable. Maintenance crew members were able to remove the worn section of piping and install a new plate, which extended the useful life of this equipment. The new plate was installed and received an outer plate that was mounted and painted.



Tidbits from Tom

January, 2016 – Happy New Year



“If you want something you’ve never had – you have to do something you’ve never done.”

Three New Year’s resolutions for employees in 2016!

1. The first resolution is to speak up inside of your organization. Many times when employees are frustrated and unhappy with something they tend to keep it to themselves. Tell your supervisor.
2. Resolution number two is to think like an entrepreneur, but inside your company as an “intrapreneur.”
3. The third resolution is to take charge of your own education and talent development. We cannot rely on educational institutions or on our organizations to give all of the necessary educational content that is needed to develop professionally and personally.

All three resolutions will help to make 2016 your best year of work yet!

Perspective:

“Don’t worry about failure. Worry about the chances you miss when you don’t even try.” – Sherman Finesilver

See ya’ at the Top – (That’s near Cheese Station “N”)

**Tom Vaughn
Director of Operations**

Loxahatchee River District

Water Reclamation | Environmental Education | River Restoration

2500 Jupiter Park Drive, Jupiter, Florida 33458

Telephone (561) 747-5700 • Fax (561) 747-9929 • www.loxahatcheeriver.org



D. Albrey Arrington, Ph.D., Executive Director

MEMORANDUM

TO: Albrey Arrington, Ph.D., Executive Director
FROM: Bud Howard, Director of Information Services
DATE: February 11, 2016
SUBJECT: Monthly Governing Board Update

WildPine Ecological Laboratory



New Laboratory Intern

Anthony Matusik is our new intern for the spring semester. Anthony has a background in biology and recently received his Master's degree from Florida International University in Environmental Studies. Anthony served as a Peace Corps Volunteer for two years in Panama working on Environmental Conservation. During that time he also collaborated with Panamanian agencies in designing a management plan for an internationally protected wetland as part of his thesis research. At left, Anthony is filtering wastewater to be analyzed as part of an evaluation comparing our existing filters with our new deep bed filters.

Riverkeeper Project

In January, LRD and Town of Jupiter staff sampled 52 water quality monitoring water sites. Nutrient concentrations were elevated overall, largely as a result of increased flows from the unusually heavy rains. Total nitrogen in the watershed exceeded DEP/EPA's Numeric Nutrient Criteria (NNC; 1.54 mg/L) at six sites. Jupiter High School's canal had the highest nitrogen at 2.6 mg/L. Total phosphorus in the watershed exceeded the NNC at ten sites. Two sites in particular were over 3 times higher than the NNC (0.12 mg/L) for freshwater canals: Indian Creek Parkway at Sims Canal and Jupiter High School's canal. Bacteria levels throughout the watershed were also elevated due to the amount of stormwater entering the system. Fourteen sites scored "poor" for fecal coliform and/or enterococci bacteria; these sites were located in the River's Edge and Southwest Fork drainage basins. Thankfully, the bacteria counts in the canal behind Jupiter High School has improved, which had counts over 50,000 cfu/100mL in December and January. Results from sampling this and last week were below 200 cfu/100 mL.

Stephen B. Rockoff
Board Member

Dr. Matt H. Rostock
Board Member

Gordon M. Boggie
Chairman

Harvey M. Silverman
Board Member

James D. Snyder
Board Member

Stormwater Improvements



The culvert pipe that was the sampling station 88 (left) at Sonoma Isles (previously Parcel 19), and the newly completed water control structure (right). This station drained the former agriculture site with high Phosphorus loads. The new drainage feature is connected to a wetland treatment area and will only discharge during extreme rain events. This should improve water quality at this site.

Hydrologic and Datasonde Monitoring

As predicted with the strong El Niño, 2016 is getting off to a wet start with the wettest January on record according to the SFWMD. Total rainfall for January, measured at LRD, was 7.9” with a single daily total of 3.0” occurring on January 27. This is more than twice the historical monthly total of 3.2” (see figure.)

The rainfall during January resulted in substantially increased flow through the water control structures. Lainhart Dam had a mean daily flow of 160 cfs with a maximum flow of 273 cfs occurring on January 28. The S-46 flood control structure discharged for 17 days – highly unusual for January. Five days had a daily average flow of over 300 cfs, with a maximum of 723 cfs occurring on January 28. The majority of increased flows occurred toward the end of the month as a result of the 3” rain event.

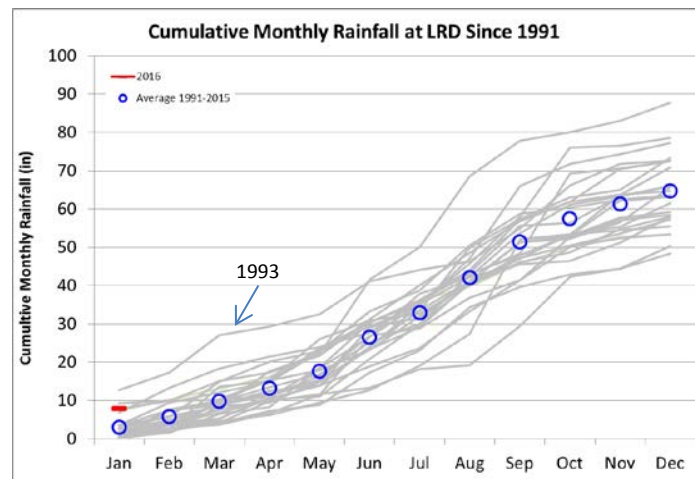

The Inlet and site 72 at Loxahatchee River Road in the SW Fork, experienced salinities as low as 6.5 and 0.9 ppt, respectively. The monthly average salinities at those sites were very unusual (more than 2 standard deviations below the historical mean). The lowest salinities of the month at the Inlet and 72 were recorded between 5:15-7:15am on Jan 28th (unsurprisingly just after low tide). However, at 8:43am flow through S-46 began a dramatic increase that topped out at 1,200 cfs (32M gal/hr) at 9:07am. Despite this massive surge from S-46, the incoming tide was still able to steadily increase salinities at Inlet and 72.

Oyster Recruitment Monitoring

Oyster settlement monitoring confirmed that oyster spawning has ended for the winter season. As we have observed previously, daily average water temperatures were between 24.1°C and 24.4°C and correspond with minimal to no oyster settlement activity. Following our assessment and recent publication on alternative oyster monitoring media, December monitoring marks the last time we will use oyster shells for quantifying oyster settlement. Starting 2016, we will use the square, non-glazed travertine tiles for a reusable, consistent size/shape monitoring media.

Volunteer Water Quality Monitoring

The volunteer water quality grade for December was dropped to a “B”. The abundance of freshwater into the system lowered the pH and water clarity values into the “poor” to “fair” ranges.

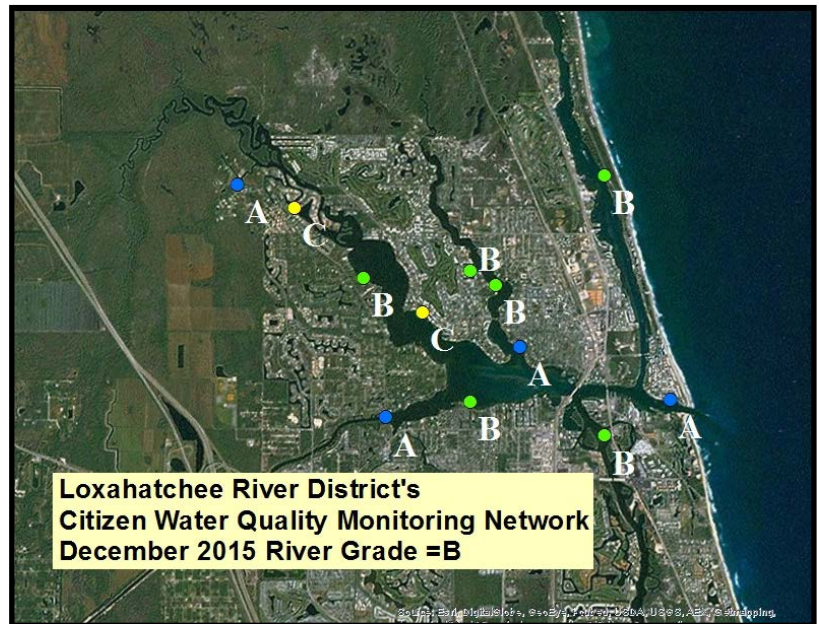

Information Technology

New Server Migration & Folder Organization

Staff have completed the migration and reorganization of files and folder structure on our new server. Despite the extensive integration of systems, the IT team completed the migration and reorganization of more than 1.6M files and folders with no major upsets.

Ransom Virus

Thanks to quick assessment, thinking and action, Joe successfully stopped and quickly recovered from a ransom virus. This event provided a valuable lesson to all staff to be extra vigilant and realize that we, District employees, are the biggest IT security vulnerability.

Customer Service

Payment Processing

In January, we sent out the 1st Quarter Billing and processed the onslaught of payments from our quick paying customers. Staff processed nearly 13,500 payments totaling nearly \$2M. More than 40% of those were electronic payments and processed very efficiently with our digital payments tool. Payment processing workload will remain heavy until bills are due on February 19. Staff have also been contributing to the ideas for policy and procedure improvements for the Board's consideration.

Loxahatchee River District

Water Reclamation | Environmental Education | River Restoration

2500 Jupiter Park Drive, Jupiter, Florida 33458

Telephone (561) 747-5700 • Fax (561) 747-9929 • www.loxahatcheeriver.org



D. Albrey Arrington, Ph.D., Executive Director

MEMORANDUM

TO: Governing Board
FROM: Administration Staff
DATE: February 8, 2016
SUBJECT: Consultant Payments

The following amounts have been reviewed, and approved for payment to our consultants for work performed during the prior month.

	<u>Prior Month</u>	<u>Fiscal YTD</u>
DeSantis, Gaskill, Smith & Shenkman	\$25,716.02	\$53,857.50
Arcadis	\$2,240.00	\$5,802.50
Hazen	\$7,864.00	\$45,131.85
Holtz	\$5,277.00	\$25,266.70
Mathews	\$41,999.00	\$123,430.42

Should you have any questions in regard to these items, please contact Kara Peterson concerning the attorney's invoice, and Clint Yerkes concerning the engineers' invoice.

L:/data/admin/board/consult.doc

Stephen B. Rockoff
Board Member

Dr. Matt H. Rostock
Board Member

Gordon M. Boggie
Chairman

Harvey M. Silverman
Board Member

James D. Snyder
Board Member



Future Business

Neighborhood Sewering:

- Hibiscus Ave. Gravity sewers
- Jupiter Inlet Colony pre construction meetings

Other:

- Jupiter Plantation Force Main Rehab
- Maplewood Drive Force Main Contract
- Health Insurance
- PBC Interlocal-Non Ad Valorem tax collection
- Chlorine Contract